



**RIMOR**

**Catalogue 2024-2025**



# RIMOR

# World sweet home

## **The world is your new address**

Let new discoveries and adventures get your imagination started. With Rimor, the whole world is now your home. We have been building motorhomes and vans for over 45 years, taking inspiration from the place closest to us to make sure you're as comfortable as possible. Functional and welcoming, spacious and comfortable, vehicles that are a true expression of design and all-Italian production.

Rediscover freedom of movement at the seaside and in the mountains, in the city and the countryside. With Rimor motorhomes and vans you'll feel at home, wherever you choose to go.

# Your compass

## Find the Rimor that suits you best with our handy map

How to find the vehicle that best reflects your idea of outdoor life and turn it into reality? Get help with this handy map. You can choose the Rimor range that best meets your needs, quickly comparing the number of beds available, the number of homologated seats, the total length of the vehicle and the engine.

### Kilig

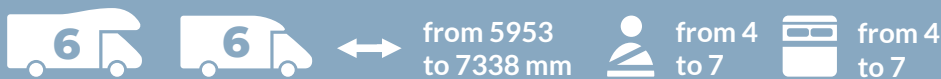

### Sarus **NEW**

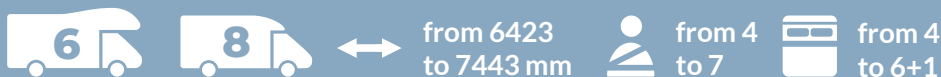

### Super Brig



### Horus

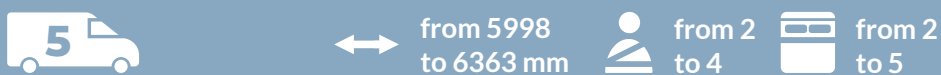

#### Legend

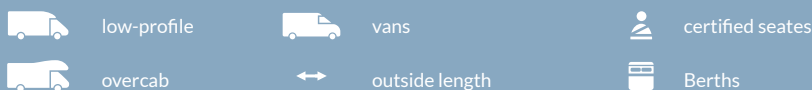

 **KILIG**



**»» 08**

 **SARUS**



**»» 42**

 **SUPER BRIG**



**»» 82**

 **HORUS**



**»» 108**



# Guided by experience

## Comfort and functionality for all our models

Numerous ranges, loads more models, but many common features, starting with reliability and functionality, the result of construction techniques tested over time. Our choice of the best solutions to guarantee you maximum comfort is guided by our experience, all under the banner of Italian craftsmanship.



- **Motorhome living areas** designed **without a single step**
- **High-comfort motorhome tables that can be moved in all directions**
- **Removable van smart table with extension** which can be used as an outdoor table
- **220/230 V outlets** in both the kitchen and the bathroom
- New lids for hob with **safety flameproof** closure
- **New sliding blind with integrated fly-screen**
- **100% LED lighting**
- **Solid shower door** as standard
- **Spacious beds**, up to 220 cm long, with wooden slatted bases
- **High-density comfort mattresses** with removable covers which are anatomical and hypo-allergenic
- **Overcab bed with pneumatic slatted base**
- **Easyroad motorhome dinette in the face-to-face models** (each of the two bench seats can be quickly transformed into comfortable travel seats)
- Interior side cladding of motorhomes in **durable, easy to clean Elyplan fibreglass**
- **Easy access cell entrance with internal step**
- **10mA residual current circuit breaker**
- **Isofix attachment points** (optional) available on all models



# Admire your new love

## If your heart starts beating faster, that's camper life

Kilig is a big emotion... or a small and precious one, just like the range of models designed for the different approaches to life en plein air. You will find solutions in less than 6 metres, such as Kilig 4 and 18 Plus, for maximum manoeuvrability and convenience when travelling by ferry, motorway and in parking places.

Or choose the spacious comfort of the new Kilig 77 with double dinette and double drop-down bed, Kilig 50 with two bunk beds and family-size dinette, Kilig 67 Plus without fixed bed with XL front drop-down bed and walk-in wardrobe, and Kilig 66 Plus with central bed and face-to-face dinette.

Then there are all the elegant and smart solutions.

The new interior details in matt black are the modern finish you are looking for as well as a greater interior height, perfect for taller people. Also, the multi-purpose kitchen panel brings practicality back into fashion, as does the detachable tubular garage lamp that can become a practical inspection light.





## Kilig

Engine  
Ford Transit

Displacement  
2,0L



from 5953  
to 7308 mm



from  
4 to 7



from  
5 to 6+1



from 5953  
to 7338 mm



from  
4 to 5



from  
4 to 7



**By your side at  
special moments**

**NEW**



- 1 **New interior fittings in matt black** (adjustable spotlights, switches and outlets)
- 2 **Multi-purpose magnetic kitchen panel**

- 3 **Slim 141 L fridge** on all models

NEW



4 New exclusive layout with double dinette and double dropdown bed (Kilig 77 Plus)



**5 Entrance door with storage pockets** (optional window)



**6 Openable skyview** (optional)



**7 Detachable tubular garage lamp** that becomes a practical inspection light

- Combi Gas heating with standard supply CP Plus digital control unit
- Kitchen sink with lid and folding mixer tap
- Panoramic windows with practical sliding opening handle (standard throughout the whole range)
- Additional bed kit dinette with ergonomic, easily adaptable cushions (optional)
- Interior height in living areas underneath the drop-down bed 185 cm
- On the profiled models, the driver's cabin is incorporated in the living area, with the fairing upholstered in soft touch fabric
- Semi-dinette table with sliding system: more leg room both when driving and when parked





front/rear facing dinette

## Living area



**Compact dinette**

KILIG 4

**Front/rear facing dinette**

KILIG 5

**L-shape dinette**

KILIG 669

KILIG 695

**Double dinette**

KILIG 9

**Double dinette island**

KILIG 50



compact dinette



double dinette



double dinette island



L-shaped dinette

## Living area



### L-shaped dinette

KILIG 18 PLUS  
KILIG 69 PLUS  
KILIG 95 PLUS

### Face-to-face dinette

KILIG 66 PLUS  
KILIG 67 PLUS

Front + rear dinette  
KILIG 77 PLUS



face-to-face dinette



**NEW**



**front + rear dinette**



Queres Bett

## Sleeping area



### Transverse bed

KILIG 4  
KILIG 5

### Bunk beds

KILIG 9

### Double bunk beds

KILIG 50

### Central bed

KILIG 669

### Twin beds

KILIG 695



bunk bed





twin beds



double bunk beds

## Sleeping area



**Transverse bed**  
KILIG 18 PLUS

**Central bed**  
KILIG 66 PLUS  
KILIG 69 PLUS

**XL Front drop-down bed**  
KILIG 67 PLUS

**Double drop-down beds**  
KILIG 77 PLUS

**Twin beds**  
KILIG 95 PLUS

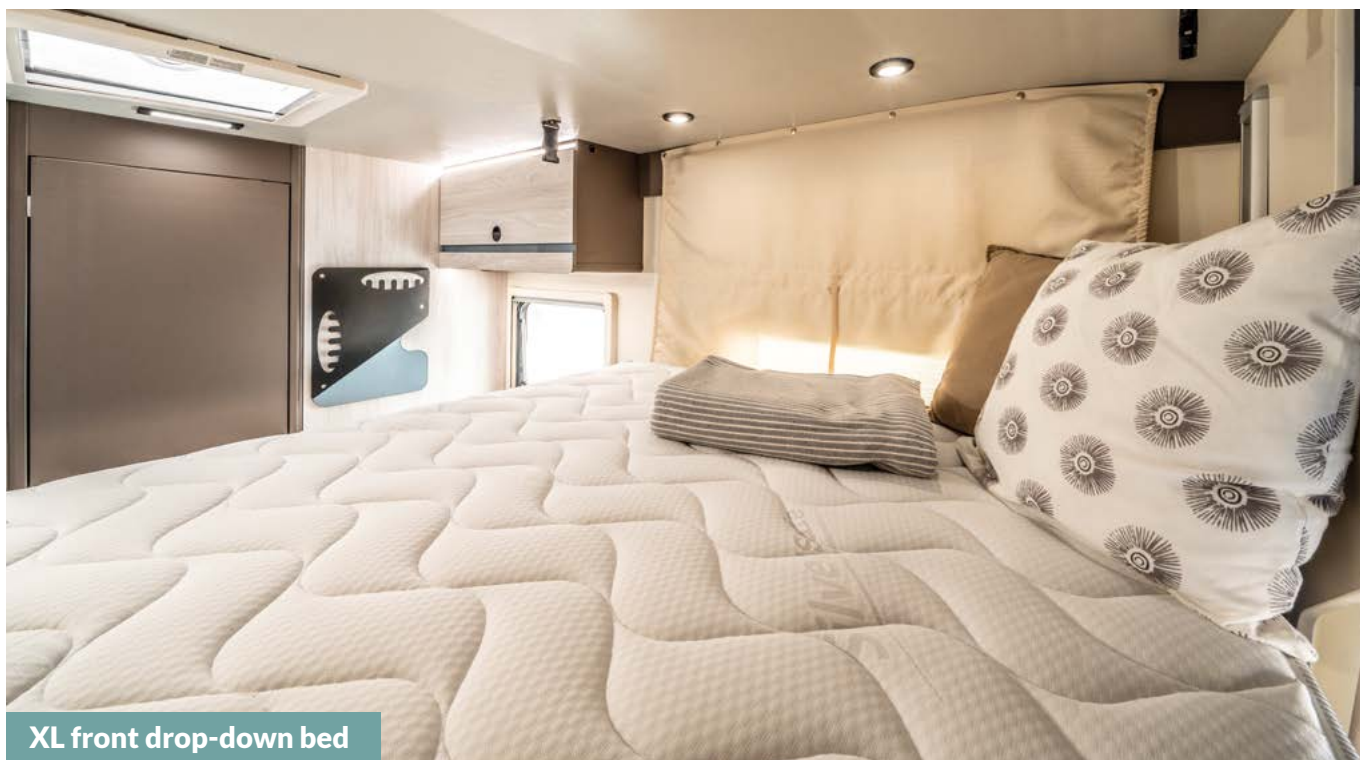

**NEW**



**double drop-down bed**



## Kitchen



### Compact kitchen

KILIG 669  
KILIG 695

### Long kitchen

KILIG 4  
KILIG 5  
KILIG 9  
KILIG 50



### Compact kitchen

KILIG 66 PLUS  
KILIG 67 PLUS  
KILIG 95 PLUS

### Long kitchen

KILIG 18 PLUS  
KILIG 77 PLUS

compact kitchen





long kitchen

## Bathroom



**Single unit with shower alongside toilet**

KILIG 4  
KILIG 5  
KILIG 9

**Separate toilet and shower cubicle**

KILIG 669  
KILIG 695

**Toilet and shower cubicle integrated | Compact**

KILIG 50



**Single unit with shower alongside toilet**

KILIG 18 PLUS  
KILIG 77 PLUS

**Separate toilet and shower cubicle**

KILIG 66 PLUS  
KILIG 69 PLUS  
KILIG 95 PLUS

**Full-width with closet**

KILIG 67 PLUS



Toilet and shower cubicle integrated | Compact

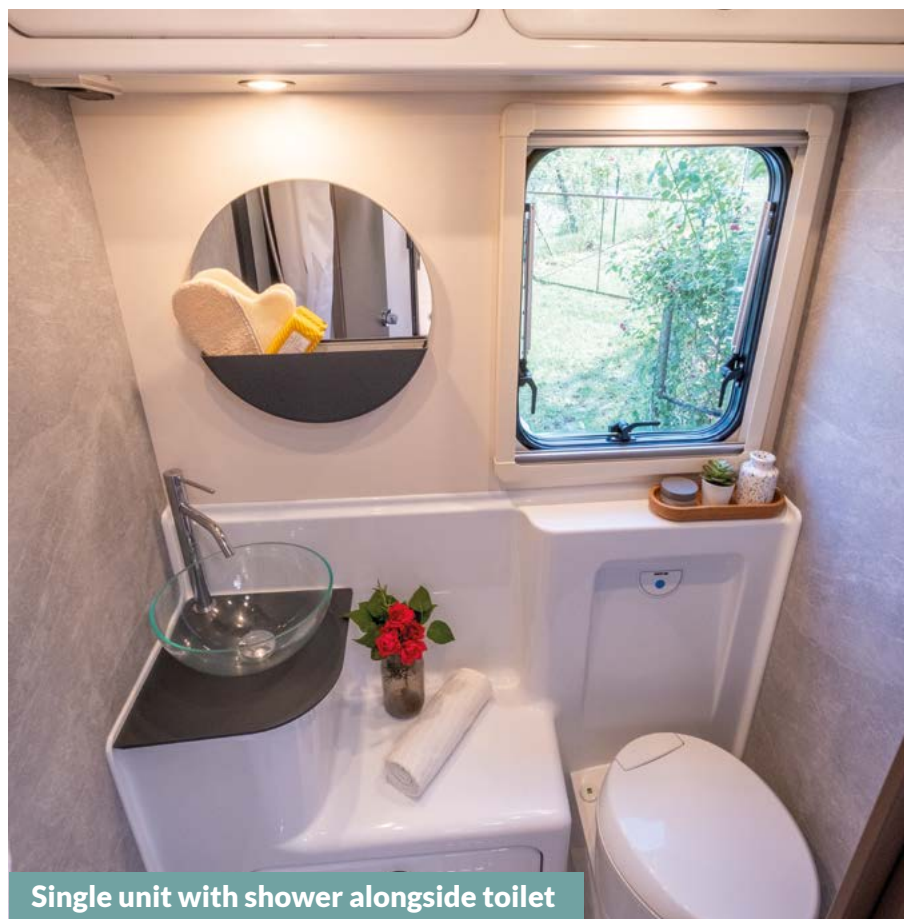

Single unit with shower alongside toilet





Separate toilet and shower cubicle



Full-width with closet



# Models and layouts

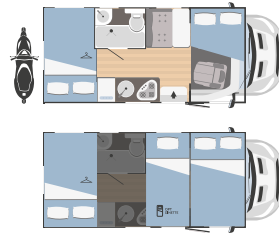

|                                                      | KILIG 4   | KILIG 5                    |
|------------------------------------------------------|-----------|----------------------------|
| ↔ Outside length x width (mm)                        | 5953x2340 | 6970x2340                  |
| 👤 Certified seats                                    | 4         | 6                          |
| 🛏 Berths                                             | 5 (1 opt) | 6 (2 opt)                  |
| 🚪 Garage (access door dimensions)<br>H (mm) x W (mm) | 1000x650  | 1280x850<br>(1080x850 opt) |

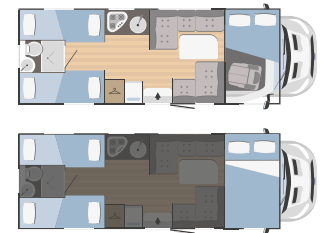
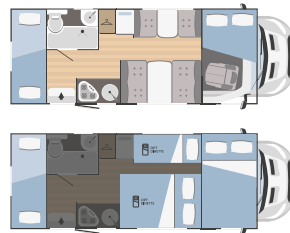

|                                                      | KILIG 9       | KILIG 50                     |
|------------------------------------------------------|---------------|------------------------------|
| ↔ Outside length x width (mm)                        | 6970x2340     | 7285x2340                    |
| 👤 Certified seats                                    | 7             | 6                            |
| 🛏 Berths                                             | 6+1 (2+1 opt) | 6                            |
| 🚪 Garage (access door dimensions)<br>H (mm) x W (mm) | 1150x650      | n.1 950x1350<br>n.1 950x1150 |

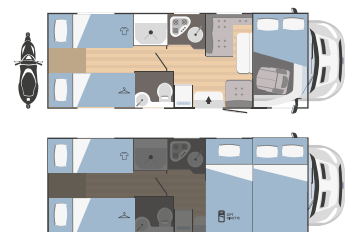
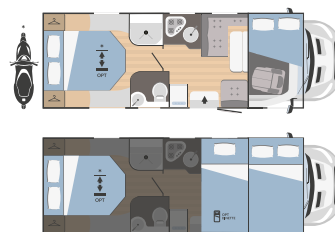

|                                                      | KILIG 669                 | KILIG 695 |
|------------------------------------------------------|---------------------------|-----------|
| ↔ Outside length x width (mm)                        | 7308x2340                 | 7308x2340 |
| 👤 Certified seats                                    | 5                         | 5         |
| 🛏 Berths                                             | 5 (1 opt)                 | 5 (1 opt) |
| 🚪 Garage (access door dimensions)<br>H (mm) x W (mm) | 750x850<br>(1150x850 opt) | 1050x850  |

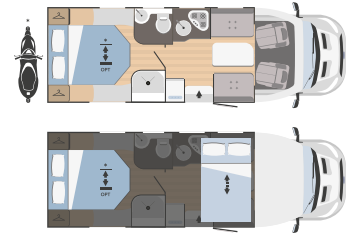
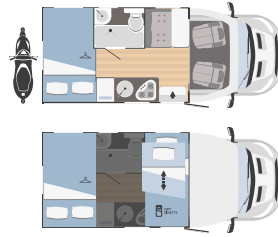

|                                                      | KILIG 18 PLUS | KILIG 66 PLUS             |
|------------------------------------------------------|---------------|---------------------------|
| ↔ Outside length x width (mm)                        | 5953x2340     | 7338x2340                 |
| 👤 Certified seats                                    | 4             | 4                         |
| 🛏 Berths                                             | 4 (1 opt)     | 4                         |
| 🚪 Garage (access door dimensions)<br>H (mm) x W (mm) | 1000x650      | 750x850<br>(1150x850 opt) |

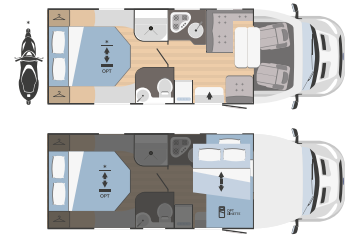
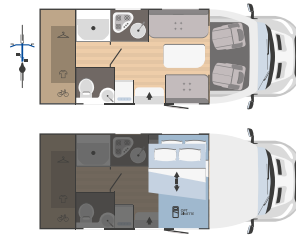

|                                                      | KILIG 67 PLUS | KILIG 69 PLUS             |
|------------------------------------------------------|---------------|---------------------------|
| ↔ Outside length x width (mm)                        | 6449x2340     | 7308x2340                 |
| 👤 Certified seats                                    | 4             | 5                         |
| 🛏 Berths                                             | 4 (2 opt)     | 5 (1 opt)                 |
| 🚪 Garage (access door dimensions)<br>H (mm) x W (mm) | 1050x630      | 750x850<br>(1150x850 opt) |

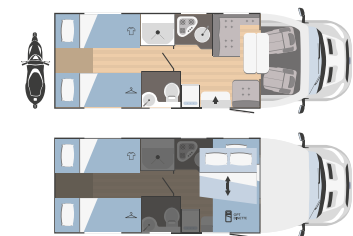
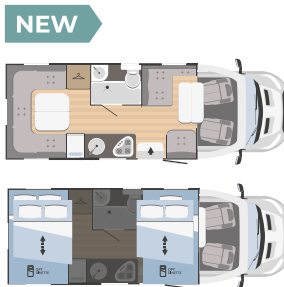

|                                                      | KILIG 77 PLUS | KILIG 95 PLUS |
|------------------------------------------------------|---------------|---------------|
| ↔ Outside length x width (mm)                        | 6970x2340     | 7308x2340     |
| 👤 Certified seats                                    | 5             | 5             |
| 🛏 Berths                                             | 7 (3 opt)     | 5             |
| 🚪 Garage (access door dimensions)<br>H (mm) x W (mm) | 550x700       | 1050x850      |



# KILIG 4



↔  
**5953x2340**

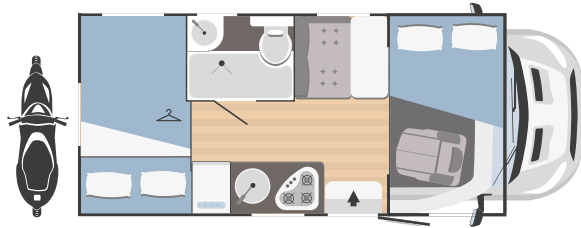

**4**



**5**

(1 opt)



**1000x650**

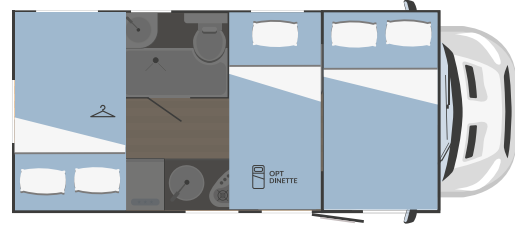

## MECHANICAL UNIT

|                       |              |
|-----------------------|--------------|
| Engine                | Ford Transit |
| Wheelbase (mm)        | 3300         |
| Displacement (L)      | 2,0          |
| Maximum power (kW-HP) | 96 - 130*    |
| Radio                 | ✓            |

## DIMENSIONS AND WEIGHTS

|                                             |              |
|---------------------------------------------|--------------|
| Outside length (mm)                         | 5953         |
| Outside width - inside width (mm)           | 2340 - 2200  |
| Maximum outside height - inside height (mm) | 3040 - 2060  |
| Thickness of floor - walls - roof (mm)      | 56 - 30 - 30 |
| Certified seats                             | 4            |
| Maximum overall weight (kg)***              | 3500         |

## BEDS

|                                                |           |
|------------------------------------------------|-----------|
| Berths                                         | 4         |
| Optional berths                                | 1         |
| Overcab double bed                             | 1400x2200 |
| Assemblable single bed centre dinette optional | 1050x2200 |
| Assemblable double bed centre dinette optional | -         |
| Assemblable double bed rear dinette optional   | -         |
| Rear single bed                                | -         |
| Rear double bed                                | 1230x2200 |
| Bunk bed                                       | -         |
| Rear drop-down double bed                      | -         |

## TANKS

|                            |                  |
|----------------------------|------------------|
| Drinking water (inside)*** | 20 + 65 l.       |
| Waste water tank           | 73 l.            |
| Antifreeze tank            | on request       |
| Gas bottle locker          | (1+1) x 11:13 kg |

## EQUIPMENT

|                                                          |            |
|----------------------------------------------------------|------------|
| Gas heater                                               | Combi C4   |
| Water heater                                             | Combi C4   |
| Cabin swivel seats                                       | ✓          |
| Panoramic porthole living area                           | -          |
| Openable panoramic porthole low-profile models front pod | -          |
| Fridge                                                   | 141 l.     |
| Nr. burners hob                                          | 3          |
| Extractor hood                                           | on request |
| Oven                                                     | on request |
| Garage (access door dimensions) H (mm) x W (mm)          | 1000x650   |
| Driver's cabin blackout blind                            | on request |
| Entrance door with fly screen                            | on request |
| TV-holder                                                | on request |
| Roof rack with ladder                                    | on request |
| Service battery                                          | on request |
| Cabin seat covers                                        | on request |
| Parking feet                                             | on request |
| Bicycle rack                                             | on request |
| Alarm system                                             | on request |
| Outside entrance door lamp                               | on request |

\*the Ford Transit 121kW - 165 CV engine is available on request

\*\*\*for legal information about the weights see page 133

# KILIG 5



↔  
**6970x2340**

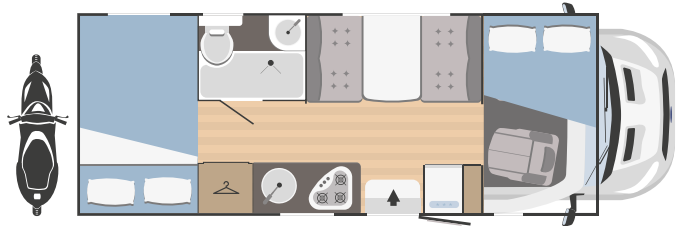

**6**



**6**  
(2 opt)



**1280x850**  
(1080x850 opt)

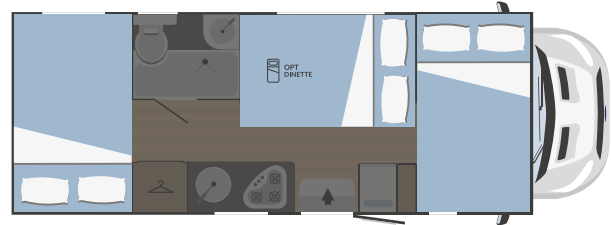

## MECHANICAL UNIT

|                       |              |
|-----------------------|--------------|
| Engine                | Ford Transit |
| Wheelbase (mm)        | 3750         |
| Displacement (L)      | 2,0          |
| Maximum power (kW-HP) | 96 - 130*    |
| Radio                 | ✓            |

## DIMENSIONS AND WEIGHTS

|                                             |              |
|---------------------------------------------|--------------|
| Outside length (mm)                         | 6970         |
| Outside width - inside width (mm)           | 2340 - 2200  |
| Maximum outside height - inside height (mm) | 3040 - 2060  |
| Thickness of floor - walls - roof (mm)      | 56 - 30 - 30 |
| Certified seats                             | 6            |
| Maximum overall weight (kg)***              | 3500         |

## BEDS

|                                                |            |
|------------------------------------------------|------------|
| Berths                                         | 4          |
| Optional berths                                | 2          |
| Overcab double bed                             | 1400x2200  |
| Assemblable single bed centre dinette optional | -          |
| Assemblable double bed centre dinette optional | 1290x1890  |
| Assemblable double bed rear dinette optional   | -          |
| Rear single bed                                | -          |
| Rear double bed                                | 1300x2200  |
| Bunk bed                                       | -          |
| Rear drop-down double bed                      | on request |

## TANKS

|                            |                  |
|----------------------------|------------------|
| Drinking water (inside)*** | 20 + 65 l.       |
| Waste water tank           | 120 l.           |
| Antifreeze tank            | on request       |
| Gas bottle locker          | (1+1) x 11:13 kg |

## EQUIPMENT

|                                                          |                                |
|----------------------------------------------------------|--------------------------------|
| Gas heater                                               | Combi C4                       |
| Water heater                                             | Combi C4                       |
| Cabin swivel seats                                       | ✓                              |
| Panoramic porthole living area                           | on request                     |
| Openable panoramic porthole low-profile models front pod | -                              |
| Fridge                                                   | 141 l.                         |
| Nr. burners hob                                          | 3                              |
| Extractor hood                                           | on request                     |
| Oven                                                     | on request                     |
| Garage (access door dimensions) H (mm) x W (mm)          | 1280x850 (1080x850 on request) |
| Driver's cabin blackout blind                            | on request                     |
| Entrance door with fly screen                            | on request                     |
| TV-holder                                                | on request                     |
| Roof rack with ladder                                    | on request                     |
| Service battery                                          | on request                     |
| Cabin seat covers                                        | on request                     |
| Parking feet                                             | on request                     |
| Bicycle rack                                             | on request                     |
| Alarm system                                             | on request                     |
| Outside entrance door lamp                               | on request                     |

\*the Ford Transit 121kW - 165 CV engine is available on request

\*\*\*for legal information about the weights see page 133

# KILIG 9



↔  
**6970x2340**



**7**



**6+1**  
(2+1 opt)



**1150x650**

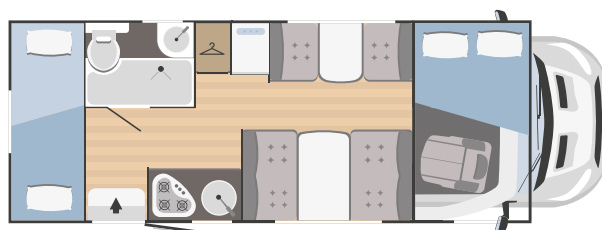

## MECHANICAL UNIT

|                       |              |
|-----------------------|--------------|
| Engine                | Ford Transit |
| Wheelbase (mm)        | 3750         |
| Displacement (L)      | 2,0          |
| Maximum power (kW-HP) | 96 - 130*    |
| Radio                 | ✓            |

## DIMENSIONS AND WEIGHTS

|                                             |              |
|---------------------------------------------|--------------|
| Outside length (mm)                         | 6970         |
| Outside width - inside width (mm)           | 2340 - 2200  |
| Maximum outside height - inside height (mm) | 3040 - 2060  |
| Thickness of floor - walls - roof (mm)      | 56 - 30 - 30 |
| Certified seats                             | 7            |
| Maximum overall weight (kg)***              | 3500         |

## BEDS

|                                                |           |
|------------------------------------------------|-----------|
| Berths                                         | 4         |
| Optional berths                                | 2+1       |
| Overcab double bed                             | 1400x2200 |
| Assemblable single bed centre dinette optional | 680x1600  |
| Assemblable double bed centre dinette optional | 1290x1890 |
| Assemblable double bed rear dinette optional   | -         |
| Rear single bed                                | -         |
| Rear double bed                                | -         |
| Bunk bed                                       | 800x2200  |
| Rear drop-down double bed                      | -         |

## TANKS

|                            |                  |
|----------------------------|------------------|
| Drinking water (inside)*** | 20 + 65 l.       |
| Waste water tank           | 120 l.           |
| Antifreeze tank            | on request       |
| Gas bottle locker          | (1+1) x 11:13 kg |

## EQUIPMENT

|                                                          |            |
|----------------------------------------------------------|------------|
| Gas heater                                               | Combi C4   |
| Water heater                                             | Combi C4   |
| Cabin swivel seats                                       | ✓          |
| Panoramic porthole living area                           | on request |
| Openable panoramic porthole low-profile models front pod | -          |
| Fridge                                                   | 141 l.     |
| Nr. burners hob                                          | 3          |
| Extractor hood                                           | on request |
| Oven                                                     | on request |
| Garage (access door dimensions) H (mm) x W (mm)          | 1150x650   |
| Driver's cabin blackout blind                            | on request |
| Entrance door with fly screen                            | on request |
| TV-holder                                                | on request |
| Roof rack with ladder                                    | on request |
| Service battery                                          | on request |
| Cabin seat covers                                        | on request |
| Parking feet                                             | on request |
| Bicycle rack                                             | on request |
| Alarm system                                             | on request |
| Outside entrance door lamp                               | on request |

\*the Ford Transit 121kW - 165 CV engine is available on request

\*\*\*for legal information about the weights see page 133

# KILIG 50



7285x2340



6



6



n.1 950x1350

n.1 950x1150

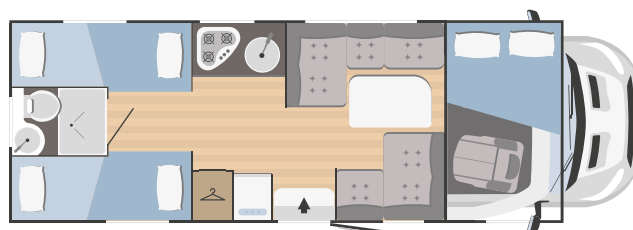

## MECHANICAL UNIT

|                       |              |
|-----------------------|--------------|
| Engine                | Ford Transit |
| Wheelbase (mm)        | 3954         |
| Displacement (L)      | 2,0          |
| Maximum power (kW-HP) | 96 - 130*    |
| Radio                 | ✓            |

## DIMENSIONS AND WEIGHTS

|                                             |              |
|---------------------------------------------|--------------|
| Outside length (mm)                         | 7285         |
| Outside width - inside width (mm)           | 2340 - 2200  |
| Maximum outside height - inside height (mm) | 3040 - 2060  |
| Thickness of floor - walls - roof (mm)      | 56 - 30 - 30 |
| Certified seats                             | 6            |
| Maximum overall weight (kg)***              | 3500         |

## BEDS

|                                                |              |
|------------------------------------------------|--------------|
| Berths                                         | 6            |
| Optional berths                                | -            |
| Overcab double bed                             | 1400x2200    |
| Assemblable single bed centre dinette optional | -            |
| Assemblable double bed centre dinette optional | -            |
| Assemblable double bed rear dinette optional   | -            |
| Rear single bed                                | -            |
| Rear double bed                                | -            |
| Bunk bed                                       | n.2 780x2000 |
| Rear drop-down double bed                      | -            |

## TANKS

|                            |                  |
|----------------------------|------------------|
| Drinking water (inside)*** | 20 + 65 l.       |
| Waste water tank           | 120 l.           |
| Antifreeze tank            | on request       |
| Gas bottle locker          | (1+1) x 11:13 kg |

## EQUIPMENT

|                                                          |                                |
|----------------------------------------------------------|--------------------------------|
| Gas heater                                               | Combi C4                       |
| Water heater                                             | Combi C4                       |
| Cabin swivel seats                                       | ✓                              |
| Panoramic porthole living area                           | on request                     |
| Openable panoramic porthole low-profile models front pod | -                              |
| Fridge                                                   | 141 l.                         |
| Nr. burners hob                                          | 3                              |
| Extractor hood                                           | on request                     |
| Oven                                                     | on request                     |
| Garage (access door dimensions) H (mm) x W (mm)          | n. 1 950x1350<br>n. 1 950x1150 |
| Driver's cabin blackout blind                            | on request                     |
| Entrance door with fly screen                            | on request                     |
| TV-holder                                                | on request                     |
| Roof rack with ladder                                    | on request                     |
| Service battery                                          | on request                     |
| Cabin seat covers                                        | on request                     |
| Parking feet                                             | on request                     |
| Bicycle rack                                             | on request                     |
| Alarm system                                             | on request                     |
| Outside entrance door lamp                               | on request                     |

\*the Ford Transit 121kW - 165 CV engine is available on request

\*\*\*for legal information about the weights see page 133



# KILIG 669



↔  
**7308x2340**

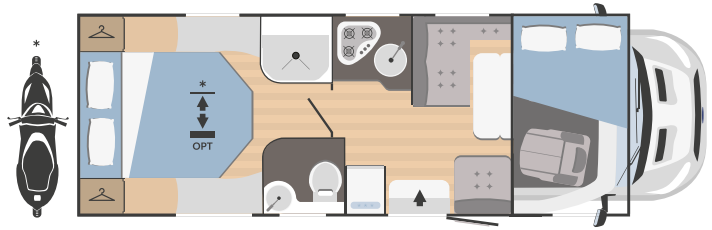

**5**



**5**  
(1 opt)



**750x850**  
(1150x850 opt)

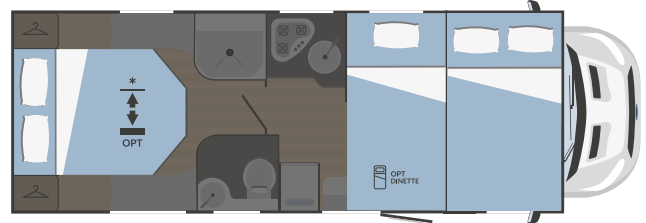

## MECHANICAL UNIT

|                       |              |
|-----------------------|--------------|
| Engine                | Ford Transit |
| Wheelbase (mm)        | 3954         |
| Displacement (L)      | 2,0          |
| Maximum power (kW-HP) | 96 - 130*    |
| Radio                 | ✓            |

## DIMENSIONS AND WEIGHTS

|                                             |              |
|---------------------------------------------|--------------|
| Outside length (mm)                         | 7308         |
| Outside width - inside width (mm)           | 2340 - 2200  |
| Maximum outside height - inside height (mm) | 3040 - 2060  |
| Thickness of floor - walls - roof (mm)      | 56 - 30 - 30 |
| Certified seats                             | 5            |
| Maximum overall weight (kg)***              | 3500         |

## BEDS

|                                                |            |
|------------------------------------------------|------------|
| Berths                                         | 4          |
| Optional berths                                | 1          |
| Overcab double bed                             | 1400x2200  |
| Assemblable single bed centre dinette optional | 1040x2200  |
| Assemblable double bed centre dinette optional | -          |
| Assemblable double bed rear dinette optional   | -          |
| Rear single bed                                | -          |
| Rear double bed                                | 1400x1900  |
| Bunk bed                                       | -          |
| Rear drop-down double bed                      | on request |

## TANKS

|                            |                  |
|----------------------------|------------------|
| Drinking water (inside)*** | 20 + 65 l.       |
| Waste water tank           | 120 l.           |
| Antifreeze tank            | on request       |
| Gas bottle locker          | (1+1) x 11:13 kg |

## EQUIPMENT

|                                                          |                               |
|----------------------------------------------------------|-------------------------------|
| Gas heater                                               | Combi C4                      |
| Water heater                                             | Combi C4                      |
| Cabin swivel seats                                       | ✓                             |
| Panoramic porthole living area                           | -                             |
| Openable panoramic porthole low-profile models front pod | -                             |
| Fridge                                                   | 141 l.                        |
| Nr. burners hob                                          | 3                             |
| Extractor hood                                           | on request                    |
| Oven                                                     | on request                    |
| Garage (access door dimensions) H (mm) x W (mm)          | 750x850 (1150x850 on request) |
| Driver's cabin blackout blind                            | on request                    |
| Entrance door with fly screen                            | on request                    |
| TV-holder                                                | on request                    |
| Roof rack with ladder                                    | on request                    |
| Service battery                                          | on request                    |
| Cabin seat covers                                        | on request                    |
| Parking feet                                             | on request                    |
| Bicycle rack                                             | on request                    |
| Alarm system                                             | on request                    |
| Outside entrance door lamp                               | on request                    |

\*the Ford Transit 121kW - 165 CV engine is available on request

\*\*\*for legal information about the weights see page 133

# KILIG 695



↔  
**7308x2340**



**5**



**5**  
(1 opt)



**1050x850**

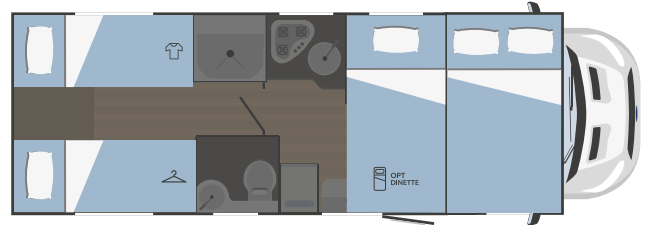
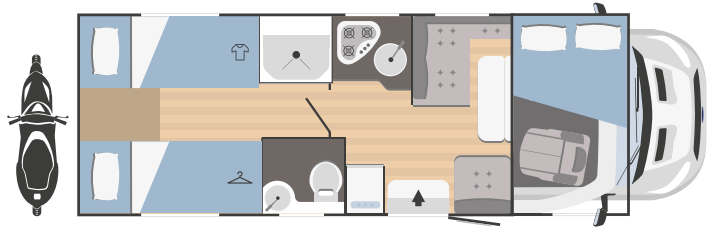

## MECHANICAL UNIT

|                       |              |
|-----------------------|--------------|
| Engine                | Ford Transit |
| Wheelbase (mm)        | 3954         |
| Displacement (L)      | 2,0          |
| Maximum power (kW-HP) | 96 - 130*    |
| Radio                 | ✓            |

## DIMENSIONS AND WEIGHTS

|                                             |              |
|---------------------------------------------|--------------|
| Outside length (mm)                         | 7308         |
| Outside width - inside width (mm)           | 2340 - 2200  |
| Maximum outside height - inside height (mm) | 3040 - 2060  |
| Thickness of floor - walls - roof (mm)      | 56 - 30 - 30 |
| Certified seats                             | 5            |
| Maximum overall weight (kg)***              | 3500         |

## BEDS

|                                                |                               |
|------------------------------------------------|-------------------------------|
| Berths                                         | 4                             |
| Optional berths                                | 1                             |
| Overcab double bed                             | 1400x2200                     |
| Assemblable single bed centre dinette optional | 1040x2200                     |
| Assemblable double bed centre dinette optional | -                             |
| Assemblable double bed rear dinette optional   | -                             |
| Rear single bed                                | n. 1 800x2025<br>n 1 800x2100 |
| Rear double bed                                | with extension: 1400x2200     |
| Bunk bed                                       | -                             |
| Rear drop-down double bed                      | -                             |

## TANKS

|                            |                  |
|----------------------------|------------------|
| Drinking water (inside)*** | 20 + 65 l.       |
| Waste water tank           | 120 l.           |
| Antifreeze tank            | on request       |
| Gas bottle locker          | (1+1) x 11:13 kg |

## EQUIPMENT

|                                                          |            |
|----------------------------------------------------------|------------|
| Gas heater                                               | Combi C4   |
| Water heater                                             | Combi C4   |
| Cabin swivel seats                                       | ✓          |
| Panoramic porthole living area                           | -          |
| Openable panoramic porthole low-profile models front pod | -          |
| Fridge                                                   | 141 l.     |
| Nr. burners hob                                          | 3          |
| Extractor hood                                           | on request |
| Oven                                                     | on request |
| Garage (access door dimensions) H (mm) x W (mm)          | 1050x850   |
| Driver's cabin blackout blind                            | on request |
| Entrance door with fly screen                            | on request |
| TV-holder                                                | on request |
| Roof rack with ladder                                    | on request |
| Service battery                                          | on request |
| Cabin seat covers                                        | on request |
| Parking feet                                             | on request |
| Bicycle rack                                             | on request |
| Alarm system                                             | on request |
| Outside entrance door lamp                               | on request |

\*the Ford Transit 121kW - 165 CV engine is available on request

\*\*\*for legal information about the weights see page 133

# KILIG 18 PLUS



↔  
**5953x2340**

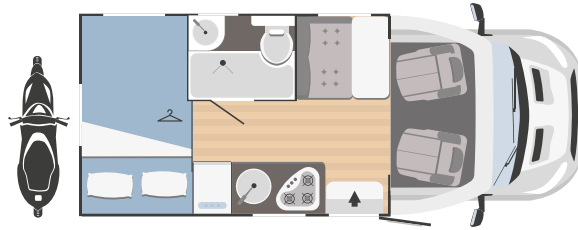

**4**



**4**  
(1 opt)



**1000x650**

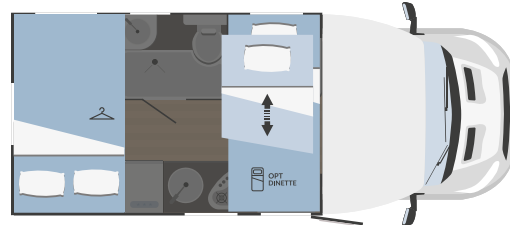

## MECHANICAL UNIT

|                       |              |
|-----------------------|--------------|
| Engine                | Ford Transit |
| Wheelbase (mm)        | 3300         |
| Displacement (L)      | 2,0          |
| Maximum power (kW-HP) | 96 - 130*    |
| Radio                 | ✓            |

## DIMENSIONS AND WEIGHTS

|                                             |              |
|---------------------------------------------|--------------|
| Outside length (mm)                         | 5953         |
| Outside width - inside width (mm)           | 2340 - 2200  |
| Maximum outside height - inside height (mm) | 2845 - 2060  |
| Thickness of floor - walls - roof (mm)      | 56 - 30 - 30 |
| Certified seats                             | 4            |
| Maximum overall weight (kg)***              | 3500         |

## BEDS

|                                                 |           |
|-------------------------------------------------|-----------|
| Berths                                          | 3         |
| Optional berths                                 | 1         |
| Assemblable single bed centre dinette optional  | 1050x2200 |
| Assemblable double bed centre dinette optional  | -         |
| Assemblable double bed rear dinette optional    | -         |
| Front drop-down bed                             | 980x2200  |
| Rear drop-down bed                              | -         |
| Drop-down bed maximum static load capacity (kg) | 250       |
| Rear single bed                                 | -         |
| Rear double bed                                 | 1230x2200 |
| Bunk bed                                        | -         |
| Rear drop-down double bed                       | -         |

## TANKS

|                            |                  |
|----------------------------|------------------|
| Drinking water (inside)*** | 20 + 65 l.       |
| Waste water tank           | 73 l.            |
| Antifreeze tank            | on request       |
| Gas bottle locker          | (1+1) x 11:13 kg |

## EQUIPMENT

|                                                          |            |
|----------------------------------------------------------|------------|
| Gas heater                                               | Combi C4   |
| Water heater                                             | Combi C4   |
| Cabin swivel seats                                       | ✓          |
| Panoramic porthole living area                           | -          |
| Openable panoramic porthole low-profile models front pod | on request |
| Fridge                                                   | 141 l.     |
| Nr. burners hob                                          | 3          |
| Extractor hood                                           | on request |
| Oven                                                     | on request |
| Garage (access door dimensions) H (mm) x W (mm)          | 1000x650   |
| Driver's cabin blackout blind                            | on request |
| Entrance door with fly screen                            | on request |
| TV-holder                                                | on request |
| Roof rack with ladder                                    | on request |
| Service battery                                          | on request |
| Cabin seat covers                                        | on request |
| Parking feet                                             | on request |
| Bicycle rack                                             | on request |
| Alarm system                                             | on request |
| Outside entrance door lamp                               | on request |

\*the Ford Transit 121kW - 165 CV engine is available on request

\*\*\*for legal information about the weights see page 133

# KILIG 66 PLUS



↔  
**7338x2340**



**750x850**  
(1150x850 opt)

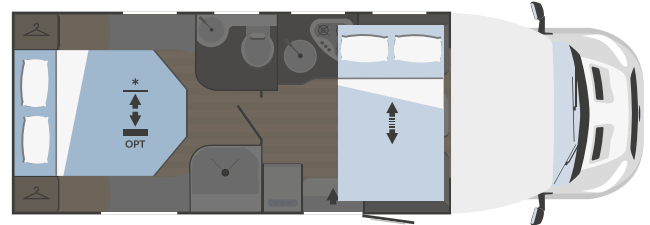
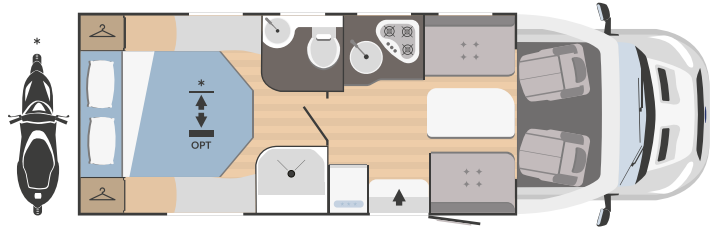

## MECHANICAL UNIT

|                       |              |
|-----------------------|--------------|
| Engine                | Ford Transit |
| Wheelbase (mm)        | 3954         |
| Displacement (L)      | 2,0          |
| Maximum power (kW-HP) | 96 - 130*    |
| Radio                 | ✓            |

## DIMENSIONS AND WEIGHTS

|                                             |              |
|---------------------------------------------|--------------|
| Outside length (mm)                         | 7338         |
| Outside width - inside width (mm)           | 2340 - 2200  |
| Maximum outside height - inside height (mm) | 2845 - 2060  |
| Thickness of floor - walls - roof (mm)      | 56 - 30 - 30 |
| Certified seats                             | 4            |
| Maximum overall weight (kg)***              | 3500         |

## BEDS

|                                                 |            |
|-------------------------------------------------|------------|
| Berths                                          | 4          |
| Optional berths                                 | -          |
| Assemblable single bed centre dinette optional  | -          |
| Assemblable double bed centre dinette optional  | -          |
| Assemblable double bed rear dinette optional    | -          |
| Front drop-down bed                             | 1215x2000  |
| Rear drop-down bed                              | -          |
| Drop-down bed maximum static load capacity (kg) | 250        |
| Rear single bed                                 | -          |
| Rear double bed                                 | 1400x1900  |
| Bunk bed                                        | -          |
| Rear drop-down double bed                       | on request |

## TANKS

|                            |                  |
|----------------------------|------------------|
| Drinking water (inside)*** | 20 + 60 l.       |
| Waste water tank           | 120 l.           |
| Antifreeze tank            | on request       |
| Gas bottle locker          | (1+1) x 11:13 kg |

## EQUIPMENT

|                                                          |                               |
|----------------------------------------------------------|-------------------------------|
| Gas heater                                               | Combi C4                      |
| Water heater                                             | Combi C4                      |
| Cabin swivel seats                                       | ✓                             |
| Panoramic porthole living area                           | -                             |
| Openable panoramic porthole low-profile models front pod | on request                    |
| Fridge                                                   | 141 l.                        |
| Nr. burners hob                                          | 3                             |
| Extractor hood                                           | on request                    |
| Oven                                                     | on request                    |
| Garage (access door dimensions) H (mm) x W (mm)          | 750x850 (1150x850 on request) |
| Driver's cabin blackout blind                            | on request                    |
| Entrance door with fly screen                            | on request                    |
| TV-holder                                                | on request                    |
| Roof rack with ladder                                    | on request                    |
| Service battery                                          | on request                    |
| Cabin seat covers                                        | on request                    |
| Parking feet                                             | on request                    |
| Bicycle rack                                             | on request                    |
| Alarm system                                             | on request                    |
| Outside entrance door lamp                               | on request                    |

\*the Ford Transit 121kW - 165 CV engine is available on request

\*\*\*for legal information about the weights see page 133

# KILIG 67 PLUS



↔  
**6449x2340**



**4**



**4**  
(2 opt)



**1050x630**

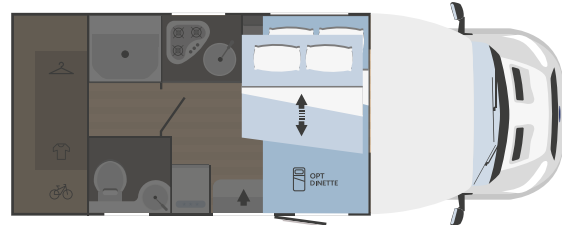
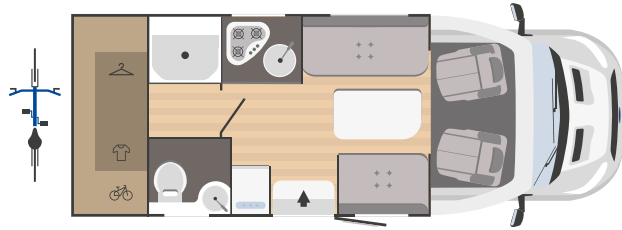

## MECHANICAL UNIT

|                       |              |
|-----------------------|--------------|
| Engine                | Ford Transit |
| Wheelbase (mm)        | 3750         |
| Displacement (L)      | 2,0          |
| Maximum power (kW-HP) | 96 - 130*    |
| Radio                 | ✓            |

## DIMENSIONS AND WEIGHTS

|                                             |              |
|---------------------------------------------|--------------|
| Outside length (mm)                         | 6449         |
| Outside width - inside width (mm)           | 2340 - 2200  |
| Maximum outside height - inside height (mm) | 2845 - 2060  |
| Thickness of floor - walls - roof (mm)      | 56 - 30 - 30 |
| Certified seats                             | 4            |
| Maximum overall weight (kg)***              | 3500         |

## BEDS

|                                                 |           |
|-------------------------------------------------|-----------|
| Berths                                          | 2         |
| Optional berths                                 | 2         |
| Assemblable single bed centre dinette optional  | -         |
| Assemblable double bed centre dinette optional  | 1400x2200 |
| Assemblable double bed rear dinette optional    | -         |
| Front drop-down bed                             | 1370x2000 |
| Rear drop-down bed                              | -         |
| Drop-down bed maximum static load capacity (kg) | 250       |
| Rear single bed                                 | -         |
| Rear double bed                                 | -         |
| Bunk bed                                        | -         |
| Rear drop-down double bed                       | -         |

## TANKS

|                            |                  |
|----------------------------|------------------|
| Drinking water (inside)*** | 20 + 60 l.       |
| Waste water tank           | 73 l.            |
| Antifreeze tank            | on request       |
| Gas bottle locker          | (1+1) x 11:13 kg |

## EQUIPMENT

|                                                          |            |
|----------------------------------------------------------|------------|
| Gas heater                                               | Combi C4   |
| Water heater                                             | Combi C4   |
| Cabin swivel seats                                       | ✓          |
| Panoramic porthole living area                           | -          |
| Openable panoramic porthole low-profile models front pod | on request |
| Fridge                                                   | 141 l.     |
| Nr. burners hob                                          | 3          |
| Extractor hood                                           | on request |
| Oven                                                     | on request |
| Garage (access door dimensions) H (mm) x W (mm)          | 1050x630   |
| Driver's cabin blackout blind                            | on request |
| Entrance door with fly screen                            | on request |
| TV-holder                                                | on request |
| Roof rack with ladder                                    | on request |
| Service battery                                          | on request |
| Cabin seat covers                                        | on request |
| Parking feet                                             | on request |
| Bicycle rack                                             | on request |
| Alarm system                                             | on request |
| Outside entrance door lamp                               | on request |

\*the Ford Transit 121kW - 165 CV engine is available on request

\*\*\*for legal information about the weights see page 133

# KILIG 69 PLUS



↔  
**7308x2340**

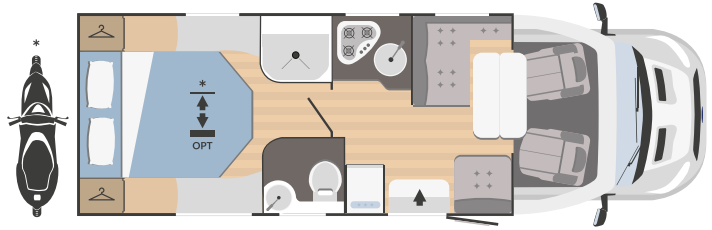

**5**



**5**  
(1 opt)



**750x850**  
(1150x850 opt)

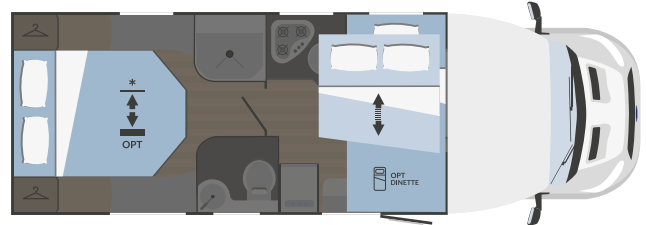

## MECHANICAL UNIT

|                       |              |
|-----------------------|--------------|
| Engine                | Ford Transit |
| Wheelbase (mm)        | 3954         |
| Displacement (L)      | 2,0          |
| Maximum power (kW-HP) | 96 - 130*    |
| Radio                 | ✓            |

## DIMENSIONS AND WEIGHTS

|                                             |              |
|---------------------------------------------|--------------|
| Outside length (mm)                         | 7308         |
| Outside width - inside width (mm)           | 2340 - 2200  |
| Maximum outside height - inside height (mm) | 2845 - 2060  |
| Thickness of floor - walls - roof (mm)      | 56 - 30 - 30 |
| Certified seats                             | 5            |
| Maximum overall weight (kg)***              | 3500         |

## BEDS

|                                                 |            |
|-------------------------------------------------|------------|
| Berths                                          | 4          |
| Optional berths                                 | 1          |
| Assemblable single bed centre dinette optional  | 1040x2200  |
| Assemblable double bed centre dinette optional  | -          |
| Assemblable double bed rear dinette optional    | -          |
| Front drop-down bed                             | 1215x2000  |
| Rear drop-down bed                              | -          |
| Drop-down bed maximum static load capacity (kg) | 250        |
| Rear single bed                                 | -          |
| Rear double bed                                 | 1400x1900  |
| Bunk bed                                        | -          |
| Rear drop-down double bed                       | on request |

## TANKS

|                            |                  |
|----------------------------|------------------|
| Drinking water (inside)*** | 20 + 65 l.       |
| Waste water tank           | 120 l.           |
| Antifreeze tank            | on request       |
| Gas bottle locker          | (1+1) x 11:13 kg |

## EQUIPMENT

|                                                          |                               |
|----------------------------------------------------------|-------------------------------|
| Gas heater                                               | Combi C4                      |
| Water heater                                             | Combi C4                      |
| Cabin swivel seats                                       | ✓                             |
| Panoramic porthole living area                           | -                             |
| Openable panoramic porthole low-profile models front pod | on request                    |
| Fridge                                                   | 141 l.                        |
| Nr. burners hob                                          | 3                             |
| Extractor hood                                           | on request                    |
| Oven                                                     | on request                    |
| Garage (access door dimensions) H (mm) x W (mm)          | 750x850 (1150x850 on request) |
| Driver's cabin blackout blind                            | on request                    |
| Entrance door with fly screen                            | on request                    |
| TV-holder                                                | on request                    |
| Roof rack with ladder                                    | on request                    |
| Service battery                                          | on request                    |
| Cabin seat covers                                        | on request                    |
| Parking feet                                             | on request                    |
| Bicycle rack                                             | on request                    |
| Alarm system                                             | on request                    |
| Outside entrance door lamp                               | on request                    |

\*the Ford Transit 121kW - 165 CV engine is available on request

\*\*\*for legal information about the weights see page 133

NEW

# KILIG 77 PLUS



↔  
**6970x2340**



**5**



**7**  
(3 opt)



**550x700**

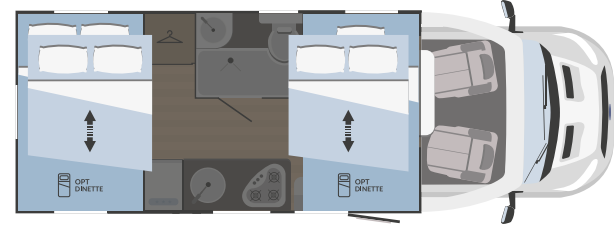
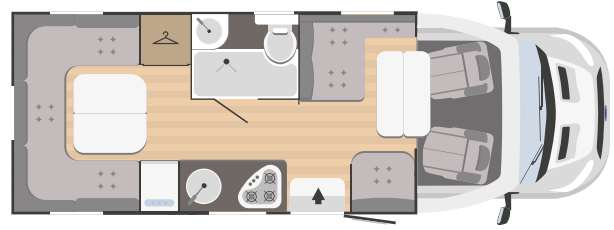

## MECHANICAL UNIT

|                       |              |
|-----------------------|--------------|
| Engine                | Ford Transit |
| Wheelbase (mm)        | 3750         |
| Displacement (L)      | 2,0          |
| Maximum power (kW-HP) | 96 - 130*    |
| Radio                 | ✓            |

## DIMENSIONS AND WEIGHTS

|                                             |              |
|---------------------------------------------|--------------|
| Outside length (mm)                         | 6970         |
| Outside width - inside width (mm)           | 2340 - 2200  |
| Maximum outside height - inside height (mm) | 2845 - 2060  |
| Thickness of floor - walls - roof (mm)      | 56 - 30 - 30 |
| Certified seats                             | 5            |
| Maximum overall weight (kg)***              | 3500         |

## BEDS

|                                                 |           |
|-------------------------------------------------|-----------|
| Berths                                          | 4         |
| Optional berths                                 | 3         |
| Assemblable single bed centre dinette optional  | 1040x2200 |
| Assemblable double bed centre dinette optional  | -         |
| Assemblable double bed rear dinette optional    | 1400x2200 |
| Front drop-down bed                             | 1215x2000 |
| Rear drop-down bed                              | 1215x2000 |
| Drop-down bed maximum static load capacity (kg) | 250       |
| Rear single bed                                 | -         |
| Rear double bed                                 | -         |
| Bunk bed                                        | -         |
| Rear drop-down double bed                       | -         |

## TANKS

|                            |                  |
|----------------------------|------------------|
| Drinking water (inside)*** | 20 + 65 l.       |
| Waste water tank           | 120 l.           |
| Antifreeze tank            | on request       |
| Gas bottle locker          | (1+1) x 11:13 kg |

## EQUIPMENT

|                                                          |            |
|----------------------------------------------------------|------------|
| Gas heater                                               | Combi C4   |
| Water heater                                             | Combi C4   |
| Cabin swivel seats                                       | ✓          |
| Panoramic porthole living area                           | -          |
| Openable panoramic porthole low-profile models front pod | on request |
| Fridge                                                   | 141 l.     |
| Nr. burners hob                                          | 3          |
| Extractor hood                                           | on request |
| Oven                                                     | on request |
| Garage (access door dimensions) H (mm) x W (mm)          | 550x700    |
| Driver's cabin blackout blind                            | on request |
| Entrance door with fly screen                            | on request |
| TV-holder                                                | on request |
| Roof rack with ladder                                    | on request |
| Service battery                                          | on request |
| Cabin seat covers                                        | on request |
| Parking feet                                             | on request |
| Bicycle rack                                             | on request |
| Alarm system                                             | on request |
| Outside entrance door lamp                               | on request |

\*the Ford Transit 121kW - 165 CV engine is available on request

\*\*\*for legal information about the weights see page 133

# KILIG 95 PLUS



↔  
**7308x2340**



**5**



**5**  
(1 opt)



**1050x850**



## MECHANICAL UNIT

|                       |              |
|-----------------------|--------------|
| Engine                | Ford Transit |
| Wheelbase (mm)        | 3954         |
| Displacement (L)      | 2,0          |
| Maximum power (kW-HP) | 96 - 130*    |
| Radio                 | ✓            |

## DIMENSIONS AND WEIGHTS

|                                             |              |
|---------------------------------------------|--------------|
| Outside length (mm)                         | 7308         |
| Outside width - inside width (mm)           | 2340 - 2200  |
| Maximum outside height - inside height (mm) | 2845 - 2060  |
| Thickness of floor - walls - roof (mm)      | 56 - 30 - 30 |
| Certified seats                             | 5            |
| Maximum overall weight (kg)***              | 3500         |

## BEDS

|                                                 |                              |
|-------------------------------------------------|------------------------------|
| Berths                                          | 4                            |
| Optional berths                                 | 1                            |
| Assemblable single bed centre dinette optional  | 1040x2200                    |
| Assemblable double bed centre dinette optional  | -                            |
| Assemblable double bed rear dinette optional    | -                            |
| Front drop-down bed                             | 1215x2000                    |
| Rear drop-down bed                              | -                            |
| Drop-down bed maximum static load capacity (kg) | 250                          |
| Rear single bed                                 | n.1 800x2025<br>n.1 800x2100 |
| Rear double bed                                 | with extension: 1400x2200    |
| Bunk bed                                        | -                            |
| Rear drop-down double bed                       | -                            |

## TANKS

|                            |                  |
|----------------------------|------------------|
| Drinking water (inside)*** | 20 + 65 l.       |
| Waste water tank           | 120 l.           |
| Antifreeze tank            | on request       |
| Gas bottle locker          | (1+1) x 11:13 kg |

## EQUIPMENT

|                                                          |            |
|----------------------------------------------------------|------------|
| Gas heater                                               | Combi C4   |
| Water heater                                             | Combi C4   |
| Cabin swivel seats                                       | ✓          |
| Panoramic porthole living area                           | -          |
| Openable panoramic porthole low-profile models front pod | on request |
| Fridge                                                   | 141 l.     |
| Nr. burners hob                                          | 3          |
| Extractor hood                                           | on request |
| Oven                                                     | on request |
| Garage (access door dimensions) H (mm) x W (mm)          | 1050x850   |
| Driver's cabin blackout blind                            | on request |
| Entrance door with fly screen                            | on request |
| TV-holder                                                | on request |
| Roof rack with ladder                                    | on request |
| Service battery                                          | on request |
| Cabin seat covers                                        | on request |
| Parking feet                                             | on request |
| Bicycle rack                                             | on request |
| Alarm system                                             | on request |
| Outside entrance door lamp                               | on request |

\*the Ford Transit 121kW - 165 CV engine is available on request

\*\*\*for legal information about the weights see page 133





  
**RIMOR**

**KILIG**

77 PLUS

# Happiness like a bolt from the blue

## Choose the road to your dreams

Be amazed by the new entry with innovative design. A new range with 6 overcab and 8 low-profile models, 9 of which are compact in less than 7 metres, designed for outdoor enthusiasts, both experts and newcomers.

Every design choice aspires to offer maximum comfort and practicality. Starting with smart, durable materials: the kitchen units with soft-close drawers and XL cabinets, the kitchen top and tables in high-strength laminate. Along with design details that will make your experience even more amazing, such as the interior fittings in matt black, the kitchen sink with pull-out mixer tap and multi-purpose lid - that can be used as a chopping board, trivet or tray - flush with the cabinet.



## Sarus

Engine  
Fiat Ducato

Displacement  
2,2L



↔ from 6423  
to 7293 mm



from  
4 to 7



from 5  
to 6+1



↔ from 6423  
to 7443 mm



from  
4 to 6



from  
4 to 6



**Camper life  
has a new look**

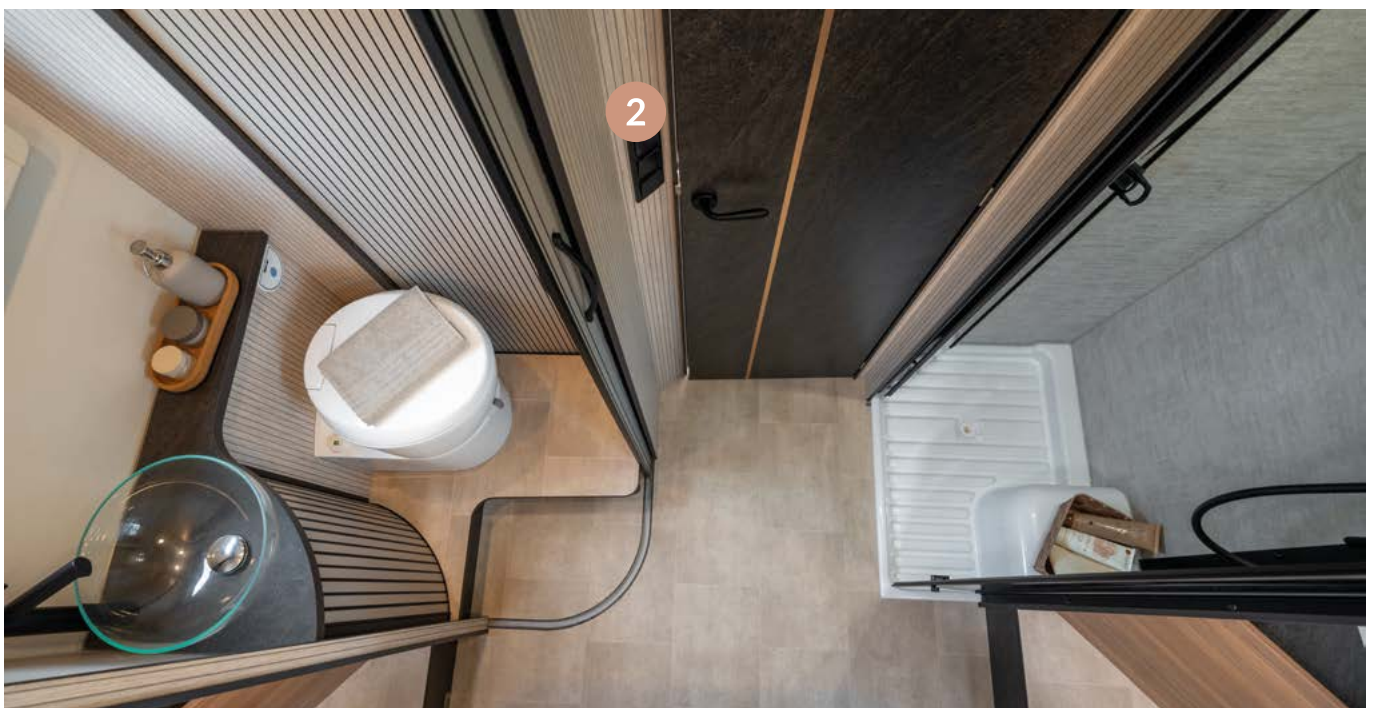

**1** Kitchen furniture with soft-close drawers and XL cabinets with pull-out rubbish bin fitted to the door of the cupboard under the sink

**2** Interior fittings in matt black (adjustable spotlights, switches and outlets)



**3** Kitchen sink with pull-out mixer tap and multi-purpose flush lid (chopping board, trivet, tray) for an even work surface

**4** Kitchen and table tops in high-strength laminate

**5** Designer kitchen storage



**6** Models 5 and 9 have a bathroom with pivoting wall in next-generation Ocritech® acrylic, easy to clean and disinfect, and UV-resistant for maximum durability

**7** Sarus 69 Plus bathroom with flush-mounted shower tray and modular shower door, for maximum comfort both when using the toilet and when moving to the bed

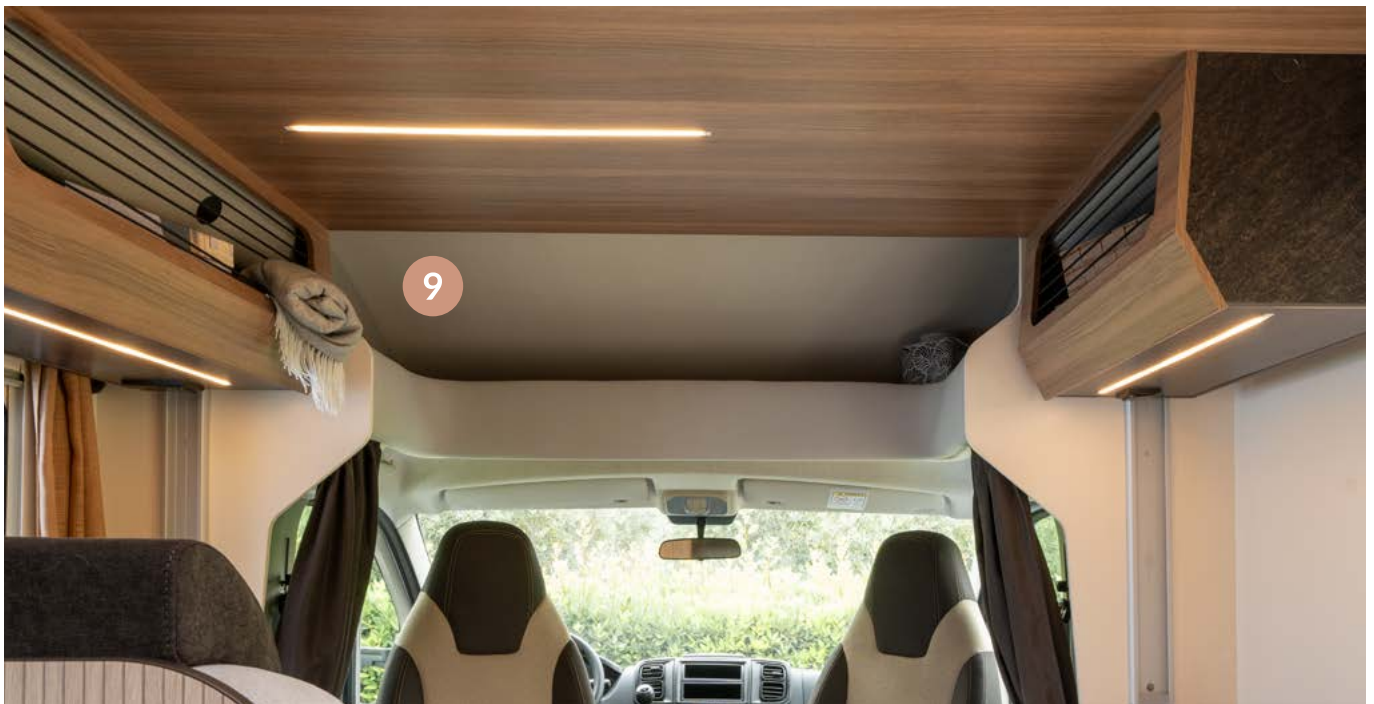

**8** Bumpers with multifunction LED lights

**9** Fairing of profiled model in soft-touch upholstery and openable skyview (optional)

- New detachable tubular garage lamp that becomes a practical inspection light
- Front drop-down bed as standard on all Plus models
- Interior height in living areas underneath the drop-down bed 185 cm
- Combi Gas heating with CP Plus digital control unit as standard
- Panoramic windows with comfortable sliding opening handle as standard





## Living area



### Front/rear facing dinette

SARUS 3  
SARUS 5

### L-shaped dinette

SARUS 8  
SARUS 695

### Double dinette

SARUS 9

### Double dinette island

SARUS 50





Double dinette





Face-to-face dinette



L-shaped dinette

## Living area



Front/rear facing dinette

SARUS 12 P

Face-to-face dinette

SARUS 66 PLUS  
SARUS 99 PLUS

Face-to-face dinette XL

SARUS 67 PLUS

L-shaped dinette

SARUS 68 PLUS  
SARUS 69 PLUS  
SARUS 95 PLUS  
SARUS 98 P



Front/rear facing dinette



Face-to-face dinette XL



Transverse bed

## Sleeping area



**French bed**  
SARUS 3

**Transverse bed**  
SARUS 5  
SARUS 8

**Bunk bed**  
SARUS 9

**Double bunk beds**  
SARUS 50

**Twin beds**  
SARUS 695



Double bunk beds



Bunk bed



French bed

## Sleeping area



### French bed

SARUS 12 P

### Central bed

SARUS 66 PLUS

SARUS 68 PLUS

SARUS 69 PLUS

### XL front drop-down bed

SARUS 67 PLUS

### Twin beds

SARUS 95 PLUS

SARUS 98 P

SARUS 99 PLUS



Central bed





Twin beds



XL front drop-down bed

## Kitchen



### Compact kitchen

SARUS 50  
SARUS 695

### Long kitchen

SARUS 3  
SARUS 8  
SARUS 9

### XL Long kitchen

SARUS 5



### Compact kitchen

SARUS 66 PLUS  
SARUS 67 PLUS  
SARUS 68 PLUS  
SARUS 69 PLUS  
SARUS 95 PLUS  
SARUS 99 PLUS

### Long kitchen

SARUS 12 P  
SARUS 98 P



Compact kitchen

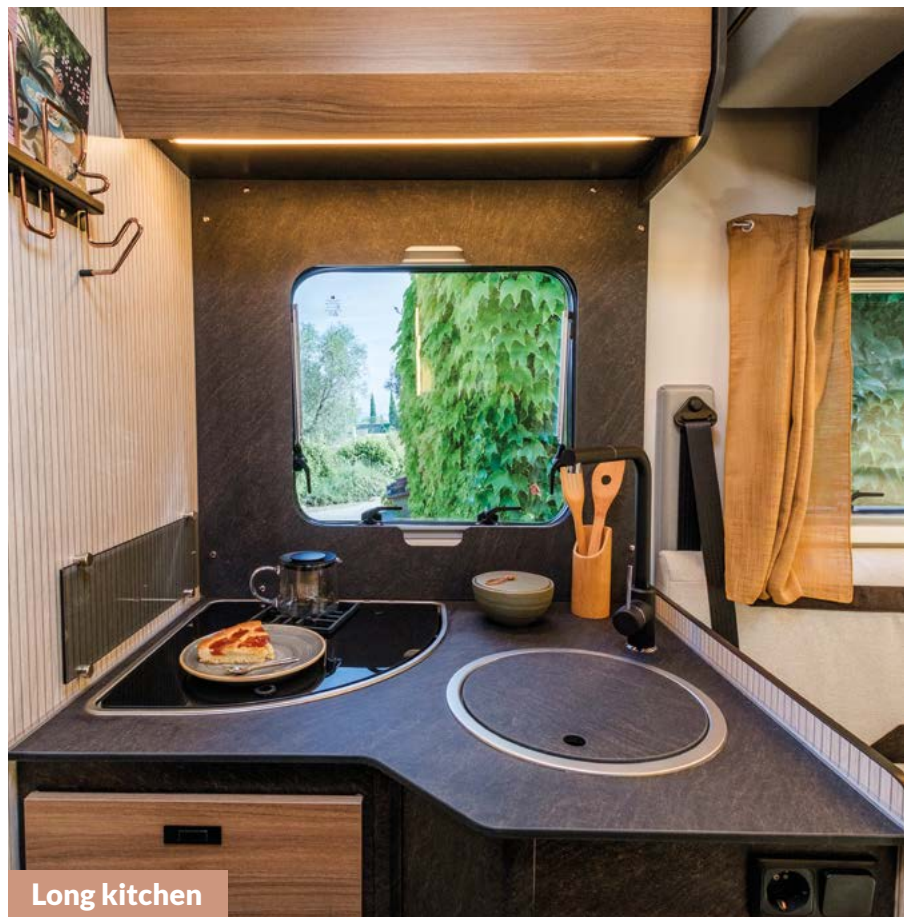

Long kitchen



XL Long kitchen

## Bathroom



Single unit with  
shower in back

SARUS 3

Single unit with  
shower alongside toilet

SARUS 8

Bathroom with shower  
that can be separated  
by a pivoting wall

SARUS 5

SARUS 9

Toilet and shower  
cubicle integrated |  
Compact

SARUS 50

Toilette e box  
doccia separati

SARUS 695

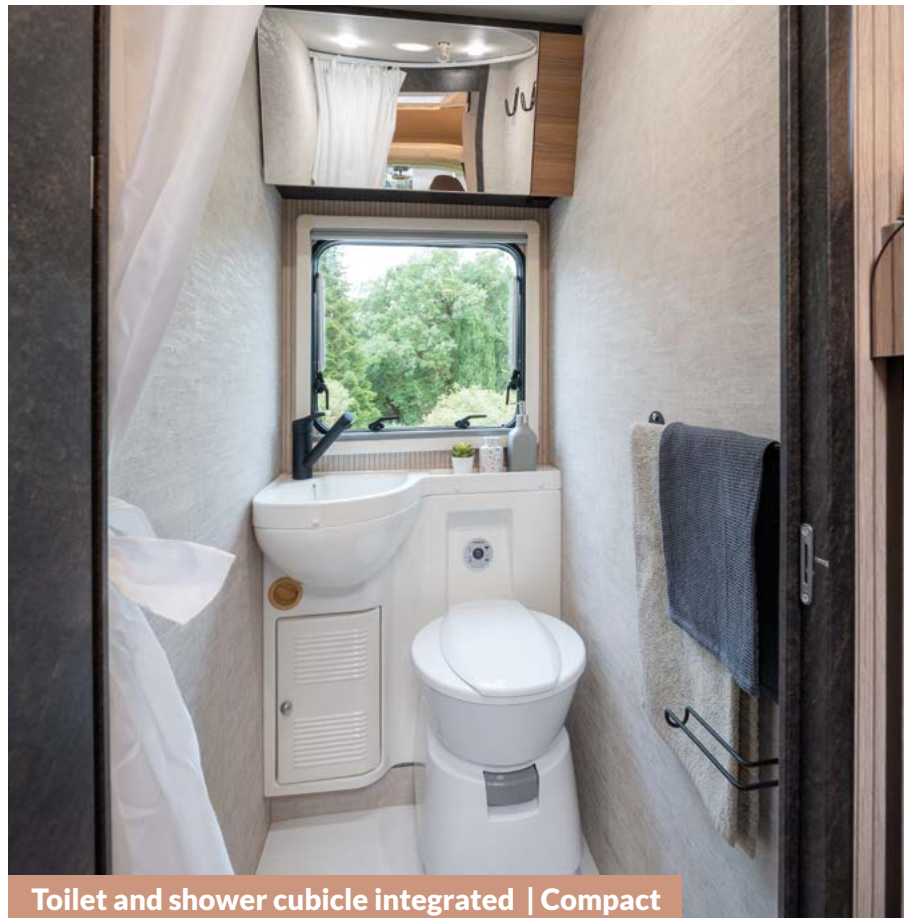

Toilet and shower cubicle integrated | Compact

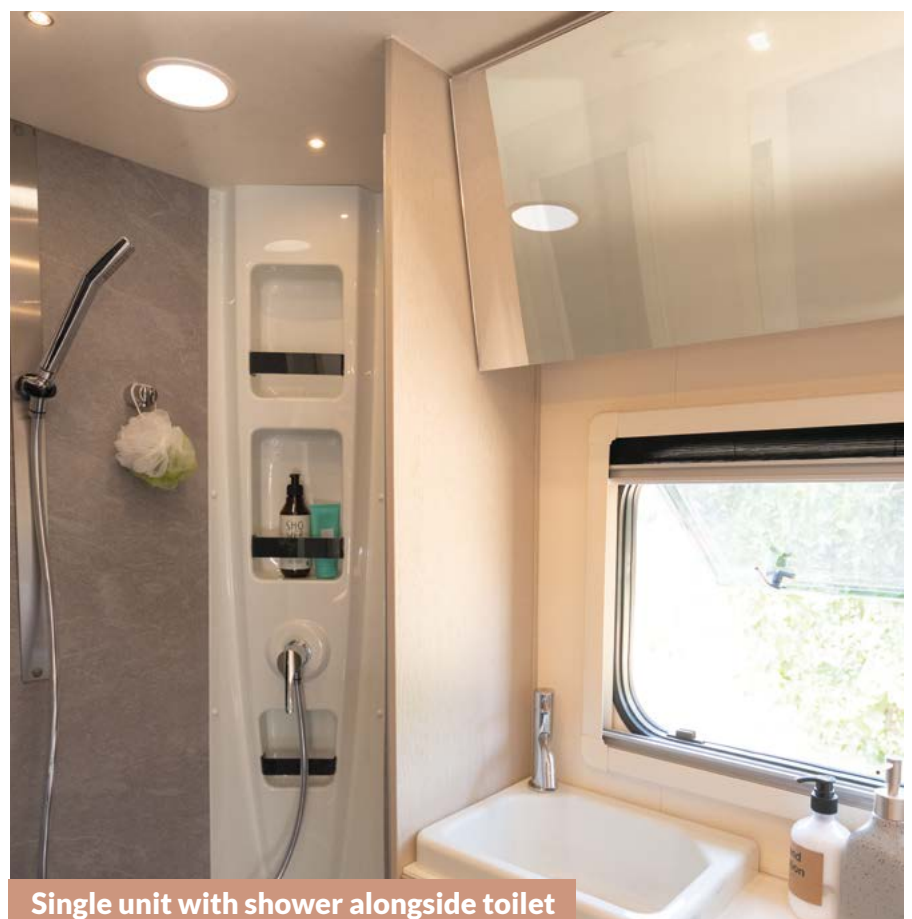

Single unit with shower alongside toilet



Bathroom with shower that can be separated by a pivoting wall

## Bathroom



**Single unit with  
shower in back**

SARUS 12 P

**Single unit with  
shower alongside  
toilet**

SARUS 98 P

**Separate toilet and  
shower cubicle**

SARUS 66 PLUS

SARUS 68 PLUS

SARUS 95 PLUS

SARUS 99 PLUS

**Full-width with  
closet**

SARUS 67 PLUS

**Flush-mounted  
shower tray and  
separate toilet with  
modular doors**

SARUS 69 PLUS

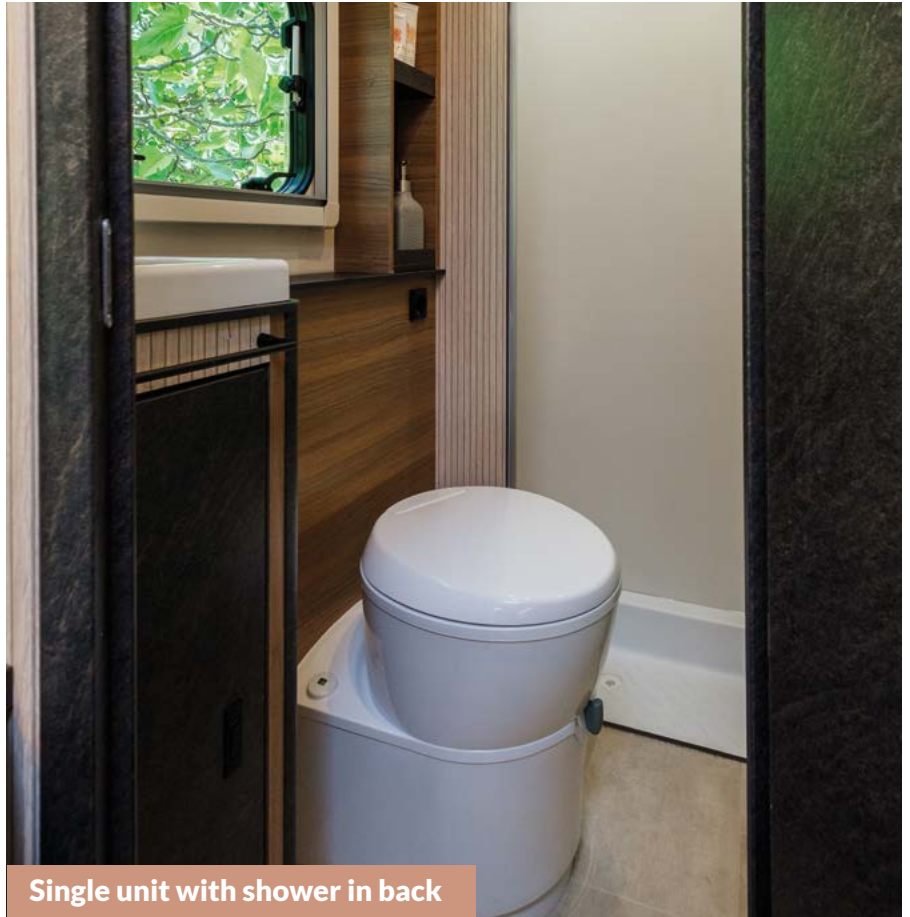

Single unit with shower in back

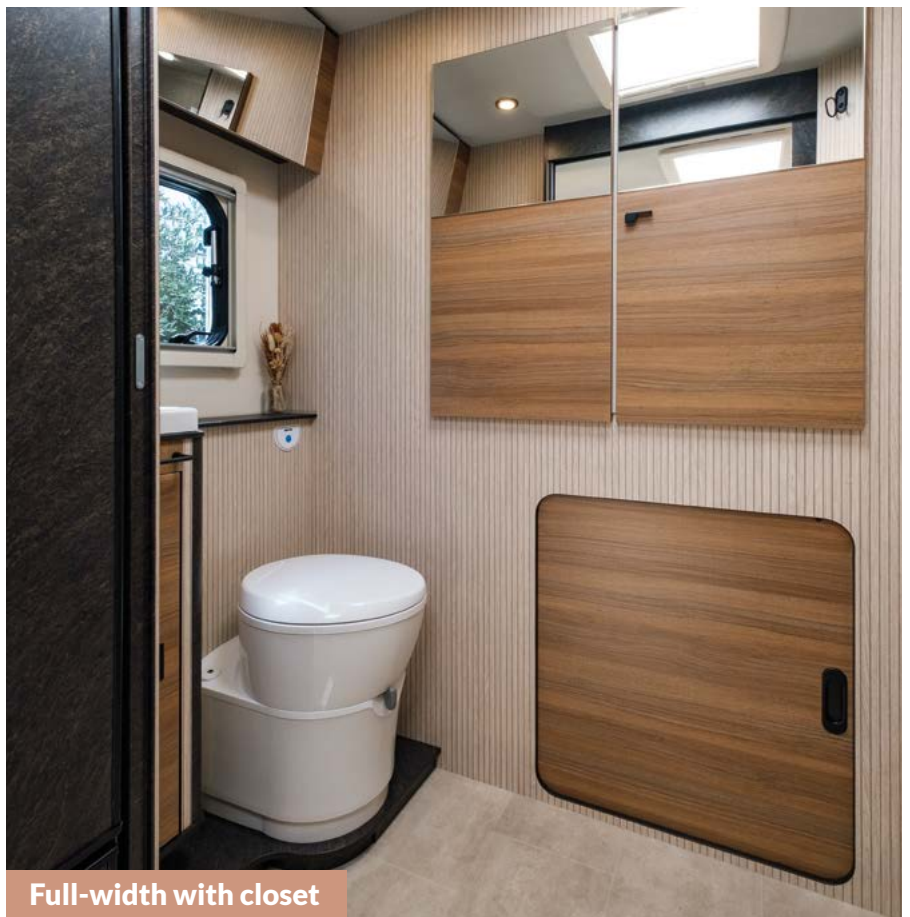

Full-width with closet



Flush-mounted shower tray and separate toilet with modular doors



Separate toilet and shower cubicle

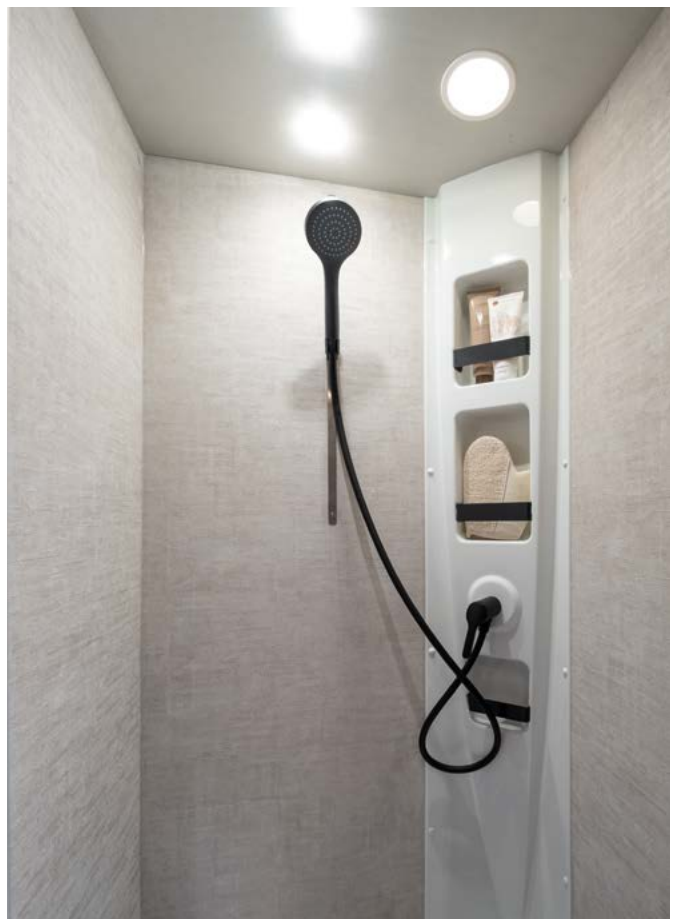

## Models and layouts

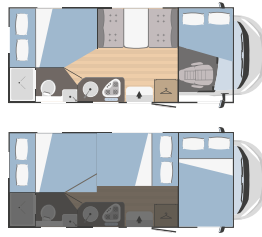

|                                                      | SARUS 3   | SARUS 5                    |
|------------------------------------------------------|-----------|----------------------------|
| ↔ Outside length x width (mm)                        | 6423x2340 | 6991x2340                  |
| 👤 Certified seats                                    | 6         | 6                          |
| 🛏 Berths                                             | 6 (2 opt) | 6 (2 opt)                  |
| 🚪 Garage (access door dimensions)<br>H (mm) x W (mm) | 450x1000  | 1280x850<br>(1080x850 opt) |

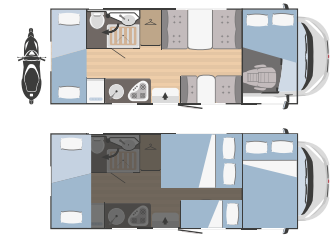

|                                                      | SARUS 8                    | SARUS 9            |
|------------------------------------------------------|----------------------------|--------------------|
| ↔ Outside length x width (mm)                        | 6838x2340                  | 6964x2340          |
| 👤 Certified seats                                    | 5                          | 6 (+1 opt 4400 kg) |
| 🛏 Berths                                             | 5 (1 opt)                  | 6+1 (2+1 opt)      |
| 🚪 Garage (access door dimensions)<br>H (mm) x W (mm) | 1280x850<br>(1080x850 opt) | 1150x650           |

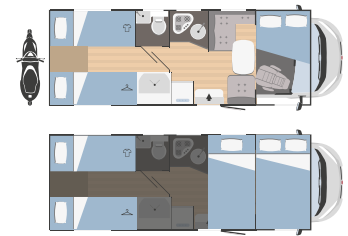
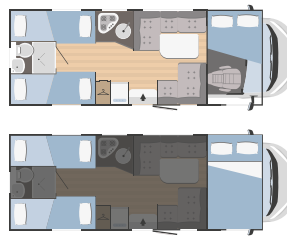

|                                                      | SARUS 50      | SARUS 695  |
|------------------------------------------------------|---------------|------------|
| ↔ Outside length x width (mm)                        | 6987x2340     | 7293x2340  |
| 👤 Certified seats                                    | 6             | 4 (+1 opt) |
| 🛏 Berths                                             | 6             | 5 (1 opt)  |
| 🚪 Garage (access door dimensions)<br>H (mm) x W (mm) | n. 2 950x1150 | 1050x750   |



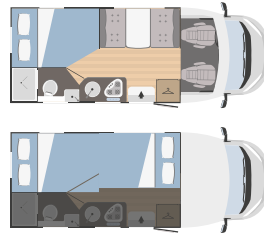

|                                                      | SARUS 12 P** | SARUS 66 PLUS             |
|------------------------------------------------------|--------------|---------------------------|
| ↔ Outside length x width (mm)                        | 6423x2340    | 7443x2340                 |
| 👤 Certified seats                                    | 6            | 4                         |
| 🛏 Berths                                             | 6 (4 opt)    | 4                         |
| 🚪 Garage (access door dimensions)<br>H (mm) x W (mm) | 450x1000     | 750x770<br>(1200x770 opt) |

\*\*also available with drop-down bed (OPT)

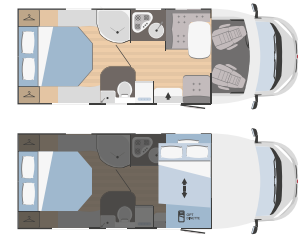

|                                                      | SARUS 67 PLUS | SARUS 68 PLUS |
|------------------------------------------------------|---------------|---------------|
| ↔ Outside length x width (mm)                        | 6450x2340     | 6973x2340     |
| 👤 Certified seats                                    | 4             | 5             |
| 🛏 Berths                                             | 4 (2 opt)     | 5 (1 opt)     |
| 🚪 Garage (access door dimensions)<br>H (mm) x W (mm) | 1050x630      | 750x750       |

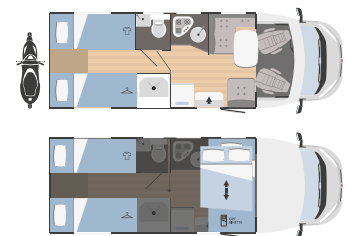
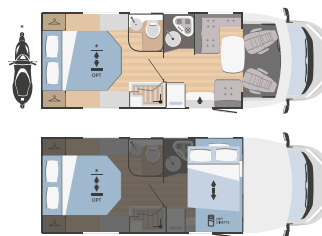

|                                                      | SARUS 69 PLUS             | SARUS 95 PLUS |
|------------------------------------------------------|---------------------------|---------------|
| ↔ Outside length x width (mm)                        | 7158x2340                 | 7293x2340     |
| 👤 Certified seats                                    | 5                         | 4 (+1 opt)    |
| 🛏 Berths                                             | 5 (1 opt)                 | 5 (1 opt)     |
| 🚪 Garage (access door dimensions)<br>H (mm) x W (mm) | 750x750<br>(1200x750 opt) | 1050x750      |

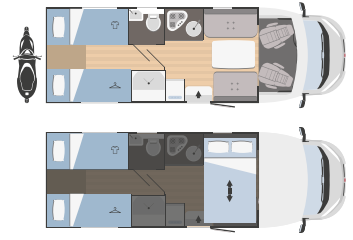

|                                                      | SARUS 98 P** | SARUS 99 PLUS |
|------------------------------------------------------|--------------|---------------|
| ↔ Outside length x width (mm)                        | 6878x2340    | 7443x2340     |
| 👤 Certified seats                                    | 5            | 4             |
| 🛏 Berths                                             | 5 (3 opt)    | 4             |
| 🚪 Garage (access door dimensions)<br>H (mm) x W (mm) | 1050x850     | 1050x750      |

\*\*also available with drop-down bed (OPT)



NEW

SARUS  
3

FIAT  
PROFESSIONAL



6423x2340



6



6

(2 opt)



450x1000

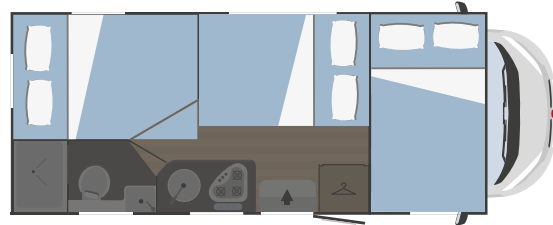
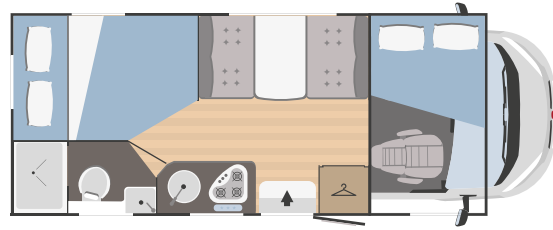

### MECHANICAL UNIT

|                       |             |
|-----------------------|-------------|
| Engine                | Fiat Ducato |
| Wheelbase (mm)        | 3800        |
| Displacement (L)      | 2,2         |
| Maximum power (kW-HP) | 103-140*    |
| Radio                 | on request  |

### DIMENSIONS AND WEIGHTS

|                                             |              |
|---------------------------------------------|--------------|
| Outside length (mm)                         | 6423         |
| Outside width - inside width (mm)           | 2340 - 2200  |
| Maximum outside height - inside height (mm) | 3050 - 2075  |
| Thickness of floor - walls - roof (mm)      | 56 - 30 - 30 |
| Certified seats                             | 6            |
| Maximum overall weight (kg)***              | 3500         |

### BEDS

|                                                |           |
|------------------------------------------------|-----------|
| Berths                                         | 4         |
| Optional berths                                | 2         |
| Overcab double bed                             | 1400x2200 |
| Assemblable single bed centre dinette optional | -         |
| Assemblable double bed centre dinette optional | 1290x1890 |
| Assemblable double bed rear dinette optional   | -         |
| Rear single bed                                | -         |
| Rear double bed                                | 1385x2056 |
| Bunk bed                                       | -         |
| Rear drop-down double bed                      | -         |

### TANKS

|                            |                  |
|----------------------------|------------------|
| Drinking water (inside)*** | 20 + 65 l.       |
| Waste water tank           | 100 l.           |
| Antifreeze tank            | on request       |
| Gas bottle locker          | (1+1) x 11:13 kg |

### EQUIPMENT

|                                                          |                              |
|----------------------------------------------------------|------------------------------|
| Gas heater                                               | Combi C4                     |
| Water heater                                             | Combi C4                     |
| Cabin swivel seats                                       | ✓                            |
| Panoramic porthole living area                           | on request                   |
| Openable panoramic porthole low-profile models front pod | -                            |
| Fridge                                                   | 89 l.<br>(141 l. on request) |
| Nr. burners hob                                          | 3                            |
| Extractor hood                                           | on request                   |
| Oven                                                     | on request                   |
| Garage (access door dimensions) H (mm) x W (mm)          | 450x1000                     |
| Driver's cabin blackout blind                            | on request                   |
| Entrance door with fly screen                            | on request                   |
| TV-holder                                                | on request                   |
| Roof rack with ladder                                    | on request                   |
| Service battery                                          | on request                   |
| Cabin seat covers                                        | on request                   |
| Parking feet                                             | on request                   |
| Bicycle rack                                             | on request                   |
| Alarm system                                             | on request                   |
| Outside entrance door lamp                               | on request                   |

\*the Fiat Ducato 132 kW - 180 CV engine is available on request

\*\*\*for legal information about the weights see page 133

NEW

**SARUS**  
5

**FIAT**  
PROFESSIONAL



↔  
**6991x2340**

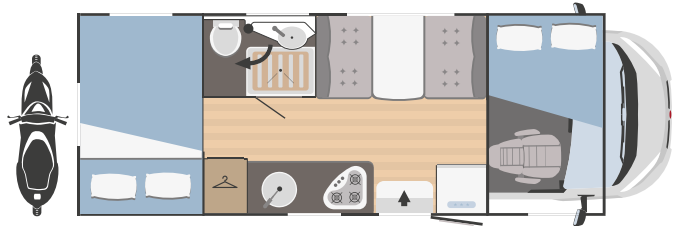

**6**



**6**

(2 opt)



**1280x850**  
(1080x850 opt)

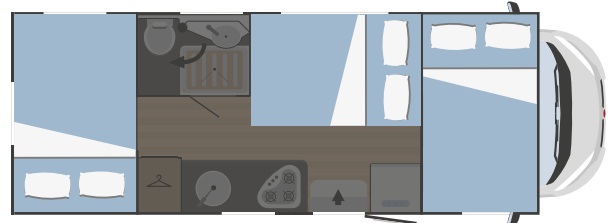

### MECHANICAL UNIT

|                       |             |
|-----------------------|-------------|
| Engine                | Fiat Ducato |
| Wheelbase (mm)        | 3800        |
| Displacement (L)      | 2,2         |
| Maximum power (kW-HP) | 103-140*    |
| Radio                 | on request  |

### DIMENSIONS AND WEIGHTS

|                                             |              |
|---------------------------------------------|--------------|
| Outside length (mm)                         | 6991         |
| Outside width - inside width (mm)           | 2340 - 2200  |
| Maximum outside height - inside height (mm) | 3050 - 2075  |
| Thickness of floor - walls - roof (mm)      | 56 - 30 - 30 |
| Certified seats                             | 6            |
| Maximum overall weight (kg)***              | 3500         |

### BEDS

|                                                |            |
|------------------------------------------------|------------|
| Berths                                         | 4          |
| Optional berths                                | 2          |
| Overcab double bed                             | 1400x2200  |
| Assemblable single bed centre dinette optional | -          |
| Assemblable double bed centre dinette optional | 1280x1890  |
| Assemblable double bed rear dinette optional   | -          |
| Rear single bed                                | -          |
| Rear double bed                                | 1360x2200  |
| Bunk bed                                       | -          |
| Rear drop-down double bed                      | on request |

### TANKS

|                            |                  |
|----------------------------|------------------|
| Drinking water (inside)*** | 20 + 65 l.       |
| Waste water tank           | 100 l.           |
| Antifreeze tank            | on request       |
| Gas bottle locker          | (1+1) x 11:13 kg |

### EQUIPMENT

|                                                          |                                   |
|----------------------------------------------------------|-----------------------------------|
| Gas heater                                               | Combi C4                          |
| Water heater                                             | Combi C4                          |
| Cabin swivel seats                                       | ✓                                 |
| Panoramic porthole living area                           | on request                        |
| Openable panoramic porthole low-profile models front pod | -                                 |
| Fridge                                                   | 89 l.<br>(141 l. on request)      |
| Nr. burners hob                                          | 3                                 |
| Extractor hood                                           | on request                        |
| Oven                                                     | on request                        |
| Garage (access door dimensions) H (mm) x W (mm)          | 1280x850<br>(1080x850 on request) |
| Driver's cabin blackout blind                            | on request                        |
| Entrance door with fly screen                            | on request                        |
| TV-holder                                                | on request                        |
| Roof rack with ladder                                    | on request                        |
| Service battery                                          | on request                        |
| Cabin seat covers                                        | on request                        |
| Parking feet                                             | on request                        |
| Bicycle rack                                             | on request                        |
| Alarm system                                             | on request                        |
| Outside entrance door lamp                               | on request                        |

\*the Fiat Ducato 132 kW - 180 CV engine is available on request

\*\*\*for legal information about the weights see page 133

NEW

**SARUS**  
8

**FIAT**  
PROFESSIONAL



↔  
**6838x2340**

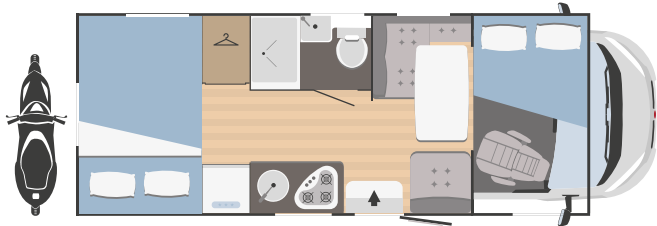

**5**



**5**  
(1 opt)



**1280x850**  
(1080x850 opt)

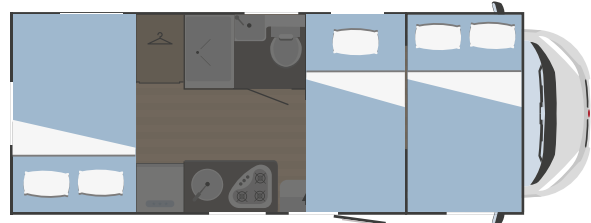

### MECHANICAL UNIT

|                       |             |
|-----------------------|-------------|
| Engine                | Fiat Ducato |
| Wheelbase (mm)        | 3800        |
| Displacement (L)      | 2,2         |
| Maximum power (kW-HP) | 103-140*    |
| Radio                 | on request  |

### DIMENSIONS AND WEIGHTS

|                                             |              |
|---------------------------------------------|--------------|
| Outside length (mm)                         | 6838         |
| Outside width - inside width (mm)           | 2340 - 2200  |
| Maximum outside height - inside height (mm) | 3050 - 2075  |
| Thickness of floor - walls - roof (mm)      | 56 - 30 - 30 |
| Certified seats                             | 5            |
| Maximum overall weight (kg)***              | 3500         |

### BEDS

|                                                |            |
|------------------------------------------------|------------|
| Berths                                         | 4          |
| Optional berths                                | 1          |
| Overcab double bed                             | 1400x2200  |
| Assemblable single bed centre dinette optional | 1100x2200  |
| Assemblable double bed centre dinette optional | -          |
| Assemblable double bed rear dinette optional   | -          |
| Rear single bed                                | -          |
| Rear double bed                                | 1356x2200  |
| Bunk bed                                       | -          |
| Rear drop-down double bed                      | on request |

### TANKS

|                            |                  |
|----------------------------|------------------|
| Drinking water (inside)*** | 20 + 65 l.       |
| Waste water tank           | 100 l.           |
| Antifreeze tank            | on request       |
| Gas bottle locker          | (1+1) x 11:13 kg |

### EQUIPMENT

|                                                          |                                |
|----------------------------------------------------------|--------------------------------|
| Gas heater                                               | Combi C4                       |
| Water heater                                             | Combi C4                       |
| Cabin swivel seats                                       | ✓                              |
| Panoramic porthole living area                           | on request                     |
| Openable panoramic porthole low-profile models front pod | -                              |
| Fridge                                                   | 89 l. (141 l. on request)      |
| Nr. burners hob                                          | 3                              |
| Extractor hood                                           | on request                     |
| Oven                                                     | on request                     |
| Garage (access door dimensions) H (mm) x W (mm)          | 1280x850 (1080x850 on request) |
| Driver's cabin blackout blind                            | on request                     |
| Entrance door with fly screen                            | on request                     |
| TV-holder                                                | on request                     |
| Roof rack with ladder                                    | on request                     |
| Service battery                                          | on request                     |
| Cabin seat covers                                        | on request                     |
| Parking feet                                             | on request                     |
| Bicycle rack                                             | on request                     |
| Alarm system                                             | on request                     |
| Outside entrance door lamp                               | on request                     |

\*the Fiat Ducato 132 kW - 180 CV engine is available on request

\*\*\*for legal information about the weights see page 133

NEW

**SARUS**  
9

**FIAT**  
PROFESSIONAL



↔  
**6964x2340**

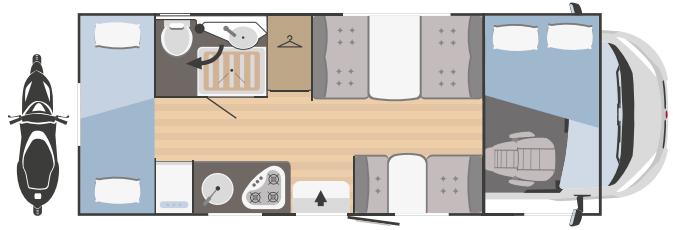

**6**  
(+1 opt  
4400 kg)



**6+1**  
(2+1 opt)



**1150x650**

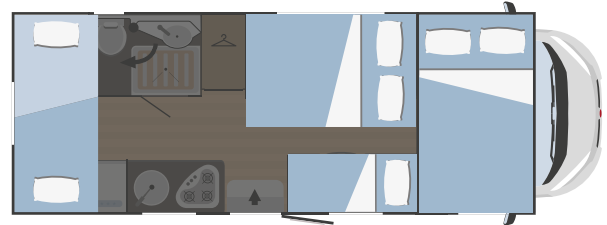

### MECHANICAL UNIT

|                       |             |
|-----------------------|-------------|
| Engine                | Fiat Ducato |
| Wheelbase (mm)        | 4035        |
| Displacement (L)      | 2,2         |
| Maximum power (kW-HP) | 103-140*    |
| Radio                 | on request  |

### DIMENSIONS AND WEIGHTS

|                                             |                    |
|---------------------------------------------|--------------------|
| Outside length (mm)                         | 6964               |
| Outside width - inside width (mm)           | 2340 - 2200        |
| Maximum outside height - inside height (mm) | 3050 - 2075        |
| Thickness of floor - walls - roof (mm)      | 56 - 30 - 30       |
| Certified seats                             | 6 (+1 opt 4400 kg) |
| Maximum overall weight (kg)***              | 3500               |

### BEDS

|                                                |           |
|------------------------------------------------|-----------|
| Berths                                         | 4         |
| Optional berths                                | 2+1       |
| Overcab double bed                             | 1400x2200 |
| Assemblable single bed centre dinette optional | 680x1430  |
| Assemblable double bed centre dinette optional | 1290x1890 |
| Assemblable double bed rear dinette optional   | -         |
| Rear single bed                                | -         |
| Rear double bed                                | -         |
| Bunk bed                                       | 810x2200  |
| Rear drop-down double bed                      | -         |

### TANKS

|                            |                  |
|----------------------------|------------------|
| Drinking water (inside)*** | 20 + 65 l.       |
| Waste water tank           | 100 l.           |
| Antifreeze tank            | on request       |
| Gas bottle locker          | (1+1) x 11:13 kg |

### EQUIPMENT

|                                                          |            |
|----------------------------------------------------------|------------|
| Gas heater                                               | Combi C4   |
| Water heater                                             | Combi C4   |
| Cabin swivel seats                                       | ✓          |
| Panoramic porthole living area                           | on request |
| Openable panoramic porthole low-profile models front pod | -          |
| Fridge                                                   | 141 l.     |
| Nr. burners hob                                          | 3          |
| Extractor hood                                           | on request |
| Oven                                                     | on request |
| Garage (access door dimensions) H (mm) x W (mm)          | 1150x650   |
| Driver's cabin blackout blind                            | on request |
| Entrance door with fly screen                            | on request |
| TV-holder                                                | on request |
| Roof rack with ladder                                    | on request |
| Service battery                                          | on request |
| Cabin seat covers                                        | on request |
| Parking feet                                             | on request |
| Bicycle rack                                             | on request |
| Alarm system                                             | on request |
| Outside entrance door lamp                               | on request |

\*the Fiat Ducato 132 kW - 180 CV engine is available on request

\*\*\*for legal information about the weights see page 133

NEW

**SARUS**  
50

**FIAT**  
PROFESSIONAL



↔  
**6987x2340**



**6**



**6**



**n.2 950x1150**



### MECHANICAL UNIT

|                       |             |
|-----------------------|-------------|
| Engine                | Fiat Ducato |
| Wheelbase (mm)        | 4035        |
| Displacement (L)      | 2,2         |
| Maximum power (kW-HP) | 103-140*    |
| Radio                 | on request  |

### DIMENSIONS AND WEIGHTS

|                                             |              |
|---------------------------------------------|--------------|
| Outside length (mm)                         | 6987         |
| Outside width - inside width (mm)           | 2340 - 2200  |
| Maximum outside height - inside height (mm) | 3050 - 2075  |
| Thickness of floor - walls - roof (mm)      | 56 - 30 - 30 |
| Certified seats                             | 6            |
| Maximum overall weight (kg)***              | 3500         |

### BEDS

|                                                |              |
|------------------------------------------------|--------------|
| Berths                                         | 6            |
| Optional berths                                | -            |
| Overcab double bed                             | 1400x2200    |
| Assemblable single bed centre dinette optional | -            |
| Assemblable double bed centre dinette optional | -            |
| Assemblable double bed rear dinette optional   | -            |
| Rear single bed                                | -            |
| Rear double bed                                | -            |
| Bunk bed                                       | n.2 710x1900 |
| Rear drop-down double bed                      | -            |

### TANKS

|                            |                  |
|----------------------------|------------------|
| Drinking water (inside)*** | 20 + 65 l.       |
| Waste water tank           | 100 l.           |
| Antifreeze tank            | on request       |
| Gas bottle locker          | (1+1) x 11:13 kg |

### EQUIPMENT

|                                                          |              |
|----------------------------------------------------------|--------------|
| Gas heater                                               | Combi C4     |
| Water heater                                             | Combi C4     |
| Cabin swivel seats                                       | ✓            |
| Panoramic porthole living area                           | on request   |
| Openable panoramic porthole low-profile models front pod | -            |
| Fridge                                                   | 141 l.       |
| Nr. burners hob                                          | 3            |
| Extractor hood                                           | on request   |
| Oven                                                     | on request   |
| Garage (access door dimensions) H (mm) x W (mm)          | n.2 950x1150 |
| Driver's cabin blackout blind                            | on request   |
| Entrance door with fly screen                            | on request   |
| TV-holder                                                | on request   |
| Roof rack with ladder                                    | on request   |
| Service battery                                          | on request   |
| Cabin seat covers                                        | on request   |
| Parking feet                                             | on request   |
| Bicycle rack                                             | on request   |
| Alarm system                                             | on request   |
| Outside entrance door lamp                               | on request   |

\*the Fiat Ducato 132 kW - 180 CV engine is available on request

\*\*\*for legal information about the weights see page 133



NEW

**SARUS**  
695

**FIAT**  
PROFESSIONAL



**7293x2340**

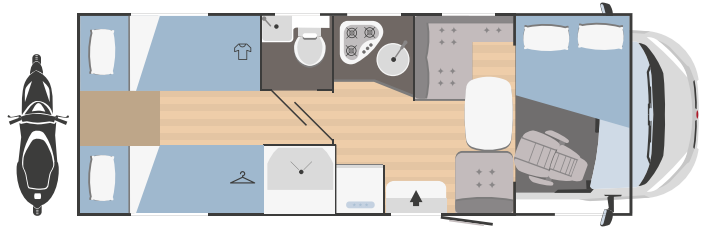

**4**

(+1 opt)



**5**

(1 opt)



**1050x750**

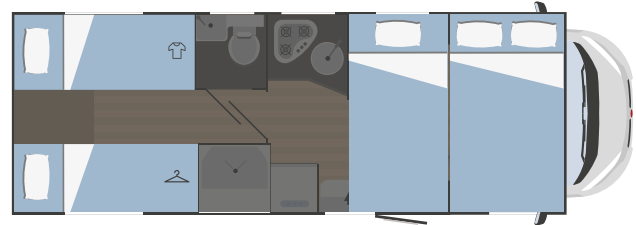

### MECHANICAL UNIT

|                       |             |
|-----------------------|-------------|
| Engine                | Fiat Ducato |
| Wheelbase (mm)        | 4035        |
| Displacement (L)      | 2,2         |
| Maximum power (kW-HP) | 103-140*    |
| Radio                 | on request  |

### DIMENSIONS AND WEIGHTS

|                                             |              |
|---------------------------------------------|--------------|
| Outside length (mm)                         | 7293         |
| Outside width - inside width (mm)           | 2340 - 2200  |
| Maximum outside height - inside height (mm) | 3050 - 2075  |
| Thickness of floor - walls - roof (mm)      | 56 - 30 - 30 |
| Certified seats                             | 4 (+1 opt)   |
| Maximum overall weight (kg)***              | 3500         |

### BEDS

|                                                |                               |
|------------------------------------------------|-------------------------------|
| Berths                                         | 4                             |
| Optional berths                                | 1                             |
| Overcab double bed                             | 1400x2200                     |
| Assemblable single bed centre dinette optional | 1100x2200                     |
| Assemblable double bed centre dinette optional | -                             |
| Assemblable double bed rear dinette optional   | -                             |
| Rear single bed                                | n.1 800x1975<br>n. 1 750x2040 |
| Rear double bed                                | with extension: 1900x2200     |
| Bunk bed                                       | -                             |
| Rear drop-down double bed                      | -                             |

### TANKS

|                            |                  |
|----------------------------|------------------|
| Drinking water (inside)*** | 20 + 65 l.       |
| Waste water tank           | 100 l.           |
| Antifreeze tank            | on request       |
| Gas bottle locker          | (1+1) x 11:13 kg |

### EQUIPMENT

|                                                          |                           |
|----------------------------------------------------------|---------------------------|
| Gas heater                                               | Combi C4                  |
| Water heater                                             | Combi C4                  |
| Cabin swivel seats                                       | ✓                         |
| Panoramic porthole living area                           | on request                |
| Openable panoramic porthole low-profile models front pod | -                         |
| Fridge                                                   | 89 l. (141 l. on request) |
| Nr. burners hob                                          | 3                         |
| Extractor hood                                           | on request                |
| Oven                                                     | on request                |
| Garage (access door dimensions) H (mm) x W (mm)          | 1050x750                  |
| Driver's cabin blackout blind                            | on request                |
| Entrance door with fly screen                            | on request                |
| TV-holder                                                | on request                |
| Roof rack with ladder                                    | on request                |
| Service battery                                          | on request                |
| Cabin seat covers                                        | on request                |
| Parking feet                                             | on request                |
| Bicycle rack                                             | on request                |
| Alarm system                                             | on request                |
| Outside entrance door lamp                               | on request                |

\*the Fiat Ducato 132 kW - 180 CV engine is available on request

\*\*\*for legal information about the weights see page 133

**NEW**

**SARUS** \*\*  
12 P

**FIAT**  
PROFESSIONAL



↔  
**6423x2340**



**6**



**6**

(4 opt)



**450x1000**

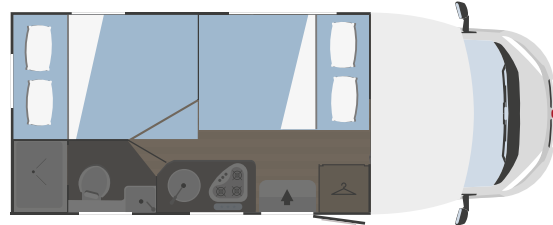
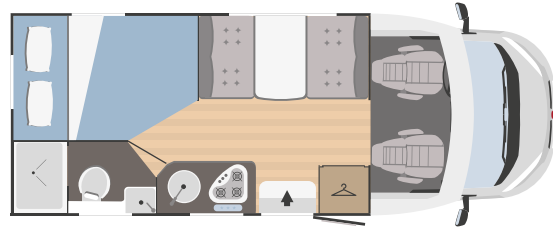

### MECHANICAL UNIT

|                       |             |
|-----------------------|-------------|
| Engine                | Fiat Ducato |
| Wheelbase (mm)        | 3800        |
| Displacement (L)      | 2,2         |
| Maximum power (kW-HP) | 103-140*    |
| Radio                 | on request  |

### DIMENSIONS AND WEIGHTS

|                                             |              |
|---------------------------------------------|--------------|
| Outside length (mm)                         | 6423         |
| Outside width - inside width (mm)           | 2340 - 2200  |
| Maximum outside height - inside height (mm) | 2940 - 2075  |
| Thickness of floor - walls - roof (mm)      | 56 - 30 - 30 |
| Certified seats                             | 6            |
| Maximum overall weight (kg)***              | 3500         |

### BEDS

|                                                 |           |
|-------------------------------------------------|-----------|
| Berths                                          | 2         |
| Optional berths                                 | 4         |
| Assemblable single bed                          | -         |
| centre dinette optional                         | -         |
| Assemblable double bed                          | 1290x1890 |
| centre dinette optional                         | -         |
| Assemblable double bed                          | -         |
| rear dinette optional                           | -         |
| Optional front drop-down bed                    | 1380x2000 |
| Drop-down bed maximum static load capacity (kg) | 250       |
| Rear single bed                                 | -         |
| Rear double bed                                 | 1385x2056 |
| Bunk bed                                        | -         |
| Rear drop-down double bed                       | -         |

### TANKS

|                            |                  |
|----------------------------|------------------|
| Drinking water (inside)*** | 20 + 65 l.       |
| Waste water tank           | 100 l.           |
| Antifreeze tank            | on request       |
| Gas bottle locker          | (1+1) x 11:13 kg |

### EQUIPMENT

|                                                 |                           |
|-------------------------------------------------|---------------------------|
| Gas heater                                      | Combi C4                  |
| Water heater                                    | Combi C4                  |
| Cabin swivel seats                              | ✓                         |
| Panoramic porthole living area                  | on request                |
| Openable panoramic porthole                     | on request                |
| low-profile models front pod                    | on request                |
| Fridge                                          | 89 l. (141 l. on request) |
| Nr. burners hob                                 | 3                         |
| Extractor hood                                  | on request                |
| Oven                                            | on request                |
| Garage (access door dimensions) H (mm) x W (mm) | 450x1000                  |
| Driver's cabin blackout blind                   | on request                |
| Entrance door with fly screen                   | on request                |
| TV-holder                                       | on request                |
| Roof rack with ladder                           | on request                |
| Service battery                                 | on request                |
| Cabin seat covers                               | on request                |
| Parking feet                                    | on request                |
| Bicycle rack                                    | on request                |
| Alarm system                                    | on request                |
| Outside entrance door lamp                      | on request                |

\*the Fiat Ducato 132 kW - 180 CV engine is available on request

\*\*also available with drop-down bed (OPT)

\*\*\*for legal information about the weights see page 133

**NEW**

**SARUS**  
66 PLUS

**FIAT**  
PROFESSIONAL



↔  
**7443x2340**

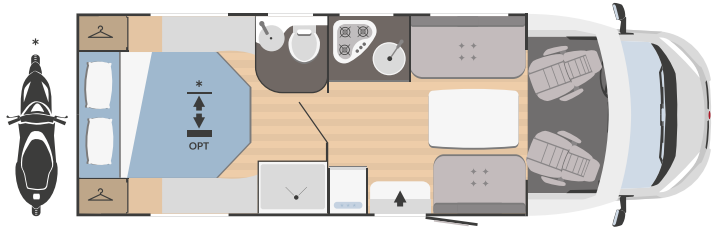

**4**



**4**



**750x770**  
(1200x770 opt)

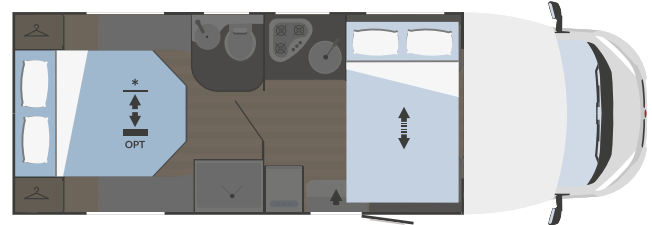

### MECHANICAL UNIT

|                       |             |
|-----------------------|-------------|
| Engine                | Fiat Ducato |
| Wheelbase (mm)        | 4035        |
| Displacement (L)      | 2,2         |
| Maximum power (kW-HP) | 103-140*    |
| Radio                 | on request  |

### DIMENSIONS AND WEIGHTS

|                                             |              |
|---------------------------------------------|--------------|
| Outside length (mm)                         | 7443         |
| Outside width - inside width (mm)           | 2340 - 2200  |
| Maximum outside height - inside height (mm) | 2940 - 2075  |
| Thickness of floor - walls - roof (mm)      | 56 - 30 - 30 |
| Certified seats                             | 4            |
| Maximum overall weight (kg)***              | 3500         |

### BEDS

|                                                 |            |
|-------------------------------------------------|------------|
| Berths                                          | 4          |
| Optional berths                                 | -          |
| Assemblable single bed                          | -          |
| centre dinette optional                         | -          |
| Assemblable double bed                          | -          |
| centre dinette optional                         | -          |
| Assemblable double bed                          | -          |
| rear dinette optional                           | -          |
| Front drop-down bed                             | 1220x2000  |
| Drop-down bed maximum static load capacity (kg) | 250        |
| Rear single bed                                 | -          |
| Rear double bed                                 | 1400x1900  |
| Bunk bed                                        | -          |
| Rear drop-down double bed                       | on request |

### TANKS

|                            |                  |
|----------------------------|------------------|
| Drinking water (inside)*** | 20 + 60 l.       |
| Waste water tank           | 100 l.           |
| Antifreeze tank            | on request       |
| Gas bottle locker          | (1+1) x 11:13 kg |

### EQUIPMENT

|                                                 |                    |
|-------------------------------------------------|--------------------|
| Gas heater                                      | Combi C4           |
| Water heater                                    | Combi C4           |
| Cabin swivel seats                              | ✓                  |
| Panoramic porthole living area                  | -                  |
| Openable panoramic porthole                     | on request         |
| low-profile models front pod                    | on request         |
| Fridge                                          | 141 l.             |
| Nr. burners hob                                 | 3                  |
| Extractor hood                                  | on request         |
| Oven                                            | on request         |
| Garage (access door dimensions) H (mm) x W (mm) | 750x770 (1200x770) |
| Driver's cabin blackout blind                   | on request         |
| Entrance door with fly screen                   | on request         |
| TV-holder                                       | on request         |
| Roof rack with ladder                           | on request         |
| Service battery                                 | on request         |
| Cabin seat covers                               | on request         |
| Parking feet                                    | on request         |
| Bicycle rack                                    | on request         |
| Alarm system                                    | on request         |
| Outside entrance door lamp                      | on request         |

\*the Fiat Ducato 132 kW - 180 CV engine is available on request

\*\*\*for legal information about the weights see page 133

**NEW**

**SARUS**  
67 PLUS

**FIAT**  
PROFESSIONAL



↔  
**6450x2340**

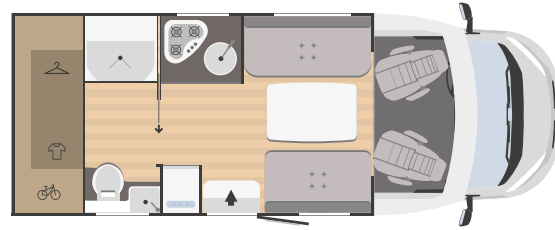

**4**



**4**  
(2 opt)



**1050x630**

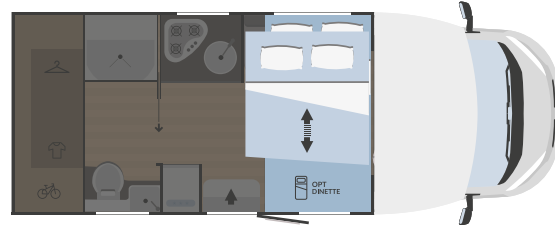

### MECHANICAL UNIT

|                       |             |
|-----------------------|-------------|
| Engine                | Fiat Ducato |
| Wheelbase (mm)        | 4035        |
| Displacement (L)      | 2,2         |
| Maximum power (kW-HP) | 103-140*    |
| Radio                 | on request  |

### DIMENSIONS AND WEIGHTS

|                                             |              |
|---------------------------------------------|--------------|
| Outside length (mm)                         | 6450         |
| Outside width - inside width (mm)           | 2340 - 2200  |
| Maximum outside height - inside height (mm) | 2940 - 2075  |
| Thickness of floor - walls - roof (mm)      | 56 - 30 - 30 |
| Certified seats                             | 4            |
| Maximum overall weight (kg)***              | 3500         |

### BEDS

|                                                 |           |
|-------------------------------------------------|-----------|
| Berths                                          | 2         |
| Optional berths                                 | 2         |
| Assemblable single bed centre dinette optional  | -         |
| Assemblable double bed centre dinette optional  | 1400x2200 |
| Assemblable double bed rear dinette optional    | -         |
| Front drop-down bed                             | 1370x2000 |
| Drop-down bed maximum static load capacity (kg) | 250       |
| Rear single bed                                 | -         |
| Rear double bed                                 | -         |
| Bunk bed                                        | -         |
| Rear drop-down double bed                       | -         |

### TANKS

|                            |                  |
|----------------------------|------------------|
| Drinking water (inside)*** | 20 + 60 l.       |
| Waste water tank           | 100 l.           |
| Antifreeze tank            | on request       |
| Gas bottle locker          | (1+1) x 11:13 kg |

### EQUIPMENT

|                                                          |            |
|----------------------------------------------------------|------------|
| Gas heater                                               | Combi C4   |
| Water heater                                             | Combi C4   |
| Cabin swivel seats                                       | ✓          |
| Panoramic porthole living area                           | -          |
| Openable panoramic porthole low-profile models front pod | on request |
| Fridge                                                   | 141 l.     |
| Nr. burners hob                                          | 3          |
| Extractor hood                                           | on request |
| Oven                                                     | on request |
| Garage (access door dimensions) H (mm) x W (mm)          | 1050x630   |
| Driver's cabin blackout blind                            | on request |
| Entrance door with fly screen                            | on request |
| TV-holder                                                | on request |
| Roof rack with ladder                                    | on request |
| Service battery                                          | on request |
| Cabin seat covers                                        | on request |
| Parking feet                                             | on request |
| Bicycle rack                                             | on request |
| Alarm system                                             | on request |
| Outside entrance door lamp                               | on request |

\*the Fiat Ducato 132 kW - 180 CV engine is available on request

\*\*\*for legal information about the weights see page 133

**NEW**

**SARUS**  
68 PLUS

**FIAT**  
PROFESSIONAL



↔  
**6973x2340**

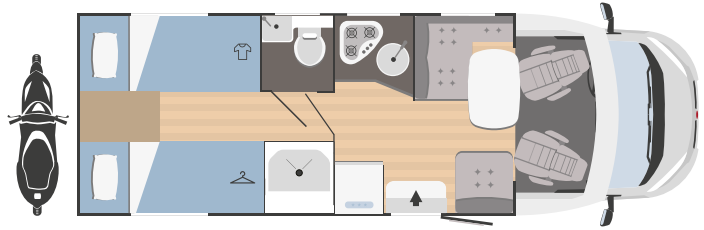

**5**



**5**  
(1 opt)



**750x750**

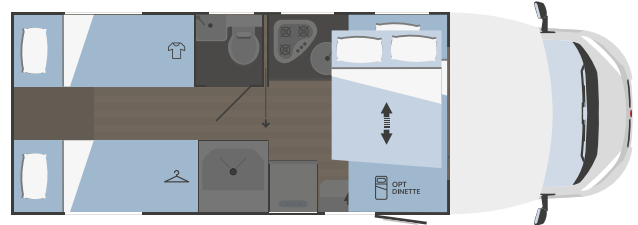

### MECHANICAL UNIT

|                       |             |
|-----------------------|-------------|
| Engine                | Fiat Ducato |
| Wheelbase (mm)        | 3800        |
| Displacement (L)      | 2,2         |
| Maximum power (kW-HP) | 103-140*    |
| Radio                 | on request  |

### DIMENSIONS AND WEIGHTS

|                                             |              |
|---------------------------------------------|--------------|
| Outside length (mm)                         | 6973         |
| Outside width - inside width (mm)           | 2340 - 2200  |
| Maximum outside height - inside height (mm) | 2940 - 2075  |
| Thickness of floor - walls - roof (mm)      | 56 - 30 - 30 |
| Certified seats                             | 5            |
| Maximum overall weight (kg)***              | 3500         |

### BEDS

|                                                 |           |
|-------------------------------------------------|-----------|
| Berths                                          | 4         |
| Optional berths                                 | 1         |
| Assemblable single bed centre dinette optional  | 1050x2200 |
| Assemblable double bed centre dinette optional  | -         |
| Assemblable double bed rear dinette optional    | -         |
| Front drop-down bed                             | 1220x2000 |
| Drop-down bed maximum static load capacity (kg) | 250       |
| Rear single bed                                 | -         |
| Rear double bed                                 | 1400x1880 |
| Bunk bed                                        | -         |
| Rear drop-down double bed                       | -         |

### TANKS

|                            |                  |
|----------------------------|------------------|
| Drinking water (inside)*** | 20 + 65 l.       |
| Waste water tank           | 100 l.           |
| Antifreeze tank            | on request       |
| Gas bottle locker          | (1+1) x 11:13 kg |

### EQUIPMENT

|                                                          |            |
|----------------------------------------------------------|------------|
| Gas heater                                               | Combi C4   |
| Water heater                                             | Combi C4   |
| Cabin swivel seats                                       | ✓          |
| Panoramic porthole living area                           | -          |
| Openable panoramic porthole low-profile models front pod | on request |
| Fridge                                                   | 141 l.     |
| Nr. burners hob                                          | 3          |
| Extractor hood                                           | on request |
| Oven                                                     | on request |
| Garage (access door dimensions) H (mm) x W (mm)          | 750x750    |
| Driver's cabin blackout blind                            | on request |
| Entrance door with fly screen                            | on request |
| TV-holder                                                | on request |
| Roof rack with ladder                                    | on request |
| Service battery                                          | on request |
| Cabin seat covers                                        | on request |
| Parking feet                                             | on request |
| Bicycle rack                                             | on request |
| Alarm system                                             | on request |
| Outside entrance door lamp                               | on request |

\*the Fiat Ducato 132 kW - 180 CV engine is available on request

\*\*\*for legal information about the weights see page 133

NEW

**SARUS**  
69 PLUS

**FIAT**  
PROFESSIONAL



↔  
**7158x2340**

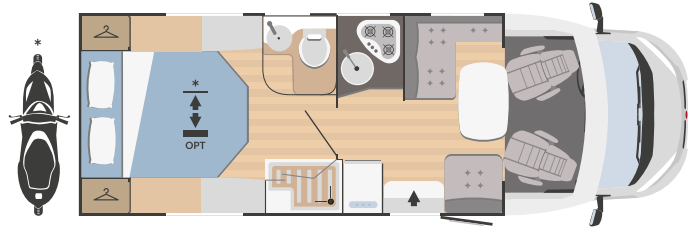

**5**



**5**  
(1 opt)



**750x750**  
(1200x750 opt)

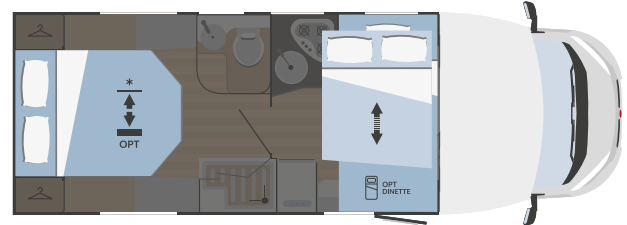

### MECHANICAL UNIT

|                       |             |
|-----------------------|-------------|
| Engine                | Fiat Ducato |
| Wheelbase (mm)        | 4035        |
| Displacement (L)      | 2,2         |
| Maximum power (kW-HP) | 103-140*    |
| Radio                 | on request  |

### DIMENSIONS AND WEIGHTS

|                                             |              |
|---------------------------------------------|--------------|
| Outside length (mm)                         | 7158         |
| Outside width - inside width (mm)           | 2340 - 2200  |
| Maximum outside height - inside height (mm) | 2940 - 2075  |
| Thickness of floor - walls - roof (mm)      | 56 - 30 - 30 |
| Certified seats                             | 5            |
| Maximum overall weight (kg)***              | 3500         |

### BEDS

|                                                 |            |
|-------------------------------------------------|------------|
| Berths                                          | 4          |
| Optional berths                                 | 1          |
| Assemblable single bed centre dinette optional  | 1100x2200  |
| Assemblable double bed centre dinette optional  | -          |
| Assemblable double bed rear dinette optional    | -          |
| Front drop-down bed                             | 1220x2000  |
| Drop-down bed maximum static load capacity (kg) | 250        |
| Rear single bed                                 | -          |
| Rear double bed                                 | 1400x1900  |
| Bunk bed                                        | -          |
| Rear drop-down double bed                       | on request |

### TANKS

|                            |                  |
|----------------------------|------------------|
| Drinking water (inside)*** | 20 + 60 l.       |
| Waste water tank           | 100 l.           |
| Antifreeze tank            | on request       |
| Gas bottle locker          | (1+1) x 11:13 kg |

### EQUIPMENT

|                                                          |                               |
|----------------------------------------------------------|-------------------------------|
| Gas heater                                               | Combi C4                      |
| Water heater                                             | Combi C4                      |
| Cabin swivel seats                                       | ✓                             |
| Panoramic porthole living area                           | -                             |
| Openable panoramic porthole low-profile models front pod | on request                    |
| Fridge                                                   | 141 l.                        |
| Nr. burners hob                                          | 3                             |
| Extractor hood                                           | on request                    |
| Oven                                                     | on request                    |
| Garage (access door dimensions) H (mm) x W (mm)          | 750x750 (1200x750 on request) |
| Driver's cabin blackout blind                            | on request                    |
| Entrance door with fly screen                            | on request                    |
| TV-holder                                                | on request                    |
| Roof rack with ladder                                    | on request                    |
| Service battery                                          | on request                    |
| Cabin seat covers                                        | on request                    |
| Parking feet                                             | on request                    |
| Bicycle rack                                             | on request                    |
| Alarm system                                             | on request                    |
| Outside entrance door lamp                               | on request                    |

\*the Fiat Ducato 132 kW - 180 CV engine is available on request

\*\*\*for legal information about the weights see page 133

**NEW**

**SARUS**  
95 PLUS

**FIAT**  
PROFESSIONAL



↔  
**7293x2340**

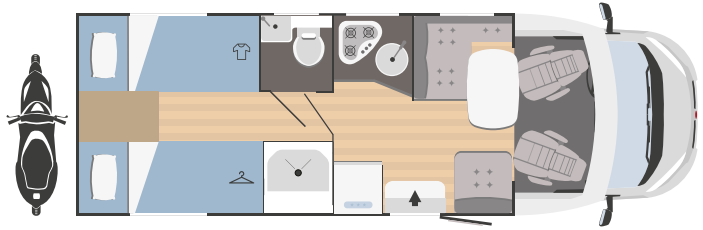

**4**  
(+1 opt)



**5**  
(1 opt)



**1050x750**

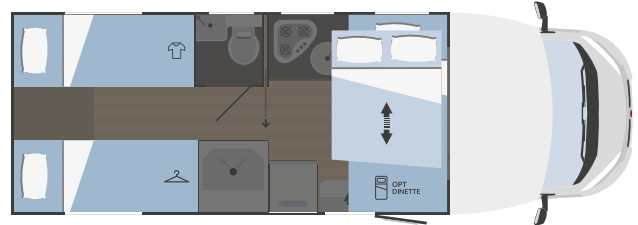

### MECHANICAL UNIT

|                       |             |
|-----------------------|-------------|
| Engine                | Fiat Ducato |
| Wheelbase (mm)        | 4035        |
| Displacement (L)      | 2,2         |
| Maximum power (kW-HP) | 103-140*    |
| Radio                 | on request  |

### DIMENSIONS AND WEIGHTS

|                                             |              |
|---------------------------------------------|--------------|
| Outside length (mm)                         | 7293         |
| Outside width - inside width (mm)           | 2340 - 2200  |
| Maximum outside height - inside height (mm) | 2940 - 2075  |
| Thickness of floor - walls - roof (mm)      | 56 - 30 - 30 |
| Certified seats                             | 4 (+1 opt)   |
| Maximum overall weight (kg)***              | 3500         |

### BEDS

|                                                 |               |
|-------------------------------------------------|---------------|
| Berths                                          | 4             |
| Optional berths                                 | 1             |
| Assemblable single bed centre dinette optional  | 1100x2200     |
| Assemblable double bed centre dinette optional  | -             |
| Assemblable double bed rear dinette optional    | -             |
| Front drop-down bed                             | 1220x2000     |
| Drop-down bed maximum static load capacity (kg) | 250           |
| Rear single bed                                 | n. 1 800x1975 |
| Rear double bed                                 | n.1 750x2040  |
| Rear double bed with extension:                 | 1900x2200     |
| Bunk bed                                        | -             |
| Rear drop-down double bed                       | -             |

### TANKS

|                            |                  |
|----------------------------|------------------|
| Drinking water (inside)*** | 20 + 65 l.       |
| Waste water tank           | 100 l.           |
| Antifreeze tank            | on request       |
| Gas bottle locker          | (1+1) x 11:13 kg |

### EQUIPMENT

|                                                          |                           |
|----------------------------------------------------------|---------------------------|
| Gas heater                                               | Combi C4                  |
| Water heater                                             | Combi C4                  |
| Cabin swivel seats                                       | ✓                         |
| Panoramic porthole living area                           | -                         |
| Openable panoramic porthole low-profile models front pod | on request                |
| Fridge                                                   | 89 l. (141 l. on request) |
| Nr. burners hob                                          | 3                         |
| Extractor hood                                           | on request                |
| Oven                                                     | on request                |
| Garage (access door dimensions) H (mm) x W (mm)          | 1050x750                  |
| Driver's cabin blackout blind                            | on request                |
| Entrance door with fly screen                            | on request                |
| TV-holder                                                | on request                |
| Roof rack with ladder                                    | on request                |
| Service battery                                          | on request                |
| Cabin seat covers                                        | on request                |
| Parking feet                                             | on request                |
| Bicycle rack                                             | on request                |
| Alarm system                                             | on request                |
| Outside entrance door lamp                               | on request                |

\*the Fiat Ducato 132 kW - 180 CV engine is available on request

\*\*\*for legal information about the weights see page 133

**NEW**

**SARUS\*\***  
98 P

**FIAT**  
PROFESSIONAL



↔  
**6878x2340**

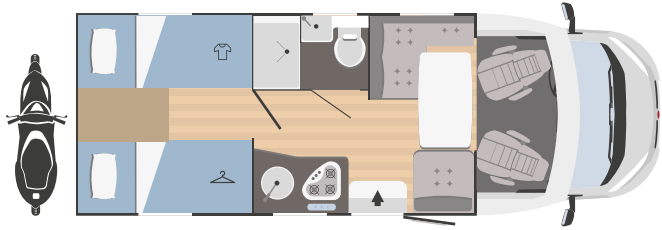

**5**



**5**  
(3 opt)



**1050x850**

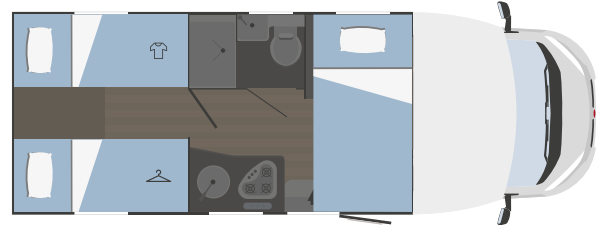

### MECHANICAL UNIT

|                       |             |
|-----------------------|-------------|
| Engine                | Fiat Ducato |
| Wheelbase (mm)        | 3800        |
| Displacement (L)      | 2,2         |
| Maximum power (kW-HP) | 103-140*    |
| Radio                 | on request  |

### DIMENSIONS AND WEIGHTS

|                                             |              |
|---------------------------------------------|--------------|
| Outside length (mm)                         | 6878         |
| Outside width - inside width (mm)           | 2340 - 2200  |
| Maximum outside height - inside height (mm) | 2940 - 2075  |
| Thickness of floor - walls - roof (mm)      | 56 - 30 - 30 |
| Certified seats                             | 5            |
| Maximum overall weight (kg)***              | 3500         |

### BEDS

|                                                 |              |
|-------------------------------------------------|--------------|
| Berths                                          | 2            |
| Optional berths                                 | 3            |
| Assemblable single bed centre dinette optional  | 1170x2200    |
| Assemblable double bed centre dinette optional  | -            |
| Assemblable double bed rear dinette optional    | -            |
| Optional front drop-down bed                    | 1300x2000    |
| Drop-down bed maximum static load capacity (kg) | 250          |
| Rear single bed                                 | n.2 750x1930 |
| Rear double bed with extension:                 | 1500x2200    |
| Bunk bed                                        | -            |
| Rear drop-down double bed                       | -            |

### TANKS

|                            |                  |
|----------------------------|------------------|
| Drinking water (inside)*** | 20 + 65 l.       |
| Waste water tank           | 100 l.           |
| Antifreeze tank            | on request       |
| Gas bottle locker          | (1+1) x 11:13 kg |

### EQUIPMENT

|                                                          |            |
|----------------------------------------------------------|------------|
| Gas heater                                               | Combi C4   |
| Water heater                                             | Combi C4   |
| Cabin swivel seats                                       | ✓          |
| Panoramic porthole living area                           | -          |
| Openable panoramic porthole low-profile models front pod | on request |
| Fridge                                                   | 89 l.      |
| Nr. burners hob                                          | 3          |
| Extractor hood                                           | on request |
| Oven                                                     | -          |
| Garage (access door dimensions) H (mm) x W (mm)          | 1050x850   |
| Driver's cabin blackout blind                            | on request |
| Entrance door with fly screen                            | on request |
| TV-holder                                                | on request |
| Roof rack with ladder                                    | on request |
| Service battery                                          | on request |
| Cabin seat covers                                        | on request |
| Parking feet                                             | on request |
| Bicycle rack                                             | on request |
| Alarm system                                             | on request |
| Outside entrance door lamp                               | on request |

\*the Fiat Ducato 132 kW - 180 CV engine is available on request

\*\*also available with drop-down bed (OPT)

\*\*\*for legal information about the weights see page 133



**NEW**

**SARUS**  
99 PLUS

**FIAT**  
PROFESSIONAL



↔  
**7443x2340**

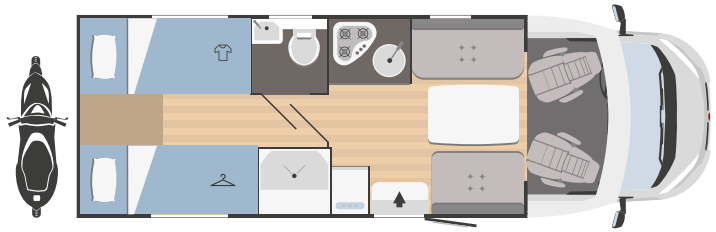

**4**



**4**



**1050x750**

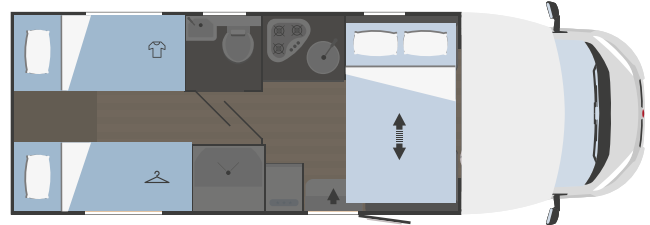

### MECHANICAL UNIT

|                       |             |
|-----------------------|-------------|
| Engine                | Fiat Ducato |
| Wheelbase (mm)        | 4035        |
| Displacement (L)      | 2,2         |
| Maximum power (kW-HP) | 103-140*    |
| Radio                 | on request  |

### DIMENSIONS AND WEIGHTS

|                                             |              |
|---------------------------------------------|--------------|
| Outside length (mm)                         | 7443         |
| Outside width - inside width (mm)           | 2340 - 2200  |
| Maximum outside height - inside height (mm) | 2940 - 2075  |
| Thickness of floor - walls - roof (mm)      | 56 - 30 - 30 |
| Certified seats                             | 4            |
| Maximum overall weight (kg)***              | 3500         |

### BEDS

|                                                 |                           |
|-------------------------------------------------|---------------------------|
| Berths                                          | 4                         |
| Optional berths                                 | -                         |
| Assemblable single bed                          | -                         |
| centre dinette optional                         | -                         |
| Assemblable double bed                          | -                         |
| centre dinette optional                         | -                         |
| Assemblable double bed                          | -                         |
| rear dinette optional                           | -                         |
| Front drop-down bed                             | 1220x2000                 |
| Drop-down bed maximum static load capacity (kg) | 250                       |
| Rear single bed                                 | n. 1 800x1900             |
|                                                 | n.1 750x1980              |
| Rear double bed                                 | with extension: 1900x2200 |
| Bunk bed                                        | -                         |
| Rear drop-down double bed                       | -                         |

### TANKS

|                            |                  |
|----------------------------|------------------|
| Drinking water (inside)*** | 20 + 60 l.       |
| Waste water tank           | 100 l.           |
| Antifreeze tank            | on request       |
| Gas bottle locker          | (1+1) x 11:13 kg |

### EQUIPMENT

|                                                 |            |
|-------------------------------------------------|------------|
| Gas heater                                      | Combi C4   |
| Water heater                                    | Combi C4   |
| Cabin swivel seats                              | ✓          |
| Panoramic porthole living area                  | -          |
| Openable panoramic porthole                     | on request |
| low-profile models front pod                    | on request |
| Fridge                                          | 141 l.     |
| Nr. burners hob                                 | 3          |
| Extractor hood                                  | on request |
| Oven                                            | on request |
| Garage (access door dimensions) H (mm) x W (mm) | 1050x750   |
| Driver's cabin blackout blind                   | on request |
| Entrance door with fly screen                   | on request |
| TV-holder                                       | on request |
| Roof rack with ladder                           | on request |
| Service battery                                 | on request |
| Cabin seat covers                               | on request |
| Parking feet                                    | on request |
| Bicycle rack                                    | on request |
| Alarm system                                    | on request |
| Outside entrance door lamp                      | on request |

\*the Fiat Ducato 132 kW - 180 CV engine is available on request

\*\*\*for legal information about the weights see page 133



# The great flagship vehicle in its best ever version

## Unrivalled liveability and a feeling of luxury in true nautical style

The feeling of travelling in the luxury of a ship, the comfort of doing it on the road. All this is possible with Super Brig, the Rimor flagship vehicle created by the founder, Luano Niccolai. Even more so today, thanks to the new 87 Plus and 687 TC versions, with maximised liveability even in under 7 metres (6.8 m). Super Brig offers top of the range fittings, with 6 models between low-profile and overcab, top quality materials and spacious living areas.

No need for compromise with sleeping solutions for full living comfort: double, transverse, suite and twin beds that can be converted into king size, as well as a front drop-down bed as standard in the low-profile models and a new bathroom for the 69 Plus model. The equipment includes adjustable headrests, 153-litre refrigerator column and pull-out mixer tap for the kitchen sink, deluxe upholstery and an opening XL panoramic window in the overcab. The Suite model, with double dinette, has a spacious kitchen with combi-oven with grill and hob for the ultimate en plein air experience.



## Super Brig

Engine  
Fiat Ducato

Displacement  
2,2L



from 6838  
to 7293 mm



from 6838  
to 7293 mm





**Your new  
camper life  
starts with this**



- 1 **Combi-oven with grill and hob** on the Suite model
- 2 **Pull-out kitchen sink mixer tap**

- 3 **153 L refrigerator column** which can be opened from both sides (except in Super Brig 69 Plus)
- 4 **Cleverly-designed kitchen** with integrated double-level drawer

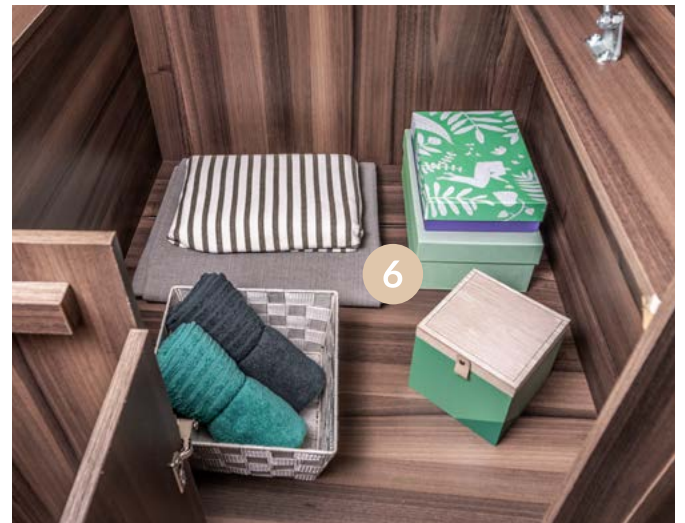

**5** Wardrobes for hanging garments (except in the 95 Plus and 695 models)

**6** Twin beds with pneumatic slatted bases and storage compartments on 95 Plus and 695 models

**7** Bright overcab with deluxe lining



**8** New top of the range equipment, with internal frame and practical sliding blind with integrated fly-screen

**9** New rear bumpers

- Combi C6 Gas heating with CP Plus digital control unit as standard
- Front drop-down bed as standard on all low-profile models
- Interior height underneath the drop-down bed 200 cm
- Overcab bed with pneumatic slatted bases
- USB outlets in both living and sleeping areas
- 3-burner cooker hob
- Cabinets with damper hinges

## Living area



### L-shaped dinette

SUPER BRIG 687 TC  
SUPER BRIG 695 TC

### Double dinette

SUPER BRIG SUITE



### L-shaped dinette

SUPER BRIG 69 PLUS  
SUPER BRIG 87 PLUS  
SUPER BRIG 95 PLUS







L-shaped dinette





Twin beds

## Sleeping area



Transverse bed  
SUPER BRIG 687 TC

Twin beds  
SUPER BRIG 695 TC

Rear suite bed  
SUPER BRIG SUITE



Rear suite bed





Transverse bed

## Sleeping area



Central bed  
SUPER BRIG 69 PLUS

Transverse bed  
SUPER BRIG 87 PLUS

Twin beds  
SUPER BRIG 95 PLUS

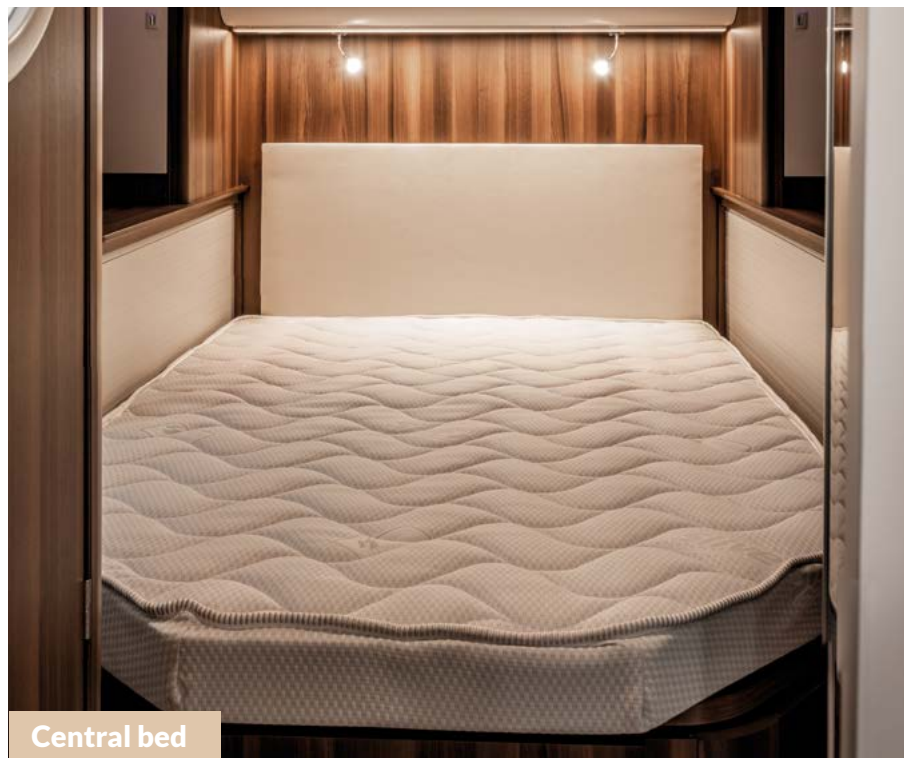

Central bed



## Kitchen



Compact kitchen  
SUPER BRIG 695

Long kitchen  
SUPER BRIG 687 TC

Combined kitchen  
SUPER BRIG SUITE



Compact kitchen



Combined kitchen





Long kitchen

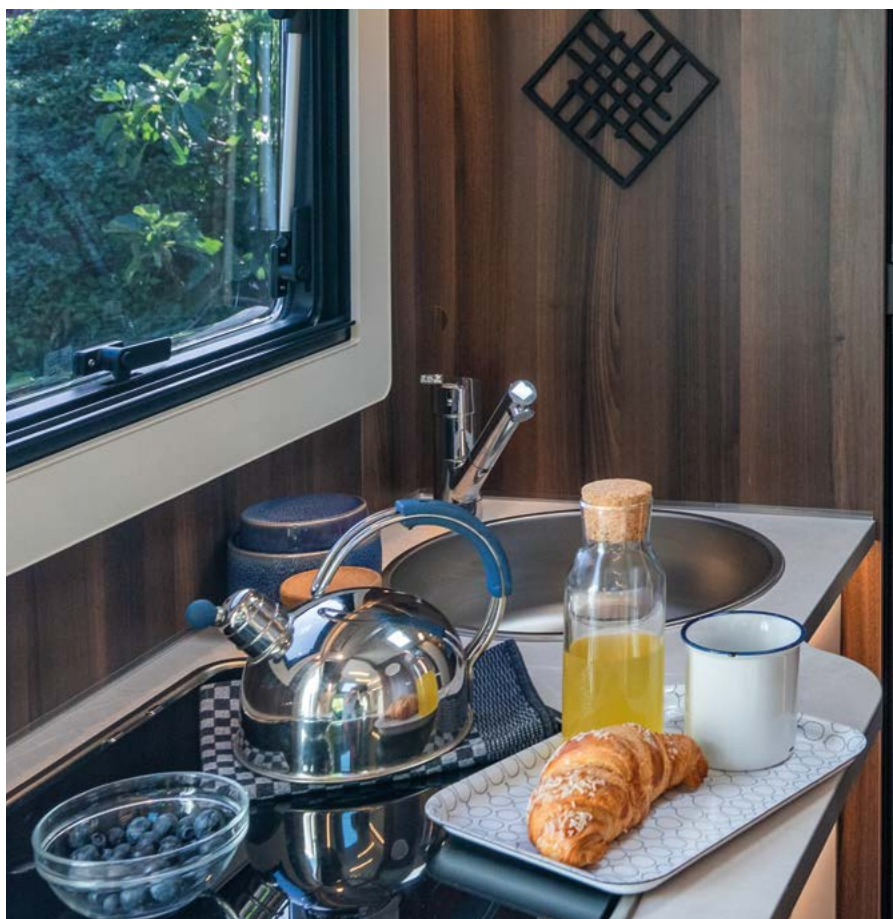

## Kitchen



### Compact kitchen

SUPER BRIG 69 PLUS  
SUPER BRIG 95 PLUS

### Long kitchen

SUPER BRIG 87 PLUS

## Bathroom



Single unit with  
shower alongside  
toilet

SUPER BRIG 687 TC  
SUPER BRIG SUITE

Separate toilet and  
shower cubicle

SUPER BRIG 695



Single unit with  
shower alongside  
toilet

SUPER BRIG 87 PLUS

Flush-mounted  
shower tray and  
separate toilet with  
modular doors

SUPER BRIG 69 PLUS

Separate toilet and  
shower cubicle

SUPER BRIG 95 PLUS

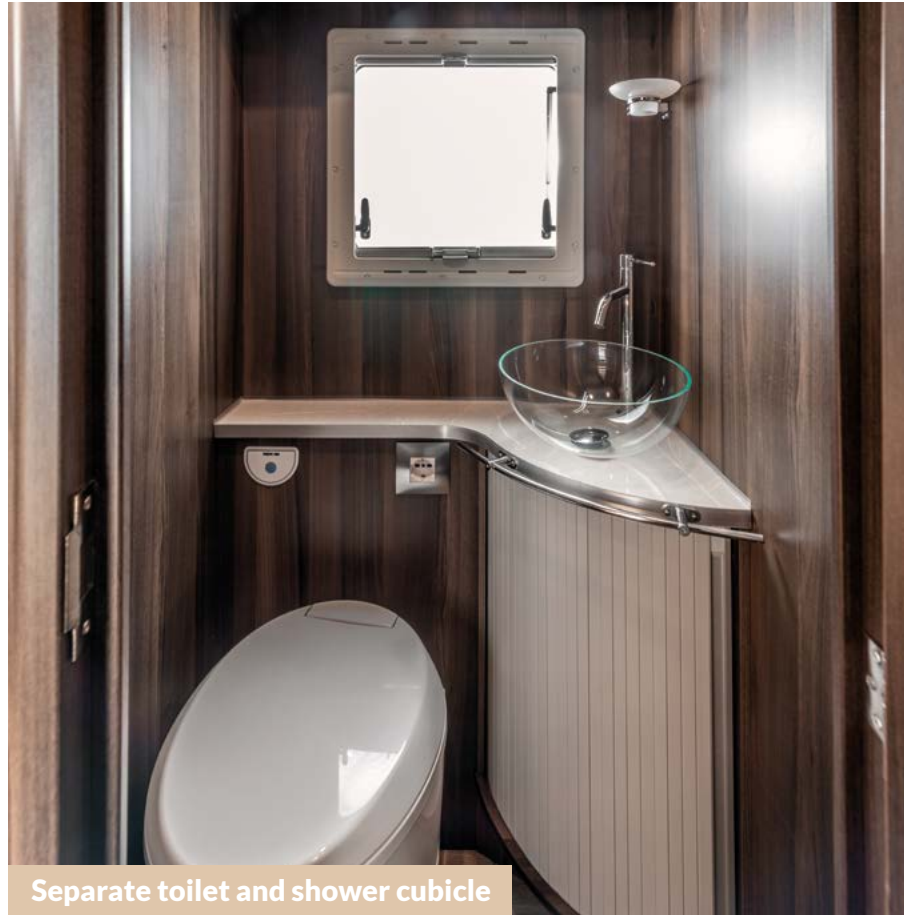

Separate toilet and shower cubicle

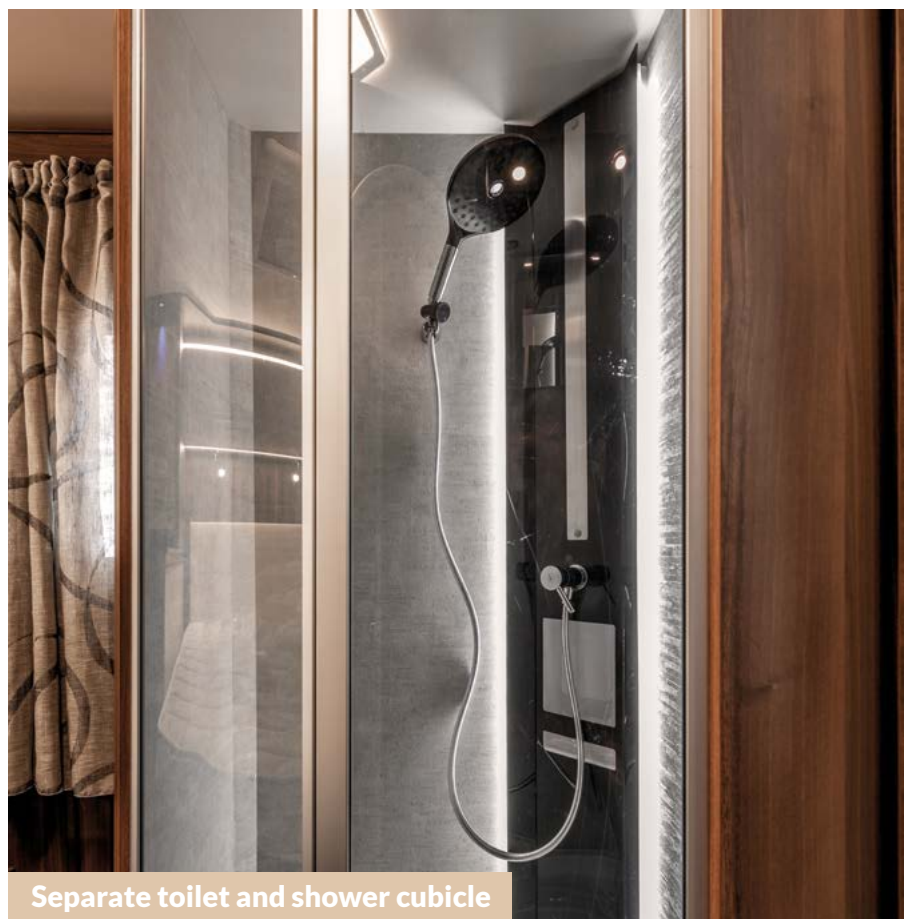

Separate toilet and shower cubicle





Flush-mounted shower tray and separate toilet with modular doors



Single unit with shower alongside toilet

## Models and layouts

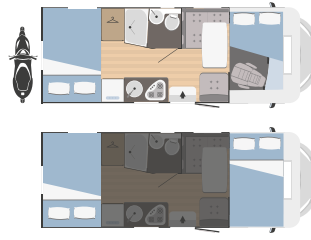

| SUPER BRIG 687 TC                                    |                            |
|------------------------------------------------------|----------------------------|
| ↔ Outside length x width (mm)                        | 6838x2340                  |
| 👤 Certified seats                                    | 4                          |
| 🛏 Berths                                             | 4                          |
| 🚪 Garage (access door dimensions)<br>H (mm) x W (mm) | 1280x850<br>(1080x850 opt) |

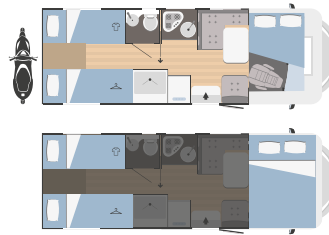

| SUPER BRIG 695 TC                                    |           |
|------------------------------------------------------|-----------|
| ↔ Outside length x width (mm)                        | 7293x2340 |
| 👤 Certified seats                                    | 4         |
| 🛏 Berths                                             | 4         |
| 🚪 Garage (access door dimensions)<br>H (mm) x W (mm) | 1050x750  |



| SUPER BRIG SUITE                                     |           |
|------------------------------------------------------|-----------|
| ↔ Outside length x width (mm)                        | 7093x2340 |
| 👤 Certified seats                                    | 4         |
| 🛏 Berths                                             | 4         |
| 🚪 Garage (access door dimensions)<br>H (mm) x W (mm) | 470x700   |

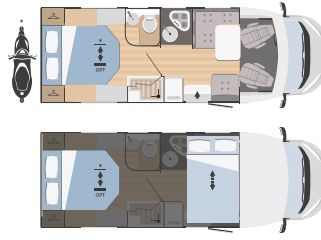

| SUPER BRIG 69 PLUS                                   |                           |
|------------------------------------------------------|---------------------------|
| ↔ Outside length x width (mm)                        | 7158x2340                 |
| 👤 Certified seats                                    | 4                         |
| 🛏 Berths                                             | 4                         |
| 🚪 Garage (access door dimensions)<br>H (mm) x W (mm) | 750x750<br>(1200x750 opt) |



| SUPER BRIG 87 PLUS                                   |                            |
|------------------------------------------------------|----------------------------|
| ↔ Outside length x width (mm)                        | 6838x2340                  |
| 👤 Certified seats                                    | 4                          |
| 🛏 Berths                                             | 4                          |
| 🚪 Garage (access door dimensions)<br>H (mm) x W (mm) | 1280x850<br>(1080x850 opt) |

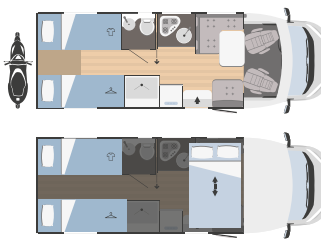

| SUPER BRIG 95 PLUS                                   |           |
|------------------------------------------------------|-----------|
| ↔ Outside length x width (mm)                        | 7293x2340 |
| 👤 Certified seats                                    | 4         |
| 🛏 Berths                                             | 4         |
| 🚪 Garage (access door dimensions)<br>H (mm) x W (mm) | 1050x750  |



 **SUPER BRIG**  
Technical data

# SUPER BRIG

## 687 TC

FIAT  
PROFESSIONAL



↔  
**6838x2340**



4



4



**1280x850**  
(1080x850 opt)

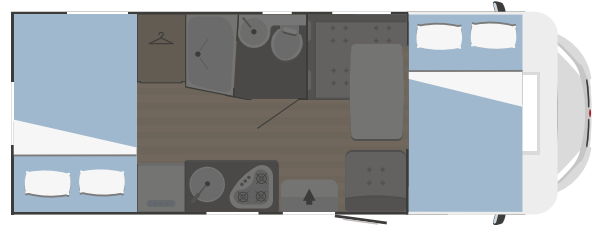

### MECHANICAL UNIT

|                       |             |
|-----------------------|-------------|
| Engine                | Fiat Ducato |
| Wheelbase (mm)        | 3800        |
| Displacement (L)      | 2,2         |
| Maximum power (kW-HP) | 103-140*    |
| Radio                 | on request  |

### DIMENSIONS AND WEIGHTS

|                                             |              |
|---------------------------------------------|--------------|
| Outside length (mm)                         | 6838         |
| Outside width - inside width (mm)           | 2340 - 2200  |
| Maximum outside height - inside height (mm) | 3050 - 2075  |
| Thickness of floor - walls - roof (mm)      | 56 - 30 - 30 |
| Certified seats                             | 4            |
| Maximum overall weight (kg)***              | 3500         |

### BEDS

|                                       |            |
|---------------------------------------|------------|
| Berths                                | 4          |
| Assemblable berths                    | -          |
| Overcab double bed                    | 1400x2200  |
| Assemblable single bed centre dinette | -          |
| Assemblable double bed centre dinette | -          |
| Assemblable double bed rear dinette   | -          |
| Rear single bed                       | -          |
| Rear double bed                       | 1356x2200  |
| Bunk bed                              | -          |
| Rear drop-down double bed             | on request |

### TANKS

|                            |                  |
|----------------------------|------------------|
| Drinking water (inside)*** | 20 + 65 l.       |
| Waste water tank           | 100 l.           |
| Antifreeze tank            | ✓                |
| Gas bottle locker          | (1+1) x 11:13 kg |

### EQUIPMENT

|                                                          |                                    |
|----------------------------------------------------------|------------------------------------|
| Gas heater                                               | Combi C6                           |
| Water heater                                             | Combi C6                           |
| Cabin swivel seats                                       | ✓                                  |
| Panoramic porthole living area                           | ✓                                  |
| Openable panoramic porthole low-profile models front pod | -                                  |
| Fridge                                                   | 153 l.                             |
| Nr. burners hob                                          | 3                                  |
| Extractor hood                                           | ✓                                  |
| Oven                                                     | on request                         |
| Garage (access door dimensions) H (mm) x W (mm)          | 1280 x 850 (1080 x 850 on request) |
| Driver's cabin blackout blind                            | on request                         |
| Entrance door with fly screen                            | ✓                                  |
| TV-holder                                                | ✓                                  |
| Roof rack with ladder                                    | on request                         |
| Service battery                                          | on request                         |
| Cabin seat covers                                        | ✓                                  |
| Parking feet                                             | ✓                                  |
| Bicycle rack                                             | on request                         |
| Alarm system                                             | on request                         |
| Outside entrance door lamp                               | ✓                                  |

\*the Fiat Ducato 132 kW - 180 CV engine is available on request

\*\*\*for legal information about the weights see page 133

# SUPER BRIG

## 695 TC

FIAT  
PROFESSIONAL



7293x2340

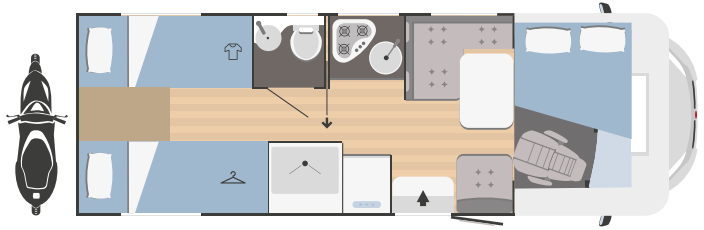

4



4



1050x750

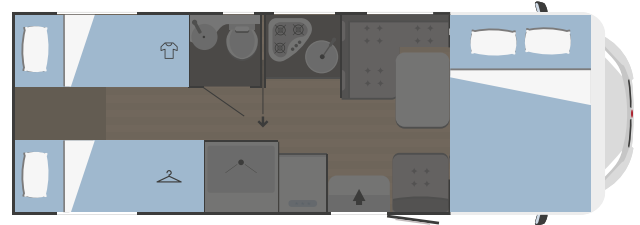

### MECHANICAL UNIT

|                       |             |
|-----------------------|-------------|
| Engine                | Fiat Ducato |
| Wheelbase (mm)        | 4035        |
| Displacement (L)      | 2,2         |
| Maximum power (kW-HP) | 103-140*    |
| Radio                 | on request  |

### DIMENSIONS AND WEIGHTS

|                                             |              |
|---------------------------------------------|--------------|
| Outside length (mm)                         | 7293         |
| Outside width - inside width (mm)           | 2340 - 2200  |
| Maximum outside height - inside height (mm) | 3050 - 2075  |
| Thickness of floor - walls - roof (mm)      | 56 - 30 - 30 |
| Certified seats                             | 4            |
| Maximum overall weight (kg)***              | 3500         |

### BEDS

|                                       |                                |
|---------------------------------------|--------------------------------|
| Berths                                | 4                              |
| Assemblable berths                    | -                              |
| Overcab double bed                    | 1400x2200                      |
| Assemblable single bed centre dinette | -                              |
| Assemblable double bed centre dinette | -                              |
| Assemblable double bed rear dinette   | -                              |
| Rear single bed                       | n. 1 800x1975<br>n. 1 750x2040 |
| Rear double bed                       | with extension: 1400x2200      |
| Bunk bed                              | -                              |
| Rear drop-down double bed             | -                              |

### TANKS

|                            |                  |
|----------------------------|------------------|
| Drinking water (inside)*** | 20 + 65 l.       |
| Waste water tank           | 100 l.           |
| Antifreeze tank            | ✓                |
| Gas bottle locker          | (1+1) x 11:13 kg |

### EQUIPMENT

|                                                          |            |
|----------------------------------------------------------|------------|
| Gas heater                                               | Combi C6   |
| Water heater                                             | Combi C6   |
| Cabin swivel seats                                       | ✓          |
| Panoramic porthole living area                           | ✓          |
| Openable panoramic porthole low-profile models front pod | -          |
| Fridge                                                   | 153 l.     |
| Nr. burners hob                                          | 3          |
| Extractor hood                                           | ✓          |
| Oven                                                     | on request |
| Garage (access door dimensions) H (mm) x W (mm)          | 1050x750   |
| Driver's cabin blackout blind                            | on request |
| Entrance door with fly screen                            | ✓          |
| TV-holder                                                | ✓          |
| Roof rack with ladder                                    | on request |
| Service battery                                          | on request |
| Cabin seat covers                                        | ✓          |
| Parking feet                                             | ✓          |
| Bicycle rack                                             | on request |
| Alarm system                                             | on request |
| Outside entrance door lamp                               | ✓          |

\*the Fiat Ducato 132 kW - 180 CV engine is available on request

\*\*\*for legal information about the weights see page 133

# SUPER BRIG SUITE

FIAT  
PROFESSIONAL



7093x2340



4



4



470x700

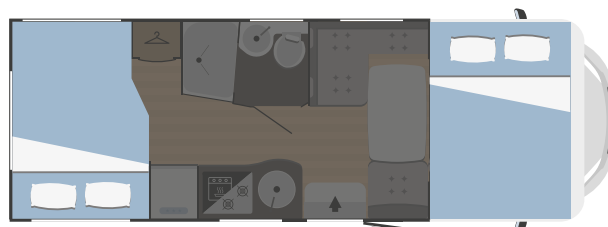
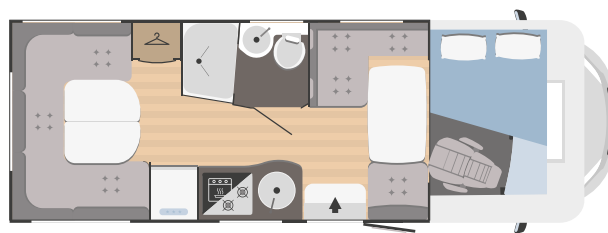

## MECHANICAL UNIT

|                       |             |
|-----------------------|-------------|
| Engine                | Fiat Ducato |
| Wheelbase (mm)        | 3800        |
| Displacement (L)      | 2,2         |
| Maximum power (kW-HP) | 103-140*    |
| Radio                 | on request  |

## DIMENSIONS AND WEIGHTS

|                                             |              |
|---------------------------------------------|--------------|
| Outside length (mm)                         | 7093         |
| Outside width - inside width (mm)           | 2340 - 2200  |
| Maximum outside height - inside height (mm) | 3050 - 2075  |
| Thickness of floor - walls - roof (mm)      | 56 - 30 - 30 |
| Certified seats                             | 4            |
| Maximum overall weight (kg)***              | 3500         |

## BEDS

|                                       |           |
|---------------------------------------|-----------|
| Berths                                | 4         |
| Assemblable berths                    | 2         |
| Overcab double bed                    | 1400x2200 |
| Assemblable single bed centre dinette | -         |
| Assemblable double bed centre dinette | -         |
| Assemblable double bed rear dinette   | 1475x2200 |
| Rear single bed                       | -         |
| Rear double bed                       | -         |
| Bunk bed                              | -         |
| Rear drop-down double bed             | -         |

## TANKS

|                            |                  |
|----------------------------|------------------|
| Drinking water (inside)*** | 20 + 65 l.       |
| Waste water tank           | 100 l.           |
| Antifreeze tank            | ✓                |
| Gas bottle locker          | (1+1) x 11:13 kg |

## EQUIPMENT

|                                                          |            |
|----------------------------------------------------------|------------|
| Gas heater                                               | Combi C6   |
| Water heater                                             | Combi C6   |
| Cabin swivel seats                                       | ✓          |
| Panoramic porthole living area                           | ✓          |
| Openable panoramic porthole low-profile models front pod | -          |
| Fridge                                                   | 153 l.     |
| Nr. burners hob                                          | 3          |
| Extractor hood                                           | ✓          |
| Oven                                                     | ✓          |
| Garage (access door dimensions) H (mm) x W (mm)          | 470x700    |
| Driver's cabin blackout blind                            | on request |
| Entrance door with fly screen                            | ✓          |
| TV-holder                                                | ✓          |
| Roof rack with ladder                                    | on request |
| Service battery                                          | on request |
| Cabin seat covers                                        | ✓          |
| Parking feet                                             | ✓          |
| Bicycle rack                                             | on request |
| Alarm system                                             | on request |
| Outside entrance door lamp                               | ✓          |

\*the Fiat Ducato 132 kW - 180 CV engine is available on request

\*\*\*for legal information about the weights see page 133

# SUPER BRIG

## 69 PLUS

FIAT  
PROFESSIONAL



↔  
**7158x2340**

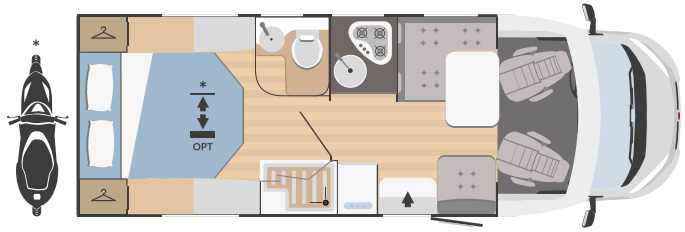

4



4



**750x750**  
(1200x750 opt)

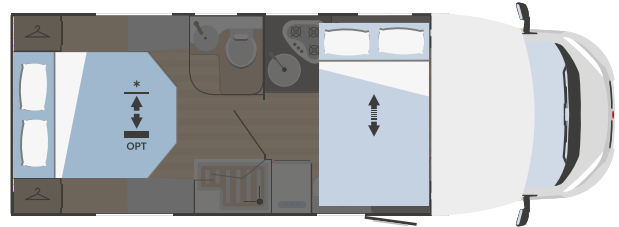

### MECHANICAL UNIT

|                       |             |
|-----------------------|-------------|
| Engine                | Fiat Ducato |
| Wheelbase (mm)        | 4035        |
| Displacement (L)      | 2,2         |
| Maximum power (kW-HP) | 103-140*    |
| Radio                 | on request  |

### DIMENSIONS AND WEIGHTS

|                                             |              |
|---------------------------------------------|--------------|
| Outside length (mm)                         | 7158         |
| Outside width - inside width (mm)           | 2340 - 2200  |
| Maximum outside height - inside height (mm) | 3000 - 2075  |
| Thickness of floor - walls - roof (mm)      | 56 - 30 - 30 |
| Certified seats                             | 4            |
| Maximum overall weight (kg)***              | 3500         |

### BEDS

|                                                 |            |
|-------------------------------------------------|------------|
| Berths                                          | 4          |
| Assemblable berths                              | -          |
| Assemblable single bed centre dinette           | -          |
| Assemblable double bed centre dinette           | -          |
| Assemblable double bed rear dinette             | -          |
| Front drop-down bed                             | 1220x2200  |
| Drop-down bed maximum static load capacity (kg) | 250        |
| Rear single bed                                 | -          |
| Rear double bed                                 | 1400x1900  |
| Bunk bed                                        | -          |
| Rear drop-down double bed                       | on request |

### TANKS

|                            |                  |
|----------------------------|------------------|
| Drinking water (inside)*** | 20 + 65 l.       |
| Waste water tank           | 100 l.           |
| Antifreeze tank            | ✓                |
| Gas bottle locker          | (1+1) x 11:13 kg |

### EQUIPMENT

|                                                          |                               |
|----------------------------------------------------------|-------------------------------|
| Gas heater                                               | Combi C6                      |
| Water heater                                             | Combi C6                      |
| Cabin swivel seats                                       | ✓                             |
| Panoramic porthole living area                           | -                             |
| Openable panoramic porthole low-profile models front pod | ✓                             |
| Fridge                                                   | 141 l.                        |
| Nr. burners hob                                          | 3                             |
| Extractor hood                                           | ✓                             |
| Oven                                                     | on request                    |
| Garage (access door dimensions) H (mm) x W (mm)          | 750x750 (1200x750 on request) |
| Driver's cabin blackout blind                            | on request                    |
| Entrance door with fly screen                            | ✓                             |
| TV-holder                                                | ✓                             |
| Roof rack with ladder                                    | on request                    |
| Service battery                                          | on request                    |
| Cabin seat covers                                        | ✓                             |
| Parking feet                                             | ✓                             |
| Bicycle rack                                             | on request                    |
| Alarm system                                             | on request                    |
| Outside entrance door lamp                               | ✓                             |

\*the Fiat Ducato 132 kW - 180 CV engine is available on request

\*\*\*for legal information about the weights see page 133



# SUPER BRIG

## 87 PLUS

FIAT  
PROFESSIONAL



↔  
**6838x2340**

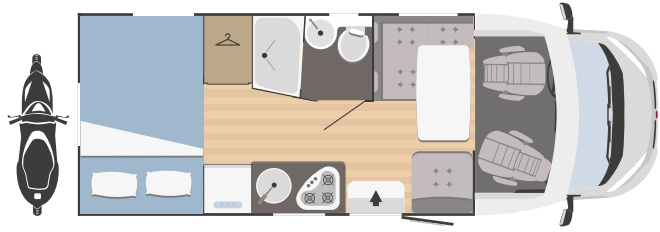

4



4



**1280x850**  
(1080x850 opt)

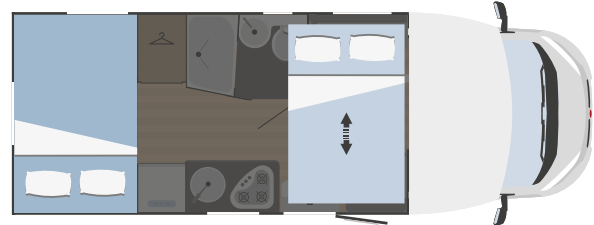

### MECHANICAL UNIT

|                       |             |
|-----------------------|-------------|
| Engine                | Fiat Ducato |
| Wheelbase (mm)        | 3800        |
| Displacement (L)      | 2,2         |
| Maximum power (kW-HP) | 103-140*    |
| Radio                 | on request  |

### DIMENSIONS AND WEIGHTS

|                                             |              |
|---------------------------------------------|--------------|
| Outside length (mm)                         | 6838         |
| Outside width - inside width (mm)           | 2340 - 2200  |
| Maximum outside height - inside height (mm) | 3000 - 2075  |
| Thickness of floor - walls - roof (mm)      | 56 - 30 - 30 |
| Certified seats                             | 4            |
| Maximum overall weight (kg)***              | 3500         |

### BEDS

|                                                 |            |
|-------------------------------------------------|------------|
| Berths                                          | 4          |
| Assemblable berths                              | -          |
| Assemblable single bed centre dinette           | -          |
| Assemblable double bed centre dinette           | -          |
| Assemblable double bed rear dinette             | -          |
| Front drop-down bed                             | 1280x2200  |
| Drop-down bed maximum static load capacity (kg) | 250        |
| Rear single bed                                 | -          |
| Rear double bed                                 | 1356x2200  |
| Bunk bed                                        | -          |
| Rear drop-down double bed                       | on request |

### TANKS

|                            |                  |
|----------------------------|------------------|
| Drinking water (inside)*** | 20 + 65 l.       |
| Waste water tank           | 100 l.           |
| Antifreeze tank            | ✓                |
| Gas bottle locker          | (1+1) x 11:13 kg |

### EQUIPMENT

|                                                          |                                |
|----------------------------------------------------------|--------------------------------|
| Gas heater                                               | Combi C6                       |
| Water heater                                             | Combi C6                       |
| Cabin swivel seats                                       | ✓                              |
| Panoramic porthole living area                           | -                              |
| Openable panoramic porthole low-profile models front pod | ✓                              |
| Fridge                                                   | 153 l.                         |
| Nr. burners hob                                          | 3                              |
| Extractor hood                                           | ✓                              |
| Oven                                                     | on request                     |
| Garage (access door dimensions) H (mm) x W (mm)          | 1280x850 (1080x850 on request) |
| Driver's cabin blackout blind                            | on request                     |
| Entrance door with fly screen                            | ✓                              |
| TV-holder                                                | ✓                              |
| Roof rack with ladder                                    | on request                     |
| Service battery                                          | on request                     |
| Cabin seat covers                                        | ✓                              |
| Parking feet                                             | ✓                              |
| Bicycle rack                                             | on request                     |
| Alarm system                                             | on request                     |
| Outside entrance door lamp                               | ✓                              |

\*the Fiat Ducato 132 kW - 180 CV engine is available on request

\*\*\*for legal information about the weights see page 133

# SUPER BRIG

## 95 PLUS



7293x2340



4



4



1050x750

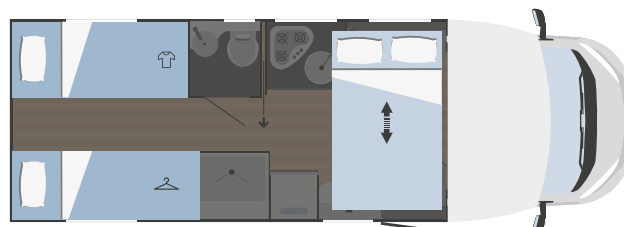
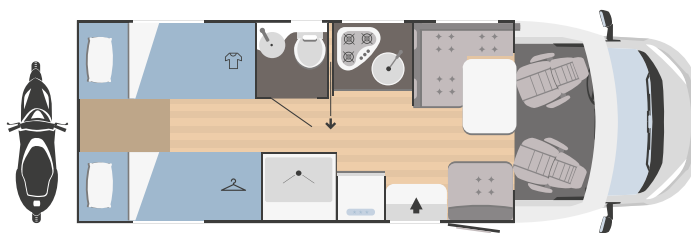

### MECHANICAL UNIT

|                       |             |
|-----------------------|-------------|
| Engine                | Fiat Ducato |
| Wheelbase (mm)        | 4035        |
| Displacement (L)      | 2,2         |
| Maximum power (kW-HP) | 103-140*    |
| Radio                 | on request  |

### DIMENSIONS AND WEIGHTS

|                                             |              |
|---------------------------------------------|--------------|
| Outside length (mm)                         | 7293         |
| Outside width - inside width (mm)           | 2340 - 2200  |
| Maximum outside height - inside height (mm) | 3000 - 2075  |
| Thickness of floor - walls - roof (mm)      | 56 - 30 - 30 |
| Certified seats                             | 4            |
| Maximum overall weight (kg)***              | 3500         |

### BEDS

|                                                 |               |
|-------------------------------------------------|---------------|
| Berths                                          | 4             |
| Assemblable berths                              | -             |
| Assemblable single bed centre dinette           | -             |
| Assemblable double bed centre dinette           | -             |
| Assemblable double bed rear dinette             | -             |
| Front drop-down bed                             | 1220x2000     |
| Drop-down bed maximum static load capacity (kg) | 250           |
| Rear single bed                                 | n. 1 800x1975 |
| Rear double bed                                 | n. 1 750x2040 |
| Rear double bed with extension:                 | 1400x2200     |
| Bunk bed                                        | -             |
| Rear drop-down double bed                       | -             |

### TANKS

|                            |                  |
|----------------------------|------------------|
| Drinking water (inside)*** | 20 + 65 l.       |
| Waste water tank           | 100 l.           |
| Antifreeze tank            | ✓                |
| Gas bottle locker          | (1+1) x 11:13 kg |

### EQUIPMENT

|                                                          |            |
|----------------------------------------------------------|------------|
| Gas heater                                               | Combi C6   |
| Water heater                                             | Combi C6   |
| Cabin swivel seats                                       | ✓          |
| Panoramic porthole living area                           | -          |
| Openable panoramic porthole low-profile models front pod | ✓          |
| Fridge                                                   | 153 l.     |
| Nr. burners hob                                          | 3          |
| Extractor hood                                           | ✓          |
| Oven                                                     | on request |
| Garage (access door dimensions) H (mm) x W (mm)          | 1050x750   |
| Driver's cabin blackout blind                            | on request |
| Entrance door with fly screen                            | ✓          |
| TV-holder                                                | ✓          |
| Roof rack with ladder                                    | on request |
| Service battery                                          | on request |
| Cabin seat covers                                        | ✓          |
| Parking feet                                             | ✓          |
| Bicycle rack                                             | on request |
| Alarm system                                             | on request |
| Outside entrance door lamp                               | ✓          |

\*the Fiat Ducato 132 kW - 180 CV engine is available on request

\*\*\*for legal information about the weights see page 133





# Designed to move at your pace

## The greatest adventure? The one built around your dreams

Whatever your idea of outdoor life is, there is a Horus that is perfect for you. Its agility and easy manoeuvrability means that there are no limits to imagination or age for a new adventure. Sleek and compact or large and spacious, it offers many details to make you fall in love: from the new, elegant and contemporary interior fittings in matt black, to the maximum practicality of the new kitchen tops and tables in high-strength laminate. Then there is the smart Elyplan fibreglass interior cladding, which is durable and easy to clean, for people whose top priority is outdoor life.

Discover the two new Horus 12 and 54 models. The first is agile and small, the second is extremely versatile, able to convert the sleeping area into a handy storage area. And again, with Horus you'll find all the comforts of home: double beds, twin beds, 3D touch storage compartments, a 90-litre fridge and durable upholstery. And a functional storage system for carefree travelling.



## Horus

Engine  
Fiat Ducato

Displacement  
2,2 L



from 5413  
to 6363 mm



4



from 3  
to 5



**Happiness is on  
the road, get  
comfy**

**NEW**



- 1 New interior fittings in matt black** (adjustable spotlights, switches and outlets)
- 2 New kitchen tops and tables in high-strength laminate**

- 3 Removable smart table with extension** which can be used as an outdoor table



- 4 **90-litre fridge** (141-litre on request) on models 38, 45 and 95 | **70-litre** on models 12 and 54
- 5 **Storage compartments with elastic bands**

- 6 **Sliding blinds with integrated fly-screen**
- 7 **Panoramic windows** with comfortable sliding opening handle





8 **Driver's cabin blackout blind** as standard

10 **External water supply with shower** as standard

9 **Electric access step with safety system**  
connected to the dashboard

- Combi Gas heating system as standard
- Rear heating with dedicated vents
- USB outlets in both living and sleeping areas
- Interior wardrobe lighting and adjustable reading lights
- Large storage compartments above the driver's cabin
- Cabinets with push/pull opening and soft-close locking arms with built-in LED lights
- Dinette which transforms into an extra bed

## Sleeping area



French bed  
HORUS 12

Double bed  
HORUS 38  
HORUS 54

Double  
superimposed  
bunk beds  
HORUS 45

Twin beds  
HORUS 95

NEW

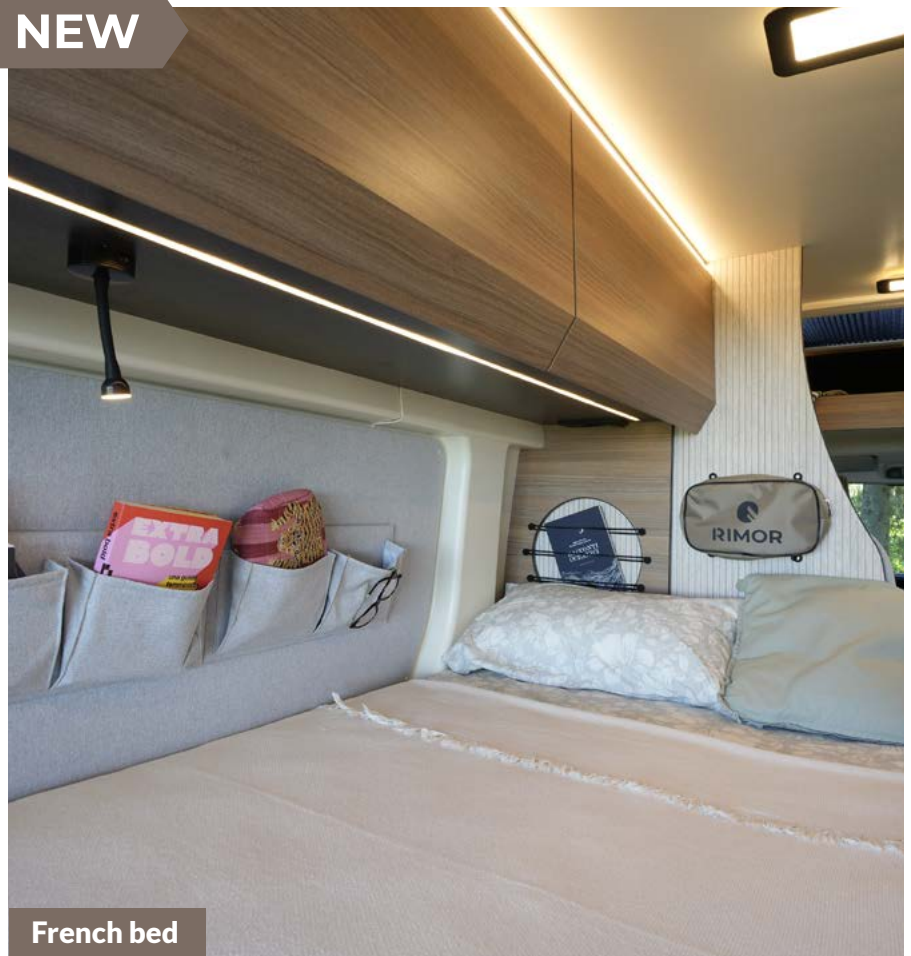

French bed



Twin beds





Double bed



Double superimposed bunk beds



## Living area and kitchen



HORUS 38, 45 and 95

**NEW**



**HORUS 54**





**NEW**



**HORUS 12**

**NEW**

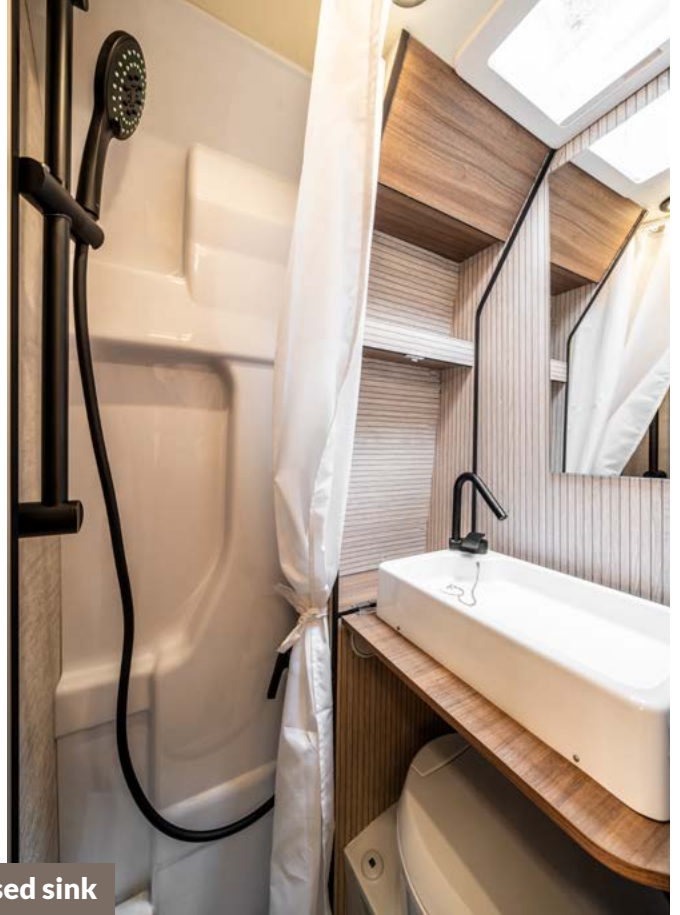

**Incorporated toilet and shower cubicle with recessed sink**

## Bathroom



**XL Toilet and shower  
cubicle integrated**  
HORUS 12

**Toilet and shower  
cubicle integrated**  
HORUS 38  
HORUS 45  
HORUS 95

**Incorporated toilet  
and shower cubicle  
with recessed sink**  
HORUS 54





**NEW**



**XL toilet and shower cubicle integrated**



**Toilet and shower cubicle integrated  
HORUS 38 and 45**



**Toilet and shower cubicle integrated  
HORUS 95**

## Models and layouts

NEW

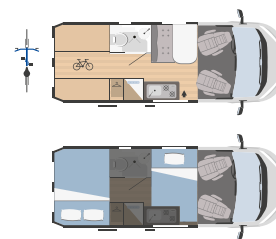
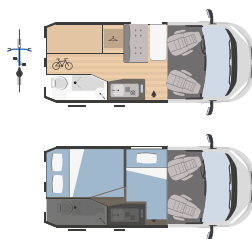

|                               | HORUS 12  | HORUS 38  |
|-------------------------------|-----------|-----------|
| ↔ Outside length x width (mm) | 5413x2050 | 5998x2050 |
| 👤 Certified seats             | 4         | 4         |
| 🛏 Berths                      | 3         | 3         |

NEW

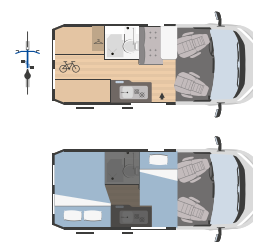
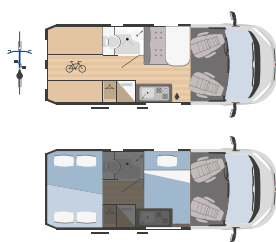

|                               | HORUS 45  | HORUS 54  |
|-------------------------------|-----------|-----------|
| ↔ Outside length x width (mm) | 5998x2050 | 5413x2050 |
| 👤 Certified seats             | 4         | 4         |
| 🛏 Berths                      | 5         | 3         |

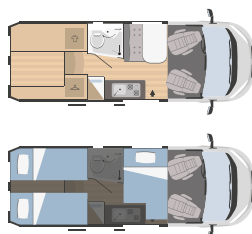

|                               | HORUS 95  |
|-------------------------------|-----------|
| ↔ Outside length x width (mm) | 6363x2050 |
| 👤 Certified seats             | 4         |
| 🛏 Berths                      | 3         |



**NEW**

# HORUS 12

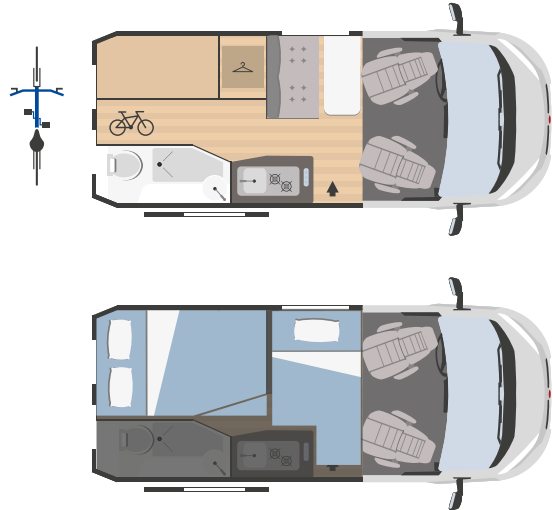
**FIAT**  
PROFESSIONAL↔  
**5143x2050****4****3**

## MECHANICAL UNIT

|                       |             |
|-----------------------|-------------|
| Engine                | Fiat Ducato |
| Wheelbase (mm)        | 3450        |
| Displacement (L)      | 2,2         |
| Maximum power (kW-HP) | 103-140     |
| Radio                 | on request  |

## DIMENSIONS AND WEIGHTS

|                                             |             |
|---------------------------------------------|-------------|
| Outside length (mm)                         | 5413        |
| Outside width - inside width (mm)           | 2050 - 1850 |
| Maximum outside height - inside height (mm) | 2659 - 1875 |
| Certified seats                             | 4           |
| Maximum overall weight (kg)***              | 3500        |

## BETTEN

|                                          |                     |
|------------------------------------------|---------------------|
| Berths                                   | 2                   |
| Assemblable Berths                       | 1                   |
| Assemblable single bed<br>centre dinette | 1100x1820<br>(1320) |
| Assemblable double bed<br>centre dinette | -                   |
| Assemblable double bed<br>rear dinette   | -                   |
| Rear single bed                          | -                   |
| Rear double bed                          | 1200x1900           |

## TANKS

|                            |                  |
|----------------------------|------------------|
| Drinking water (inside)*** | 20 + 65 l.       |
| Waste water tank           | 90 l.            |
| Antifreeze tank            | on request       |
| Gas bottle locker          | (1+1) x 11:13 kg |

## EQUIPMENT

|                                 |            |
|---------------------------------|------------|
| Gas heater                      | Combi C4   |
| Water heater                    | Combi C4   |
| Cabin swivel seats              | ✓          |
| Panoramic porthole living area  | ✓          |
| Driver's cabin blackout blind   | ✓          |
| Fridge                          | 70 l.      |
| Nr. burners hob                 | 2          |
| Extractor hood                  | -          |
| Oven                            | -          |
| Entrance door with fly screen   | on request |
| TV-holder                       | on request |
| Roof rack with ladder           | on request |
| Service battery                 | on request |
| Cabin seat covers               | on request |
| Bicycle rack                    | on request |
| Alarm system                    | on request |
| Outside entrance door lamp      | on request |
| Electrical tow hook preparation | on request |

\*\*\*for legal information about the weights see page 133

# HORUS 38

**FIAT**  
PROFESSIONAL



↔  
**5998x2050**



**4**



**3**

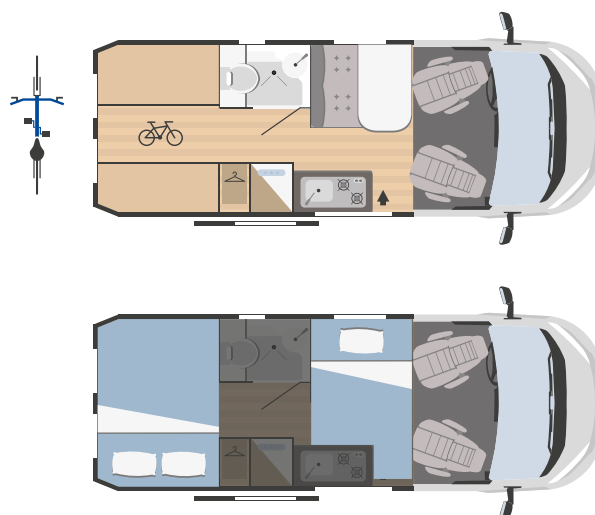

## MECHANICAL UNIT

|                       |             |
|-----------------------|-------------|
| Engine                | Fiat Ducato |
| Wheelbase (mm)        | 4035        |
| Displacement (L)      | 2,2         |
| Maximum power (kW-HP) | 103-140*    |
| Radio                 | on request  |

## DIMENSIONS AND WEIGHTS

|                                             |             |
|---------------------------------------------|-------------|
| Outside length (mm)                         | 5998        |
| Outside width - inside width (mm)           | 2050 - 1850 |
| Maximum outside height - inside height (mm) | 2659 - 1875 |
| Certified seats                             | 4           |
| Maximum overall weight (kg)***              | 3500        |

## BETTEN

|                                          |                     |
|------------------------------------------|---------------------|
| Berths                                   | 2                   |
| Assemblable Berths                       | 1                   |
| Assemblable single bed<br>centre dinette | 1150x1820<br>(1400) |
| Assemblable double bed<br>centre dinette | -                   |
| Assemblable double bed<br>rear dinette   | -                   |
| Rear single bed                          | -                   |
| Rear double bed                          | 1350x1920           |

## TANKS

|                            |                  |
|----------------------------|------------------|
| Drinking water (inside)*** | 20 + 65 l.       |
| Waste water tank           | 90 l.            |
| Antifreeze tank            | on request       |
| Gas bottle locker          | (1+1) x 11:13 kg |

## EQUIPMENT

|                                 |                               |
|---------------------------------|-------------------------------|
| Gas heater                      | Combi C4                      |
| Water heater                    | Combi C4                      |
| Cabin swivel seats              | ✓                             |
| Panoramic porthole living area  | ✓                             |
| Driver's cabin blackout blind   | ✓                             |
| Fridge                          | 90 l. (141 l. on request)     |
| Nr. burners hob                 | 2                             |
| Extractor hood                  | -                             |
| Oven                            | on request (NO fridge 141 l.) |
| Entrance door with fly screen   | on request                    |
| TV-holder                       | on request                    |
| Roof rack with ladder           | on request                    |
| Service battery                 | on request                    |
| Cabin seat covers               | on request                    |
| Bicycle rack                    | on request                    |
| Alarm system                    | on request                    |
| Outside entrance door lamp      | on request                    |
| Electrical tow hook preparation | on request                    |

\*the Fiat Ducato 88 kW - 120 CV engine is available on request

\*\*\*for legal information about the weights see page 133

# HORUS 45



↔  
5998x2050

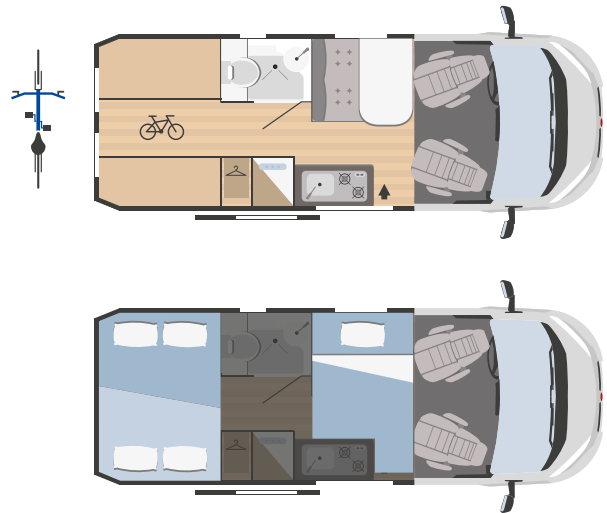

## MECHANICAL UNIT

|                       |             |
|-----------------------|-------------|
| Engine                | Fiat Ducato |
| Wheelbase (mm)        | 4035        |
| Displacement (L)      | 2,2         |
| Maximum power (kW-HP) | 103-140*    |
| Radio                 | on request  |

## DIMENSIONS AND WEIGHTS

|                                             |             |
|---------------------------------------------|-------------|
| Outside length (mm)                         | 5998        |
| Outside width - inside width (mm)           | 2050 - 1850 |
| Maximum outside height - inside height (mm) | 2659 - 1875 |
| Certified seats                             | 4           |
| Maximum overall weight (kg)***              | 3500        |

## BETTEN

|                                          |                     |
|------------------------------------------|---------------------|
| Berths                                   | 4                   |
| Assemblable Berths                       | 1                   |
| Assemblable single bed<br>centre dinette | 1150x1820<br>(1400) |
| Assemblable double bed<br>centre dinette | -                   |
| Assemblable double bed<br>rear dinette   | -                   |
| Rear single bed                          | -                   |
| Rear double bed                          | n.2 1350x1850       |

## TANKS

|                            |                |
|----------------------------|----------------|
| Drinking water (inside)*** | 20 + 65 l.     |
| Waste water tank           | 90 l.          |
| Antifreeze tank            | on request     |
| Gas bottle locker          | (1+1) x 5:6 kg |

## EQUIPMENT

|                                 |                               |
|---------------------------------|-------------------------------|
| Gas heater                      | Combi C4                      |
| Water heater                    | Combi C4                      |
| Cabin swivel seats              | ✓                             |
| Panoramic porthole living area  | ✓                             |
| Driver's cabin blackout blind   | ✓                             |
| Fridge                          | 90 l. (141 l. on request)     |
| Nr. burners hob                 | 2                             |
| Extractor hood                  | -                             |
| Oven                            | on request (NO fridge 141 l.) |
| Entrance door with fly screen   | on request                    |
| TV-holder                       | on request                    |
| Roof rack with ladder           | on request                    |
| Service battery                 | on request                    |
| Cabin seat covers               | on request                    |
| Bicycle rack                    | on request                    |
| Alarm system                    | on request                    |
| Outside entrance door lamp      | on request                    |
| Electrical tow hook preparation | on request                    |

\*the Fiat Ducato 88 kW - 120 CV engine is available on request

\*\*\*for legal information about the weights see page 133

**NEW**

# HORUS

## 54

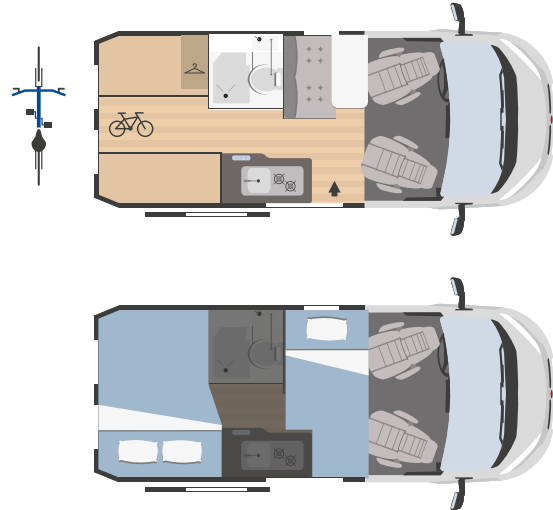
↔  
**5413x2050**

### MECHANICAL UNIT

|                       |             |
|-----------------------|-------------|
| Engine                | Fiat Ducato |
| Wheelbase (mm)        | 3450        |
| Displacement (L)      | 2,2         |
| Maximum power (kW-HP) | 103-140     |
| Radio                 | on request  |

### DIMENSIONS AND WEIGHTS

|                                             |             |
|---------------------------------------------|-------------|
| Outside length (mm)                         | 5413        |
| Outside width - inside width (mm)           | 2050 - 1850 |
| Maximum outside height - inside height (mm) | 2659 - 1875 |
| Certified seats                             | 4           |
| Maximum overall weight (kg)***              | 3500        |

### BETTEN

|                                          |           |
|------------------------------------------|-----------|
| Berths                                   | 2         |
| Assemblable Berths                       | 1         |
| Assemblable single bed<br>centre dinette | 900x1820  |
| Assemblable double bed<br>centre dinette | -         |
| Assemblable double bed<br>rear dinette   | -         |
| Rear single bed                          | -         |
| Rear double bed                          | 1320x1920 |

### TANKS

|                            |                  |
|----------------------------|------------------|
| Drinking water (inside)*** | 20 + 59 l.       |
| Waste water tank           | 90 l.            |
| Antifreeze tank            | on request       |
| Gas bottle locker          | (1+1) x 11:13 kg |

### EQUIPMENT

|                                 |            |
|---------------------------------|------------|
| Gas heater                      | Combi C4   |
| Water heater                    | Combi C4   |
| Cabin swivel seats              | ✓          |
| Panoramic porthole living area  | ✓          |
| Driver's cabin blackout blind   | ✓          |
| Fridge                          | 70 l.      |
| Nr. burners hob                 | 2          |
| Extractor hood                  | -          |
| Oven                            | -          |
| Entrance door with fly screen   | on request |
| TV-holder                       | on request |
| Roof rack with ladder           | on request |
| Service battery                 | on request |
| Cabin seat covers               | on request |
| Bicycle rack                    | on request |
| Alarm system                    | on request |
| Outside entrance door lamp      | on request |
| Electrical tow hook preparation | on request |

\*\*\*for legal information about the weights see page 133

# HORUS 95



↔  
6363x2050



4



3

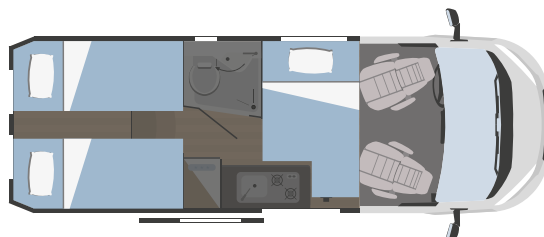
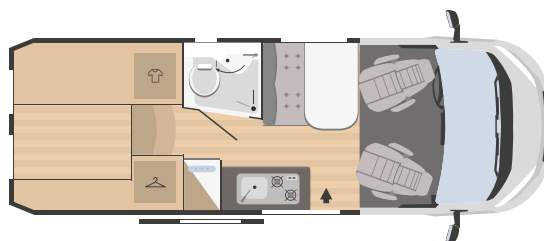

## MECHANICAL UNIT

|                       |             |
|-----------------------|-------------|
| Engine                | Fiat Ducato |
| Wheelbase (mm)        | 4035XL      |
| Displacement (L)      | 2,2         |
| Maximum power (kW-HP) | 103-140     |
| Radio                 | on request  |

## DIMENSIONS AND WEIGHTS

|                                             |             |
|---------------------------------------------|-------------|
| Outside length (mm)                         | 6363        |
| Outside width - inside width (mm)           | 2050 - 1850 |
| Maximum outside height - inside height (mm) | 2659 - 1875 |
| Certified seats                             | 4           |
| Maximum overall weight (kg)***              | 3500        |

## BETTEN

|                                          |                           |
|------------------------------------------|---------------------------|
| Berths                                   | 2                         |
| Assemblable Berths                       | 1                         |
| Assemblable single bed<br>centre dinette | 1100x1820<br>(1400)       |
| Assemblable double bed<br>centre dinette | -                         |
| Assemblable double bed<br>rear dinette   | -                         |
| Rear single bed                          | 800x1900 - 800x1900       |
| Rear double bed                          | with extension: 1300x1920 |

## TANKS

|                            |                  |
|----------------------------|------------------|
| Drinking water (inside)*** | 20 + 65 l.       |
| Waste water tank           | 90 l.            |
| Antifreeze tank            | on request       |
| Gas bottle locker          | (1+1) x 11:13 kg |

## EQUIPMENT

|                                 |                               |
|---------------------------------|-------------------------------|
| Gas heater                      | Combi C4                      |
| Water heater                    | Combi C4                      |
| Cabin swivel seats              | ✓                             |
| Panoramic porthole living area  | ✓                             |
| Driver's cabin blackout blind   | ✓                             |
| Fridge                          | 90 l. (141 l. on request)     |
| Nr. burners hob                 | 2                             |
| Extractor hood                  | -                             |
| Oven                            | on request (NO fridge 141 l.) |
| Entrance door with fly screen   | on request                    |
| TV-holder                       | on request                    |
| Roof rack with ladder           | on request                    |
| Service battery                 | on request                    |
| Cabin seat covers               | on request                    |
| Bicycle rack                    | on request                    |
| Alarm system                    | on request                    |
| Outside entrance door lamp      | on request                    |
| Electrical tow hook preparation | on request                    |

\*\*\*for legal information about the weights see page 133





RIMOR

RIMOR

HORUS  
45

# Mechanical units

## Safety and reliability in the driving seat

### Ford Transit



As standard:

- Driving seat armrests
- Cruise control
- Double airbag
- Central locking
- Electric windows
- Electric rear-view mirrors
- ABS (anti-lock braking system)
- Hill-start assist
- USB/MP3/BLUETOOTH radio with steering wheel mounted controls
- Start & Stop
- Sync 4 infotainment system with 12" screen
- 8" 'trend' digital dashboard + storage drawer with lock
- Trend' interior cladding
- Rapid windscreen defrosting system
- Automatic rain-sensing windscreen wipers
- Electric rear-view mirrors with defrosting
- Cruise control
- Electric handbrake
- Lane Keeping Assist + Lane departure detection
- Speed limit traffic sign recognition
- Front parking sensors
- Rear-view camera
- Fog lights
- Automatic lights
- Blindspot and brake assist for pedestrian and cyclist detection

### Fiat Ducato X250



As standard:

- Comfort Plus "Captain Chair" seats: built-in headrests, an even broader back and two armrests with height and incline adjustment
- Cruise control
- Double Airbag
- Central locking
- Radio predisposition and speakers
- Electric windows
- Electric rear-view mirrors
- ABS (anti-block braking system)
- Side mirror-integrated DAB antenna, standard
- Fog lights
- Traction plus + Hill-start assist
- Steering wheel controls (without radio)
- Back suspensions in composite material
- All-season tyres

# Fabrics

Colours and textures to personalise your travel experience

## Sarus



**Meringue**  
(standard)

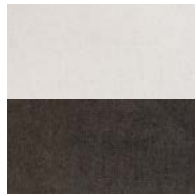

**Noisette**  
(optional)

## Kilig

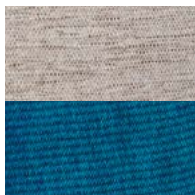

**Glace**  
(standard)

## Super Brig

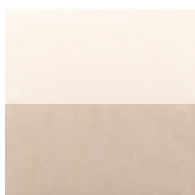

**Vanille**  
(standard)

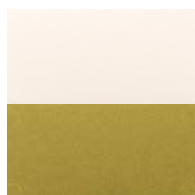

**Pistache**  
(optional)

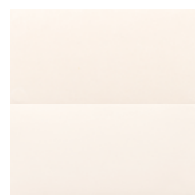

**Champagne**  
(eco-leather optional)

## Horus

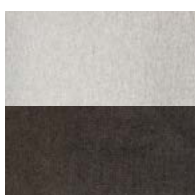

**Meringue**  
(standard)

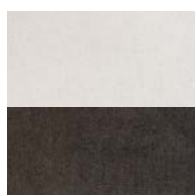

**Noisette**  
(optional)



RIMOR

RIMOR

## Legal information about the weights

### Mass in running order

The mass in running order of the type-approved vehicle includes: driver, fuel tank filled to 90% of its capacity, clean water tank filled to 20 l (using the special discharge valve) and gas cylinders (max. 15 kg) filled to 90% of their capacity.

The calculated mass in running order has a tolerance of +/- 5% compared to that of point (b) defined at the time of type-approval. Everything not included in the vehicle's standard version, both living pod and chassis, increases the weight in running order with the consequent reduction in the useful load up to the possible reduction of the total number of belted seats compared the type-approved ones.

The available useful load is the difference between the maximum mass permitted with full load and the mass in running order plus the weight of the passengers. It is therefore advisable at the time of purchase to pay special attention to the weight of the optionals you intend to install on the vehicle.

### Overall mass

The overall mass is the total mass of the vehicle that must not be exceeded.

### Potable water tank while driving

The clean water tank must contain 20 litres of water, using the supplied discharge taps, when the vehicle is in running order.

The technical data and vehicle characteristics, as set forth in this catalogue, are purely indicative in nature. The manufacturer and distributor cannot be held liable in the event of changes made for any reason during the season.

# World sweet home



Continue your trip with Rimor online. Follow all our activities on our blog, Facebook and Instagram. Share all your adventures with us on social media with #Rimor



[www.rimor.it](http://www.rimor.it)



