



**RIMOR**

**Catalogue 2024-2025**



# RIMOR

# World sweet home

## **The world is your new address**

Let new discoveries and adventures get your imagination started. With Rimor, the whole world is now your home. We have been building motorhomes and vans for over 45 years, taking inspiration from the place closest to us to make sure you're as comfortable as possible. Functional and welcoming, spacious and comfortable, vehicles that are a true expression of design and all-Italian production.

Rediscover freedom of movement at the seaside and in the mountains, in the city and the countryside. With Rimor motorhomes and vans you'll feel at home, wherever you choose to go.

# Your compass

## Find the Rimor that suits you best with our handy map

How to find the vehicle that best reflects your idea of outdoor life and turn it into reality? Get help with this handy map. You can choose the Rimor range that best meets your needs, quickly comparing the number of beds available, the number of homologated seats, the total length of the vehicle and the engine.

### Kilig

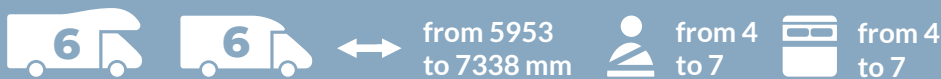

### Sarus

NEW

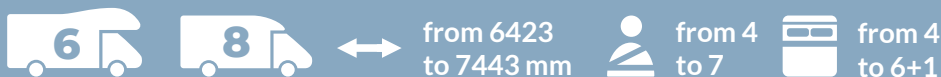

### Super Brig



### Horus

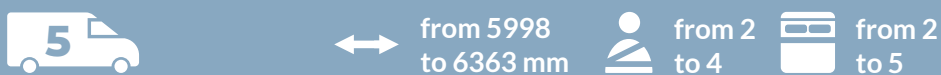

#### Legend

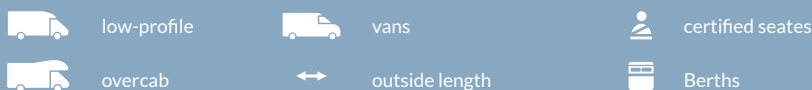

 **KILIG**



**»» 08**

 **SARUS**



**»» 42**

 **SUPER BRIG**



**»» 82**

 **HORUS**



**»» 108**



# Guided by experience

## Comfort and functionality for all our models

Numerous ranges, loads more models, but many common features, starting with reliability and functionality, the result of construction techniques tested over time. Our choice of the best solutions to guarantee you maximum comfort is guided by our experience, all under the banner of Italian craftsmanship.



- **Motorhome living areas** designed **without a single step**
- **High-comfort motorhome tables that can be moved in all directions**
- **Removable van smart table with extension** which can be used as an outdoor table
- **220/230 V outlets** in both the kitchen and the bathroom
- New lids for hob with **safety flameproof** closure
- **New sliding blind with integrated fly-screen**
- **100% LED lighting**
- **Solid shower door** as standard
- **Spacious beds**, up to 220 cm long, with wooden slatted bases
- **High-density comfort mattresses** with removable covers which are anatomical and hypo-allergenic
- **Overcab bed with pneumatic slatted base**
- **Easyroad motorhome dinette in the face-to-face models** (each of the two bench seats can be quickly transformed into comfortable travel seats)
- Interior side cladding of motorhomes in **durable, easy to clean Elyplan fibreglass**
- **Easy access cell entrance with internal step**
- **10mA residual current circuit breaker**
- **Isofix attachment points** (optional) available on all models



# Admire your new love

## If your heart starts beating faster, that's camper life

Kilig is a big emotion... or a small and precious one, just like the range of models designed for the different approaches to life en plein air. You will find solutions in less than 6 metres, such as Kilig 4 and 18 Plus, for maximum manoeuvrability and convenience when travelling by ferry, motorway and in parking places.

Or choose the spacious comfort of the new Kilig 77 with double dinette and double drop-down bed, Kilig 50 with two bunk beds and family-size dinette, Kilig 67 Plus without fixed bed with XL front drop-down bed and walk-in wardrobe, and Kilig 66 Plus with central bed and face-to-face dinette.

Then there are all the elegant and smart solutions.

The new interior details in matt black are the modern finish you are looking for as well as a greater interior height, perfect for taller people. Also, the multi-purpose kitchen panel brings practicality back into fashion, as does the detachable tubular garage lamp that can become a practical inspection light.





## Kilig

Engine  
Ford Transit

Displacement  
2,0L



from 5953  
to 7308 mm



from  
4 to 7



from  
5 to 6+1



from 5953  
to 7338 mm



from  
4 to 5



from  
4 to 7



**By your side at  
special moments**

**NEW**



- 1 **New interior fittings in matt black** (adjustable spotlights, switches and outlets)
- 2 **Multi-purpose magnetic kitchen panel**

- 3 **Slim 141 L fridge** on all models

NEW



4 New exclusive layout with double dinette and double dropdown bed (Kilig 77 Plus)



**5 Entrance door with storage pockets** (optional window)



**6 Openable skyview** (optional)



**7 Detachable tubular garage lamp** that becomes a practical inspection light

- Combi Gas heating with standard supply CP Plus digital control unit
- Kitchen sink with lid and folding mixer tap
- Panoramic windows with practical sliding opening handle (standard throughout the whole range)
- Additional bed kit dinette with ergonomic, easily adaptable cushions (optional)
- Interior height in living areas underneath the drop-down bed 185 cm
- On the profiled models, the driver's cabin is incorporated in the living area, with the fairing upholstered in soft touch fabric
- Semi-dinette table with sliding system: more leg room both when driving and when parked





front/rear facing dinette

## Living area



Compact dinette

KILIG 4

Front/rear facing  
dinette

KILIG 5

L-shape dinette

KILIG 669

KILIG 695

Double dinette

KILIG 9

Double dinette  
island

KILIG 50



compact dinette



double dinette



double dinette island



L-shaped dinette

## Living area



### L-shaped dinette

KILIG 18 PLUS  
KILIG 69 PLUS  
KILIG 95 PLUS

### Face-to-face dinette

KILIG 66 PLUS  
KILIG 67 PLUS

Front + rear dinette  
KILIG 77 PLUS



face-to-face dinette



**NEW**



**front + rear dinette**



Queres Bett

## Sleeping area



### Transverse bed

KILIG 4

KILIG 5

### Bunk beds

KILIG 9

### Double bunk beds

KILIG 50

### Central bed

KILIG 669

### Twin beds

KILIG 695



bunk bed





twin beds



double bunk beds

## Sleeping area



**Transverse bed**  
KILIG 18 PLUS

**Central bed**  
KILIG 66 PLUS  
KILIG 69 PLUS

**XL Front drop-down bed**  
KILIG 67 PLUS

**Double drop-down beds**  
KILIG 77 PLUS

**Twin beds**  
KILIG 95 PLUS



central bed



XL front drop-down bed

**NEW**



**double drop-down bed**



compact kitchen

**Kitchen**



**Compact kitchen**  
 KILIG 669  
 KILIG 695

**Long kitchen**  
 KILIG 4  
 KILIG 5  
 KILIG 9  
 KILIG 50



**Compact kitchen**  
 KILIG 66 PLUS  
 KILIG 67 PLUS  
 KILIG 95 PLUS

**Long kitchen**  
 KILIG 18 PLUS  
 KILIG 77 PLUS





long kitchen

## Bathroom



**Single unit with shower alongside toilet**

KILIG 4  
KILIG 5  
KILIG 9

**Separate toilet and shower cubicle**

KILIG 669  
KILIG 695

**Toilet and shower cubicle integrated | Compact**

KILIG 50



**Single unit with shower alongside toilet**

KILIG 18 PLUS  
KILIG 77 PLUS

**Separate toilet and shower cubicle**

KILIG 66 PLUS  
KILIG 69 PLUS  
KILIG 95 PLUS

**Full-width with closet**

KILIG 67 PLUS



Toilet and shower cubicle integrated | Compact

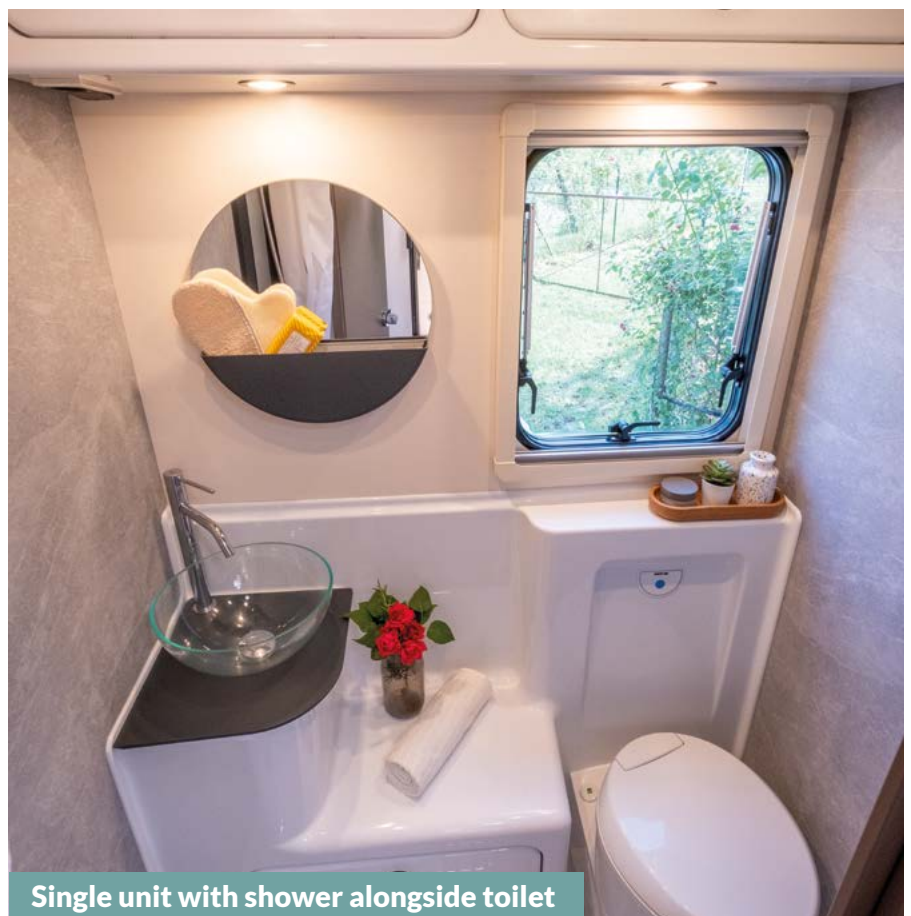

Single unit with shower alongside toilet





Separate toilet and shower cubicle



Full-width with closet



## Models and layouts

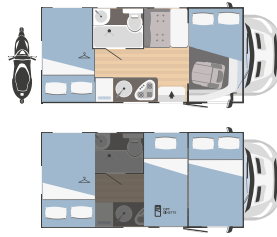

	KILIG 4	KILIG 5
↔ Outside length x width (mm)	5953x2340	6970x2340
👤 Certified seats	4	6
🛏 Berths	5 (1 opt)	6 (2 opt)
🚪 Garage (access door dimensions) H (mm) x W (mm)	1000x650	1280x850 (1080x850 opt)

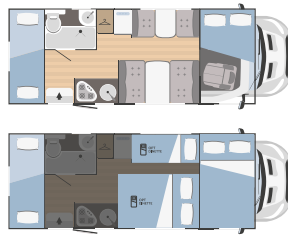

	KILIG 9	KILIG 50
↔ Outside length x width (mm)	6970x2340	7285x2340
👤 Certified seats	7	6
🛏 Berths	6+1 (2+1 opt)	6
🚪 Garage (access door dimensions) H (mm) x W (mm)	1150x650	n.1 950x1350 n.1 950x1150



	KILIG 669	KILIG 695
↔ Outside length x width (mm)	7308x2340	7308x2340
👤 Certified seats	5	5
🛏 Berths	5 (1 opt)	5 (1 opt)
🚪 Garage (access door dimensions) H (mm) x W (mm)	750x850 (1150x850 opt)	1050x850

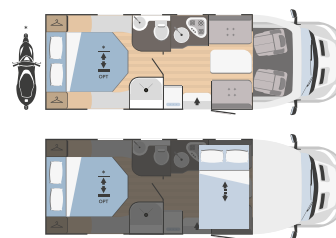
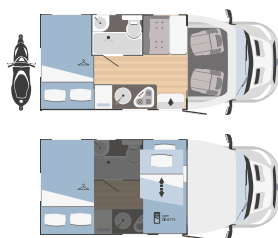

	KILIG 18 PLUS	KILIG 66 PLUS
↔ Outside length x width (mm)	5953x2340	7338x2340
👤 Certified seats	4	4
🛏 Berths	4 (1 opt)	4
🚪 Garage (access door dimensions) H (mm) x W (mm)	1000x650	750x850 (1150x850 opt)

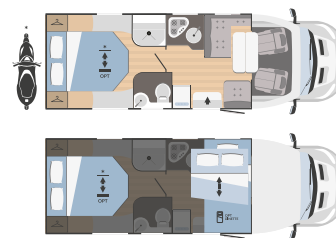
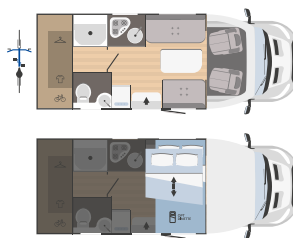

	KILIG 67 PLUS	KILIG 69 PLUS
↔ Outside length x width (mm)	6449x2340	7308x2340
👤 Certified seats	4	5
🛏 Berths	4 (2 opt)	5 (1 opt)
🚪 Garage (access door dimensions) H (mm) x W (mm)	1050x630	750x850 (1150x850 opt)

**NEW**

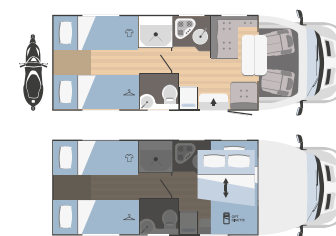
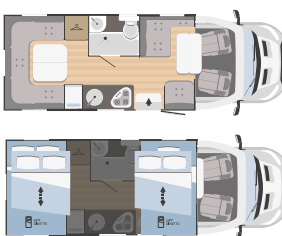

	KILIG 77 PLUS	KILIG 95 PLUS
↔ Outside length x width (mm)	6970x2340	7308x2340
👤 Certified seats	5	5
🛏 Berths	7 (3 opt)	5
🚪 Garage (access door dimensions) H (mm) x W (mm)	550x700	1050x850



# KILIG 4



↔  
**5953x2340**



**4**



**5**

(1 opt)



**1000x650**

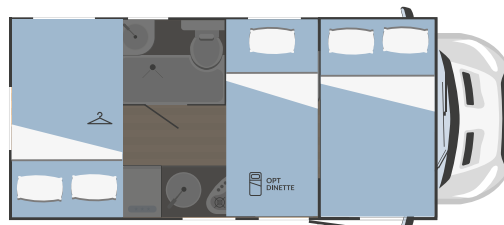
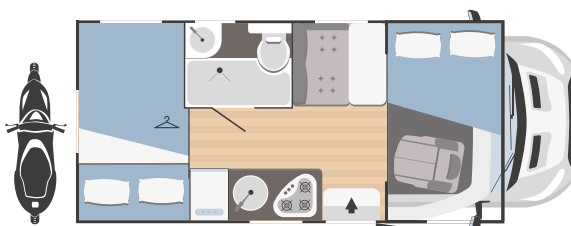

## MECHANICAL UNIT

Engine	Ford Transit
Wheelbase (mm)	3300
Displacement (L)	2,0
Maximum power (kW-HP)	96 - 130*
Radio	✓

## DIMENSIONS AND WEIGHTS

Outside length (mm)	5953
Outside width - inside width (mm)	2340 - 2200
Maximum outside height - inside height (mm)	3040 - 2060
Thickness of floor - walls - roof (mm)	56 - 30 - 30
Certified seats	4
Maximum overall weight (kg)***	3500

## BEDS

Berths	4
Optional berths	1
Overcab double bed	1400x2200
Assemblable single bed centre dinette optional	1050x2200
Assemblable double bed centre dinette optional	-
Assemblable double bed rear dinette optional	-
Rear single bed	-
Rear double bed	1230x2200
Bunk bed	-
Rear drop-down double bed	-

## TANKS

Drinking water (inside)***	20 + 65 l.
Waste water tank	73 l.
Antifreeze tank	on request
Gas bottle locker	(1+1) x 11:13 kg

## EQUIPMENT

Gas heater	Combi C4
Water heater	Combi C4
Cabin swivel seats	✓
Panoramic porthole living area	-
Openable panoramic porthole low-profile models front pod	-
Fridge	141 l.
Nr. burners hob	3
Extractor hood	on request
Oven	on request
Garage (access door dimensions) H (mm) x W (mm)	1000x650
Driver's cabin blackout blind	on request
Entrance door with fly screen	on request
TV-holder	on request
Roof rack with ladder	on request
Service battery	on request
Cabin seat covers	on request
Parking feet	on request
Bicycle rack	on request
Alarm system	on request
Outside entrance door lamp	on request

\*the Ford Transit 121kW - 165 CV engine is available on request

\*\*\*for legal information about the weights see page 133

# KILIG 5



↔  
**6970x2340**

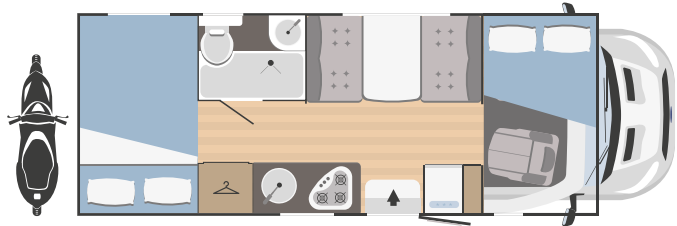

**6**



**6**  
(2 opt)



**1280x850**  
(1080x850 opt)

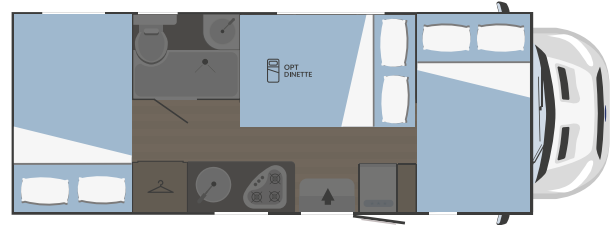

## MECHANICAL UNIT

Engine	Ford Transit
Wheelbase (mm)	3750
Displacement (L)	2,0
Maximum power (kW-HP)	96 - 130*
Radio	✓

## DIMENSIONS AND WEIGHTS

Outside length (mm)	6970
Outside width - inside width (mm)	2340 - 2200
Maximum outside height - inside height (mm)	3040 - 2060
Thickness of floor - walls - roof (mm)	56 - 30 - 30
Certified seats	6
Maximum overall weight (kg)***	3500

## BEDS

Berths	4
Optional berths	2
Overcab double bed	1400x2200
Assemblable single bed centre dinette optional	-
Assemblable double bed centre dinette optional	1290x1890
Assemblable double bed rear dinette optional	-
Rear single bed	-
Rear double bed	1300x2200
Bunk bed	-
Rear drop-down double bed	on request

## TANKS

Drinking water (inside)***	20 + 65 l.
Waste water tank	120 l.
Antifreeze tank	on request
Gas bottle locker	(1+1) x 11:13 kg

## EQUIPMENT

Gas heater	Combi C4
Water heater	Combi C4
Cabin swivel seats	✓
Panoramic porthole living area	on request
Openable panoramic porthole low-profile models front pod	-
Fridge	141 l.
Nr. burners hob	3
Extractor hood	on request
Oven	on request
Garage (access door dimensions) H (mm) x W (mm)	1280x850 (1080x850 on request)
Driver's cabin blackout blind	on request
Entrance door with fly screen	on request
TV-holder	on request
Roof rack with ladder	on request
Service battery	on request
Cabin seat covers	on request
Parking feet	on request
Bicycle rack	on request
Alarm system	on request
Outside entrance door lamp	on request

\*the Ford Transit 121kW - 165 CV engine is available on request

\*\*\*for legal information about the weights see page 133

# KILIG 9



↔  
**6970x2340**



**7**



**6+1**  
(2+1 opt)



**1150x650**

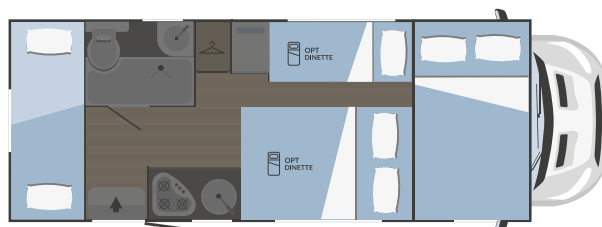
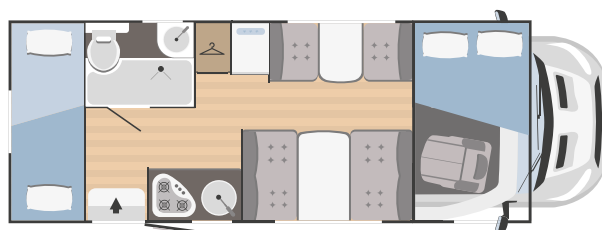

## MECHANICAL UNIT

Engine	Ford Transit
Wheelbase (mm)	3750
Displacement (L)	2,0
Maximum power (kW-HP)	96 - 130*
Radio	✓

## DIMENSIONS AND WEIGHTS

Outside length (mm)	6970
Outside width - inside width (mm)	2340 - 2200
Maximum outside height - inside height (mm)	3040 - 2060
Thickness of floor - walls - roof (mm)	56 - 30 - 30
Certified seats	7
Maximum overall weight (kg)***	3500

## BEDS

Berths	4
Optional berths	2+1
Overcab double bed	1400x2200
Assemblable single bed centre dinette optional	680x1600
Assemblable double bed centre dinette optional	1290x1890
Assemblable double bed rear dinette optional	-
Rear single bed	-
Rear double bed	-
Bunk bed	800x2200
Rear drop-down double bed	-

## TANKS

Drinking water (inside)***	20 + 65 l.
Waste water tank	120 l.
Antifreeze tank	on request
Gas bottle locker	(1+1) x 11:13 kg

## EQUIPMENT

Gas heater	Combi C4
Water heater	Combi C4
Cabin swivel seats	✓
Panoramic porthole living area	on request
Openable panoramic porthole low-profile models front pod	-
Fridge	141 l.
Nr. burners hob	3
Extractor hood	on request
Oven	on request
Garage (access door dimensions) H (mm) x W (mm)	1150x650
Driver's cabin blackout blind	on request
Entrance door with fly screen	on request
TV-holder	on request
Roof rack with ladder	on request
Service battery	on request
Cabin seat covers	on request
Parking feet	on request
Bicycle rack	on request
Alarm system	on request
Outside entrance door lamp	on request

\*the Ford Transit 121kW - 165 CV engine is available on request

\*\*\*for legal information about the weights see page 133

# KILIG 50



7285x2340



6



6



n.1 950x1350

n.1 950x1150

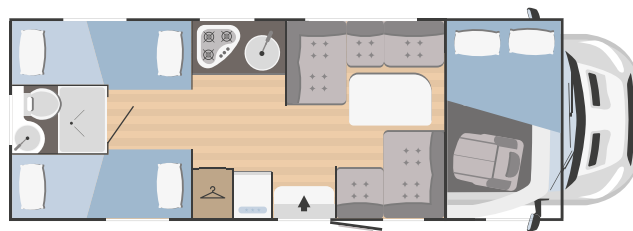

## MECHANICAL UNIT

Engine	Ford Transit
Wheelbase (mm)	3954
Displacement (L)	2,0
Maximum power (kW-HP)	96 - 130*
Radio	✓

## DIMENSIONS AND WEIGHTS

Outside length (mm)	7285
Outside width - inside width (mm)	2340 - 2200
Maximum outside height - inside height (mm)	3040 - 2060
Thickness of floor - walls - roof (mm)	56 - 30 - 30
Certified seats	6
Maximum overall weight (kg)***	3500

## BEDS

Berths	6
Optional berths	-
Overcab double bed	1400x2200
Assemblable single bed	-
centre dinette optional	-
Assemblable double bed	-
centre dinette optional	-
Assemblable double bed	-
rear dinette optional	-
Rear single bed	-
Rear double bed	-
Bunk bed	n.2 780x2000
Rear drop-down double bed	-

## TANKS

Drinking water (inside)***	20 + 65 l.
Waste water tank	120 l.
Antifreeze tank	on request
Gas bottle locker	(1+1) x 11:13 kg

## EQUIPMENT

Gas heater	Combi C4
Water heater	Combi C4
Cabin swivel seats	✓
Panoramic porthole living area	on request
Openable panoramic porthole low-profile models front pod	-
Fridge	141 l.
Nr. burners hob	3
Extractor hood	on request
Oven	on request
Garage (access door dimensions)	n. 1 950x1350
H (mm) x W (mm)	n. 1 950x1150
Driver's cabin blackout blind	on request
Entrance door with fly screen	on request
TV-holder	on request
Roof rack with ladder	on request
Service battery	on request
Cabin seat covers	on request
Parking feet	on request
Bicycle rack	on request
Alarm system	on request
Outside entrance door lamp	on request

\*the Ford Transit 121kW - 165 CV engine is available on request

\*\*\*for legal information about the weights see page 133



# KILIG 669



↔  
**7308x2340**

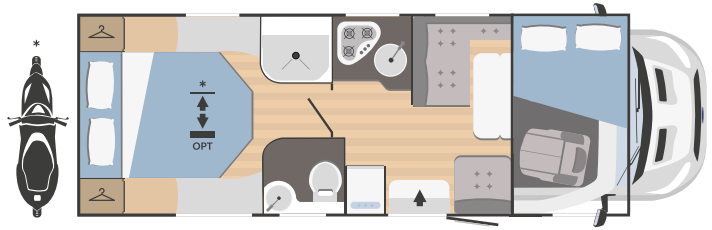

**5**



**5**

(1 opt)



**750x850**  
(1150x850 opt)

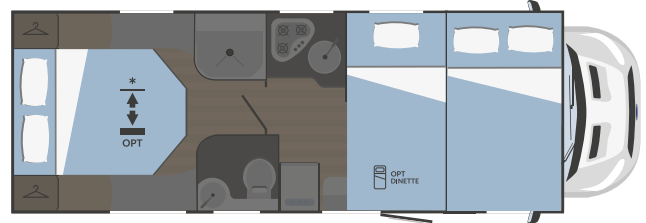

## MECHANICAL UNIT

Engine	Ford Transit
Wheelbase (mm)	3954
Displacement (L)	2,0
Maximum power (kW-HP)	96 - 130*
Radio	✓

## DIMENSIONS AND WEIGHTS

Outside length (mm)	7308
Outside width - inside width (mm)	2340 - 2200
Maximum outside height - inside height (mm)	3040 - 2060
Thickness of floor - walls - roof (mm)	56 - 30 - 30
Certified seats	5
Maximum overall weight (kg)***	3500

## BEDS

Berths	4
Optional berths	1
Overcab double bed	1400x2200
Assemblable single bed centre dinette optional	1040x2200
Assemblable double bed centre dinette optional	-
Assemblable double bed rear dinette optional	-
Rear single bed	-
Rear double bed	1400x1900
Bunk bed	-
Rear drop-down double bed	on request

## TANKS

Drinking water (inside)***	20 + 65 l.
Waste water tank	120 l.
Antifreeze tank	on request
Gas bottle locker	(1+1) x 11:13 kg

## EQUIPMENT

Gas heater	Combi C4
Water heater	Combi C4
Cabin swivel seats	✓
Panoramic porthole living area	-
Openable panoramic porthole low-profile models front pod	-
Fridge	141 l.
Nr. burners hob	3
Extractor hood	on request
Oven	on request
Garage (access door dimensions) H (mm) x W (mm)	750x850 (1150x850 on request)
Driver's cabin blackout blind	on request
Entrance door with fly screen	on request
TV-holder	on request
Roof rack with ladder	on request
Service battery	on request
Cabin seat covers	on request
Parking feet	on request
Bicycle rack	on request
Alarm system	on request
Outside entrance door lamp	on request

\*the Ford Transit 121kW - 165 CV engine is available on request

\*\*\*for legal information about the weights see page 133

# KILIG 695



↔  
**7308x2340**

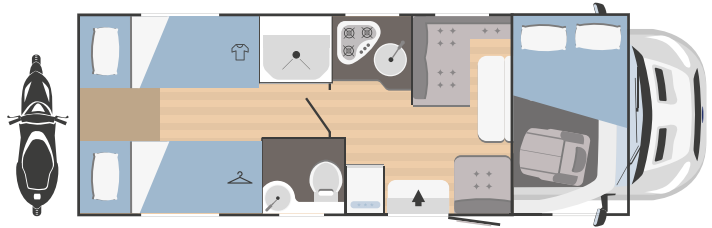

**5**



**5**  
(1 opt)



**1050x850**

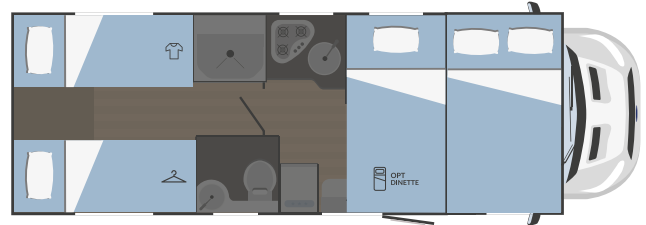

## MECHANICAL UNIT

Engine	Ford Transit
Wheelbase (mm)	3954
Displacement (L)	2,0
Maximum power (kW-HP)	96 - 130*
Radio	✓

## DIMENSIONS AND WEIGHTS

Outside length (mm)	7308
Outside width - inside width (mm)	2340 - 2200
Maximum outside height - inside height (mm)	3040 - 2060
Thickness of floor - walls - roof (mm)	56 - 30 - 30
Certified seats	5
Maximum overall weight (kg)***	3500

## BEDS

Berths	4
Optional berths	1
Overcab double bed	1400x2200
Assemblable single bed	1040x2200
Assemblable double bed centre dinette optional	-
Assemblable double bed centre dinette optional	-
Assemblable double bed rear dinette optional	-
Rear single bed	n. 1 800x2025 n 1 800x2100
Rear double bed	with extension: 1900x2200
Bunk bed	-
Rear drop-down double bed	-

## TANKS

Drinking water (inside)***	20 + 65 l.
Waste water tank	120 l.
Antifreeze tank	on request
Gas bottle locker	(1+1) x 11:13 kg

## EQUIPMENT

Gas heater	Combi C4
Water heater	Combi C4
Cabin swivel seats	✓
Panoramic porthole living area	-
Openable panoramic porthole low-profile models front pod	-
Fridge	141 l.
Nr. burners hob	3
Extractor hood	on request
Oven	on request
Garage (access door dimensions) H (mm) x W (mm)	1050x850
Driver's cabin blackout blind	on request
Entrance door with fly screen	on request
TV-holder	on request
Roof rack with ladder	on request
Service battery	on request
Cabin seat covers	on request
Parking feet	on request
Bicycle rack	on request
Alarm system	on request
Outside entrance door lamp	on request

\*the Ford Transit 121kW - 165 CV engine is available on request

\*\*\*for legal information about the weights see page 133

# KILIG 18 PLUS



↔  
**5953x2340**

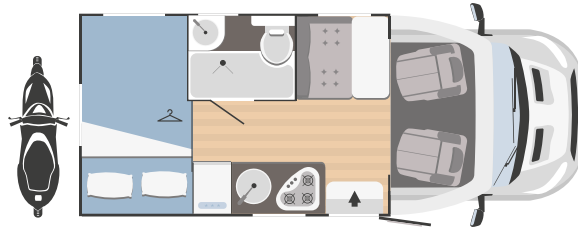

**4**



**4**  
(1 opt)



**1000x650**

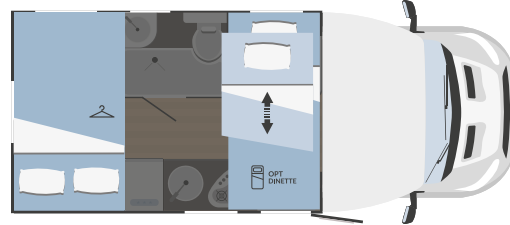

## MECHANICAL UNIT

Engine	Ford Transit
Wheelbase (mm)	3300
Displacement (L)	2,0
Maximum power (kW-HP)	96 - 130*
Radio	✓

## DIMENSIONS AND WEIGHTS

Outside length (mm)	5953
Outside width - inside width (mm)	2340 - 2200
Maximum outside height - inside height (mm)	2845 - 2060
Thickness of floor - walls - roof (mm)	56 - 30 - 30
Certified seats	4
Maximum overall weight (kg)***	3500

## BEDS

Berths	3
Optional berths	1
Assemblable single bed centre dinette optional	1050x2200
Assemblable double bed centre dinette optional	-
Assemblable double bed rear dinette optional	-
Front drop-down bed	980x2200
Rear drop-down bed	-
Drop-down bed maximum static load capacity (kg)	250
Rear single bed	-
Rear double bed	1230x2200
Bunk bed	-
Rear drop-down double bed	-

## TANKS

Drinking water (inside)***	20 + 65 l.
Waste water tank	73 l.
Antifreeze tank	on request
Gas bottle locker	(1+1) x 11:13 kg

## EQUIPMENT

Gas heater	Combi C4
Water heater	Combi C4
Cabin swivel seats	✓
Panoramic porthole living area	-
Openable panoramic porthole low-profile models front pod	on request
Fridge	141 l.
Nr. burners hob	3
Extractor hood	on request
Oven	on request
Garage (access door dimensions) H (mm) x W (mm)	1000x650
Driver's cabin blackout blind	on request
Entrance door with fly screen	on request
TV-holder	on request
Roof rack with ladder	on request
Service battery	on request
Cabin seat covers	on request
Parking feet	on request
Bicycle rack	on request
Alarm system	on request
Outside entrance door lamp	on request

\*the Ford Transit 121kW - 165 CV engine is available on request

\*\*\*for legal information about the weights see page 133

# KILIG 66 PLUS



↔  
**7338x2340**



**750x850**  
(1150x850 opt)

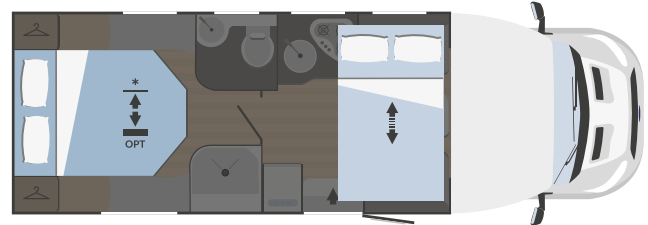
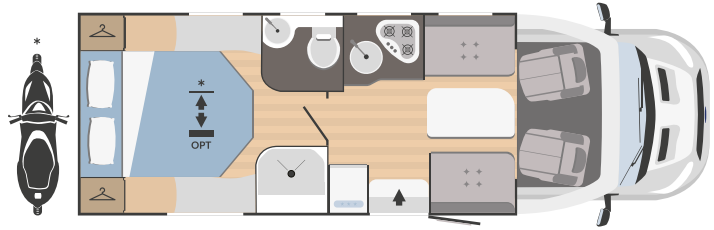

## MECHANICAL UNIT

Engine	Ford Transit
Wheelbase (mm)	3954
Displacement (L)	2,0
Maximum power (kW-HP)	96 - 130*
Radio	✓

## DIMENSIONS AND WEIGHTS

Outside length (mm)	7338
Outside width - inside width (mm)	2340 - 2200
Maximum outside height - inside height (mm)	2845 - 2060
Thickness of floor - walls - roof (mm)	56 - 30 - 30
Certified seats	4
Maximum overall weight (kg)***	3500

## BEDS

Berths	4
Optional berths	-
Assemblable single bed centre dinette optional	-
Assemblable double bed centre dinette optional	-
Assemblable double bed rear dinette optional	-
Front drop-down bed	1215x2000
Rear drop-down bed	-
Drop-down bed maximum static load capacity (kg)	250
Rear single bed	-
Rear double bed	1400x1900
Bunk bed	-
Rear drop-down double bed	on request

## TANKS

Drinking water (inside)***	20 + 60 l.
Waste water tank	120 l.
Antifreeze tank	on request
Gas bottle locker	(1+1) x 11:13 kg

## EQUIPMENT

Gas heater	Combi C4
Water heater	Combi C4
Cabin swivel seats	✓
Panoramic porthole living area	-
Openable panoramic porthole low-profile models front pod	on request
Fridge	141 l.
Nr. burners hob	3
Extractor hood	on request
Oven	on request
Garage (access door dimensions) H (mm) x W (mm)	750x850 (1150x850 on request)
Driver's cabin blackout blind	on request
Entrance door with fly screen	on request
TV-holder	on request
Roof rack with ladder	on request
Service battery	on request
Cabin seat covers	on request
Parking feet	on request
Bicycle rack	on request
Alarm system	on request
Outside entrance door lamp	on request

\*the Ford Transit 121kW - 165 CV engine is available on request

\*\*\*for legal information about the weights see page 133

# KILIG 67 PLUS



6449x2340



4



4  
(2 opt)



1050x630

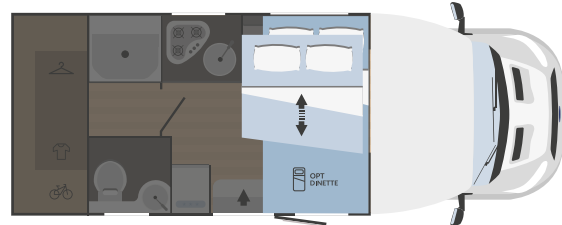
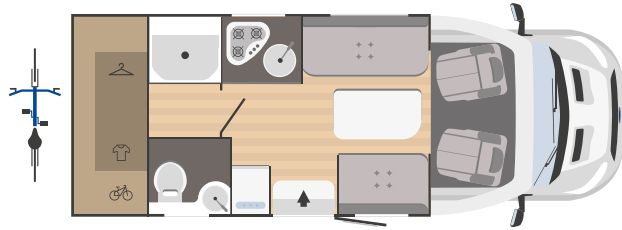

## MECHANICAL UNIT

Engine	Ford Transit
Wheelbase (mm)	3750
Displacement (L)	2,0
Maximum power (kW-HP)	96 - 130*
Radio	✓

## DIMENSIONS AND WEIGHTS

Outside length (mm)	6449
Outside width - inside width (mm)	2340 - 2200
Maximum outside height - inside height (mm)	2845 - 2060
Thickness of floor - walls - roof (mm)	56 - 30 - 30
Certified seats	4
Maximum overall weight (kg)***	3500

## BEDS

Berths	2
Optional berths	2
Assemblable single bed centre dinette optional	-
Assemblable double bed centre dinette optional	1400x2200
Assemblable double bed rear dinette optional	-
Front drop-down bed	1370x2000
Rear drop-down bed	-
Drop-down bed maximum static load capacity (kg)	250
Rear single bed	-
Rear double bed	-
Bunk bed	-
Rear drop-down double bed	-

## TANKS

Drinking water (inside)***	20 + 60 l.
Waste water tank	73 l.
Antifreeze tank	on request
Gas bottle locker	(1+1) x 11:13 kg

## EQUIPMENT

Gas heater	Combi C4
Water heater	Combi C4
Cabin swivel seats	✓
Panoramic porthole living area	-
Openable panoramic porthole low-profile models front pod	on request
Fridge	141 l.
Nr. burners hob	3
Extractor hood	on request
Oven	on request
Garage (access door dimensions) H (mm) x W (mm)	1050x630
Driver's cabin blackout blind	on request
Entrance door with fly screen	on request
TV-holder	on request
Roof rack with ladder	on request
Service battery	on request
Cabin seat covers	on request
Parking feet	on request
Bicycle rack	on request
Alarm system	on request
Outside entrance door lamp	on request

\*the Ford Transit 121kW - 165 CV engine is available on request

\*\*\*for legal information about the weights see page 133

# KILIG 69 PLUS



↔  
**7308x2340**

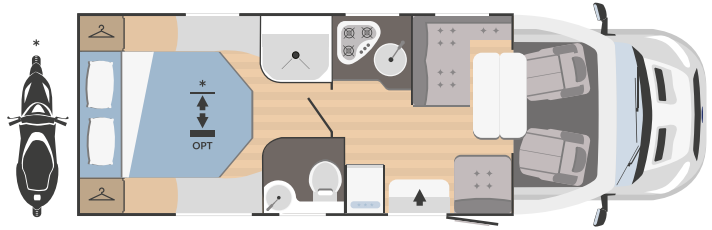

**5**



**5**  
(1 opt)



**750x850**  
(1150x850 opt)

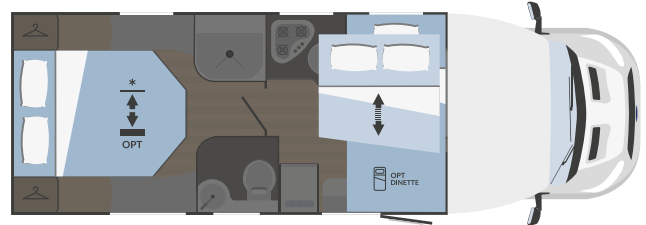

## MECHANICAL UNIT

Engine	Ford Transit
Wheelbase (mm)	3954
Displacement (L)	2,0
Maximum power (kW-HP)	96 - 130*
Radio	✓

## DIMENSIONS AND WEIGHTS

Outside length (mm)	7308
Outside width - inside width (mm)	2340 - 2200
Maximum outside height - inside height (mm)	2845 - 2060
Thickness of floor - walls - roof (mm)	56 - 30 - 30
Certified seats	5
Maximum overall weight (kg)***	3500

## BEDS

Berths	4
Optional berths	1
Assemblable single bed centre dinette optional	1040x2200
Assemblable double bed centre dinette optional	-
Assemblable double bed rear dinette optional	-
Front drop-down bed	1215x2000
Rear drop-down bed	-
Drop-down bed maximum static load capacity (kg)	250
Rear single bed	-
Rear double bed	1400x1900
Bunk bed	-
Rear drop-down double bed	on request

## TANKS

Drinking water (inside)***	20 + 65 l.
Waste water tank	120 l.
Antifreeze tank	on request
Gas bottle locker	(1+1) x 11:13 kg

## EQUIPMENT

Gas heater	Combi C4
Water heater	Combi C4
Cabin swivel seats	✓
Panoramic porthole living area	-
Openable panoramic porthole low-profile models front pod	on request
Fridge	141 l.
Nr. burners hob	3
Extractor hood	on request
Oven	on request
Garage (access door dimensions) H (mm) x W (mm)	750x850 (1150x850 on request)
Driver's cabin blackout blind	on request
Entrance door with fly screen	on request
TV-holder	on request
Roof rack with ladder	on request
Service battery	on request
Cabin seat covers	on request
Parking feet	on request
Bicycle rack	on request
Alarm system	on request
Outside entrance door lamp	on request

\*the Ford Transit 121kW - 165 CV engine is available on request

\*\*\*for legal information about the weights see page 133

NEW

# KILIG 77 PLUS



↔  
**6970x2340**



**5**



**7**  
(3 opt)



**550x700**

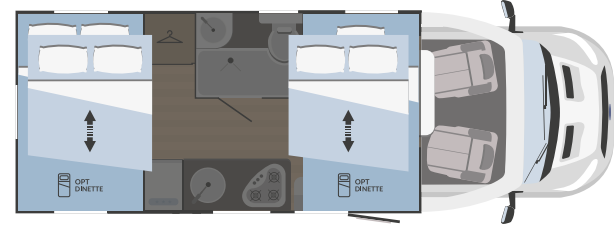
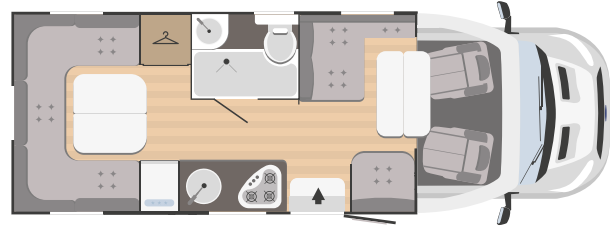

## MECHANICAL UNIT

Engine	Ford Transit
Wheelbase (mm)	3750
Displacement (L)	2,0
Maximum power (kW-HP)	96 - 130*
Radio	✓

## DIMENSIONS AND WEIGHTS

Outside length (mm)	6970
Outside width - inside width (mm)	2340 - 2200
Maximum outside height - inside height (mm)	2845 - 2060
Thickness of floor - walls - roof (mm)	56 - 30 - 30
Certified seats	5
Maximum overall weight (kg)***	3500

## BEDS

Berths	4
Optional berths	3
Assemblable single bed centre dinette optional	1040x2200
Assemblable double bed centre dinette optional	-
Assemblable double bed rear dinette optional	1400x2200
Front drop-down bed	1215x2000
Rear drop-down bed	1215x2000
Drop-down bed maximum static load capacity (kg)	250
Rear single bed	-
Rear double bed	-
Bunk bed	-
Rear drop-down double bed	-

## TANKS

Drinking water (inside)***	20 + 65 l.
Waste water tank	120 l.
Antifreeze tank	on request
Gas bottle locker	(1+1) x 11:13 kg

## EQUIPMENT

Gas heater	Combi C4
Water heater	Combi C4
Cabin swivel seats	✓
Panoramic porthole living area	-
Openable panoramic porthole low-profile models front pod	on request
Fridge	141 l.
Nr. burners hob	3
Extractor hood	on request
Oven	on request
Garage (access door dimensions) H (mm) x W (mm)	550x700
Driver's cabin blackout blind	on request
Entrance door with fly screen	on request
TV-holder	on request
Roof rack with ladder	on request
Service battery	on request
Cabin seat covers	on request
Parking feet	on request
Bicycle rack	on request
Alarm system	on request
Outside entrance door lamp	on request

\*the Ford Transit 121kW - 165 CV engine is available on request

\*\*\*for legal information about the weights see page 133

# KILIG 95 PLUS



↔  
**7308x2340**



**5**



**5**  
(1 opt)



**1050x850**



## MECHANICAL UNIT

Engine	Ford Transit
Wheelbase (mm)	3954
Displacement (L)	2,0
Maximum power (kW-HP)	96 - 130*
Radio	✓

## DIMENSIONS AND WEIGHTS

Outside length (mm)	7308
Outside width - inside width (mm)	2340 - 2200
Maximum outside height - inside height (mm)	2845 - 2060
Thickness of floor - walls - roof (mm)	56 - 30 - 30
Certified seats	5
Maximum overall weight (kg)***	3500

## BEDS

Berths	4
Optional berths	1
Assemblable single bed centre dinette optional	1040x2200
Assemblable double bed centre dinette optional	-
Assemblable double bed rear dinette optional	-
Front drop-down bed	1215x2000
Rear drop-down bed	-
Drop-down bed maximum static load capacity (kg)	250
Rear single bed	n.1 800x2025 n.1 800x2100
Rear double bed	with extension: 1900x2200
Bunk bed	-
Rear drop-down double bed	-

## TANKS

Drinking water (inside)***	20 + 65 l.
Waste water tank	120 l.
Antifreeze tank	on request
Gas bottle locker	(1+1) x 11:13 kg

## EQUIPMENT

Gas heater	Combi C4
Water heater	Combi C4
Cabin swivel seats	✓
Panoramic porthole living area	-
Openable panoramic porthole low-profile models front pod	on request
Fridge	141 l.
Nr. burners hob	3
Extractor hood	on request
Oven	on request
Garage (access door dimensions) H (mm) x W (mm)	1050x850
Driver's cabin blackout blind	on request
Entrance door with fly screen	on request
TV-holder	on request
Roof rack with ladder	on request
Service battery	on request
Cabin seat covers	on request
Parking feet	on request
Bicycle rack	on request
Alarm system	on request
Outside entrance door lamp	on request

\*the Ford Transit 121kW - 165 CV engine is available on request

\*\*\*for legal information about the weights see page 133





  
**RIMOR**

**KILIG**

77 PLUS

# Happiness like a bolt from the blue

## Choose the road to your dreams

Be amazed by the new entry with innovative design. A new range with 6 overcab and 8 low-profile models, 9 of which are compact in less than 7 metres, designed for outdoor enthusiasts, both experts and newcomers.

Every design choice aspires to offer maximum comfort and practicality. Starting with smart, durable materials: the kitchen units with soft-close drawers and XL cabinets, the kitchen top and tables in high-strength laminate. Along with design details that will make your experience even more amazing, such as the interior fittings in matt black, the kitchen sink with pull-out mixer tap and multi-purpose lid - that can be used as a chopping board, trivet or tray - flush with the cabinet.



## Sarus

Engine  
Fiat Ducato

Displacement  
2,2L



↔ from 6423  
to 7293 mm



from  
4 to 7



from 5  
to 6+1



↔ from 6423  
to 7443 mm



from  
4 to 6



from  
4 to 6



**Camper life  
has a new look**



**1** Kitchen furniture with soft-close drawers and XL cabinets with pull-out rubbish bin fitted to the door of the cupboard under the sink

**2** Interior fittings in matt black (adjustable spotlights, switches and outlets)



**3** Kitchen sink with pull-out mixer tap and multi-purpose flush lid (chopping board, trivet, tray) for an even work surface

**4** Kitchen and table tops in high-strength laminate

**5** Designer kitchen storage

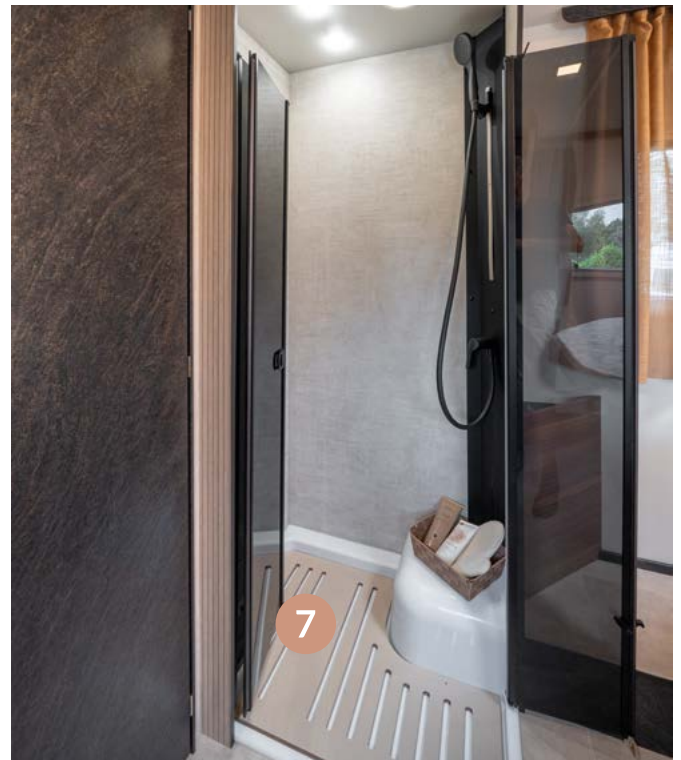

**6** Models 5 and 9 have a bathroom with pivoting wall in next-generation Ocritech® acrylic, easy to clean and disinfect, and UV-resistant for maximum durability

**7** Sarus 69 Plus bathroom with flush-mounted shower tray and modular shower door, for maximum comfort both when using the toilet and when moving to the bed



**8** Bumpers with multifunction LED lights

**9** Fairing of profiled model in soft-touch upholstery and openable skyview (optional)

- New detachable tubular garage lamp that becomes a practical inspection light
- Front drop-down bed as standard on all Plus models
- Interior height in living areas underneath the drop-down bed 185 cm
- Combi Gas heating with CP Plus digital control unit as standard
- Panoramic windows with comfortable sliding opening handle as standard





## Living area



### Front/rear facing dinette

SARUS 3  
SARUS 5

### L-shaped dinette

SARUS 8  
SARUS 695

### Double dinette

SARUS 9

### Double dinette island

SARUS 50





Double dinette





Face-to-face dinette



L-shaped dinette

## Living area



Front/rear facing dinette

SARUS 12 P

Face-to-face dinette

SARUS 66 PLUS  
SARUS 99 PLUS

Face-to-face dinette XL

SARUS 67 PLUS

L-shaped dinette

SARUS 68 PLUS  
SARUS 69 PLUS  
SARUS 95 PLUS  
SARUS 98 P



Front/rear facing dinette



Face-to-face dinette XL



Transverse bed

## Sleeping area



**French bed**  
SARUS 3

**Transverse bed**  
SARUS 5  
SARUS 8

**Bunk bed**  
SARUS 9

**Double bunk beds**  
SARUS 50

**Twin beds**  
SARUS 695



Double bunk beds



Bunk bed



French bed

## Sleeping area



### French bed

SARUS 12 P

### Central bed

SARUS 66 PLUS

SARUS 68 PLUS

SARUS 69 PLUS

### XL front drop-down bed

SARUS 67 PLUS

### Twin beds

SARUS 95 PLUS

SARUS 98 P

SARUS 99 PLUS



Central bed





Twin beds



XL front drop-down bed

## Kitchen



### Compact kitchen

SARUS 50  
SARUS 695

### Long kitchen

SARUS 3  
SARUS 8  
SARUS 9

### XL Long kitchen

SARUS 5



### Compact kitchen

SARUS 66 PLUS  
SARUS 67 PLUS  
SARUS 68 PLUS  
SARUS 69 PLUS  
SARUS 95 PLUS  
SARUS 99 PLUS

### Long kitchen

SARUS 12 P  
SARUS 98 P



Compact kitchen

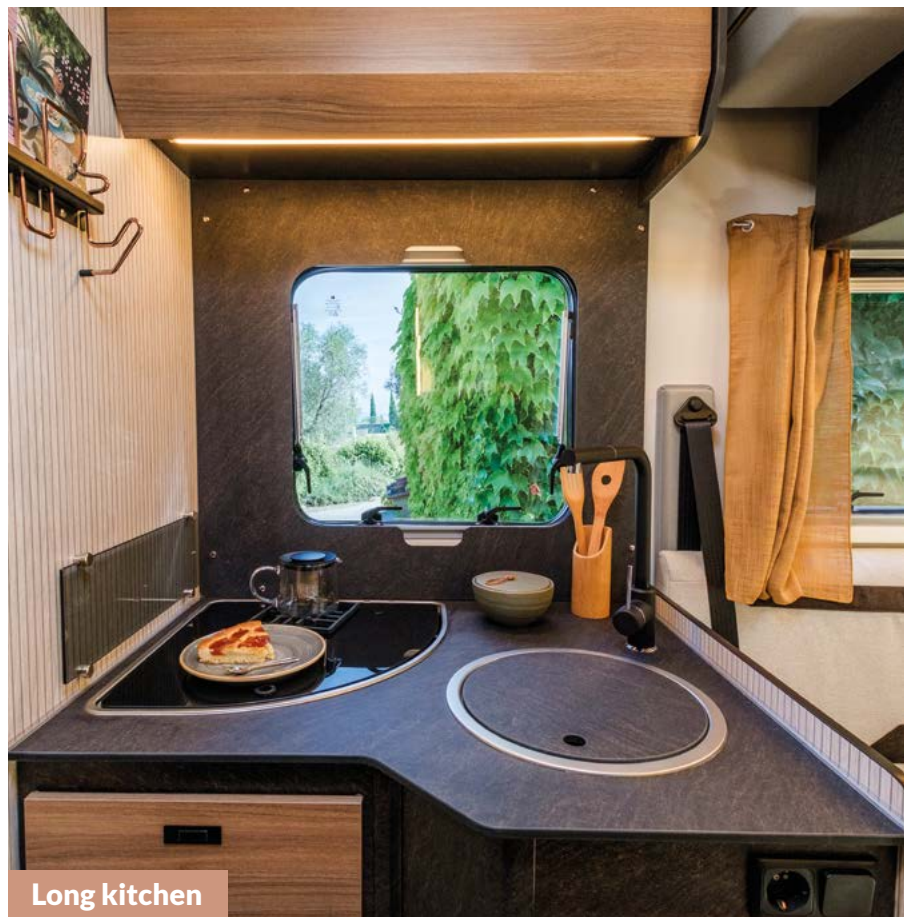

Long kitchen



XL Long kitchen



## Bathroom



Single unit with  
shower in back

SARUS 3

Single unit with  
shower alongside toilet

SARUS 8

Bathroom with shower  
that can be separated  
by a pivoting wall

SARUS 5

SARUS 9

Toilet and shower  
cubicle integrated |  
Compact

SARUS 50

Toilette e box  
doccia separati

SARUS 695

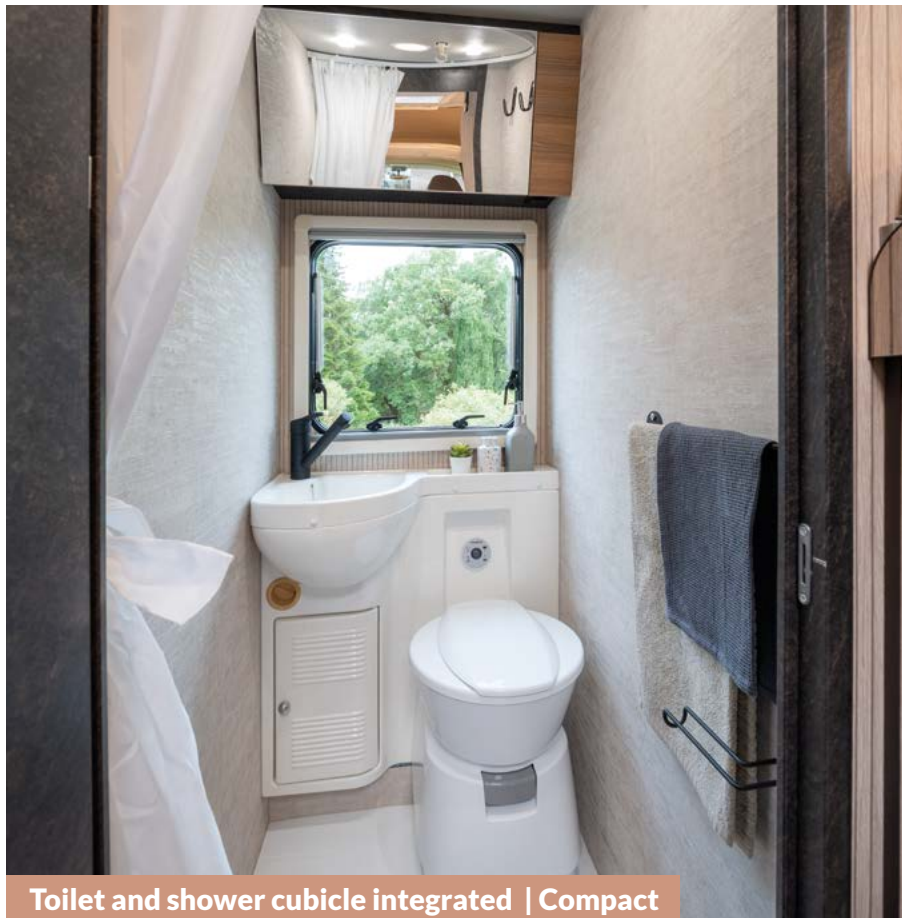

Toilet and shower cubicle integrated | Compact

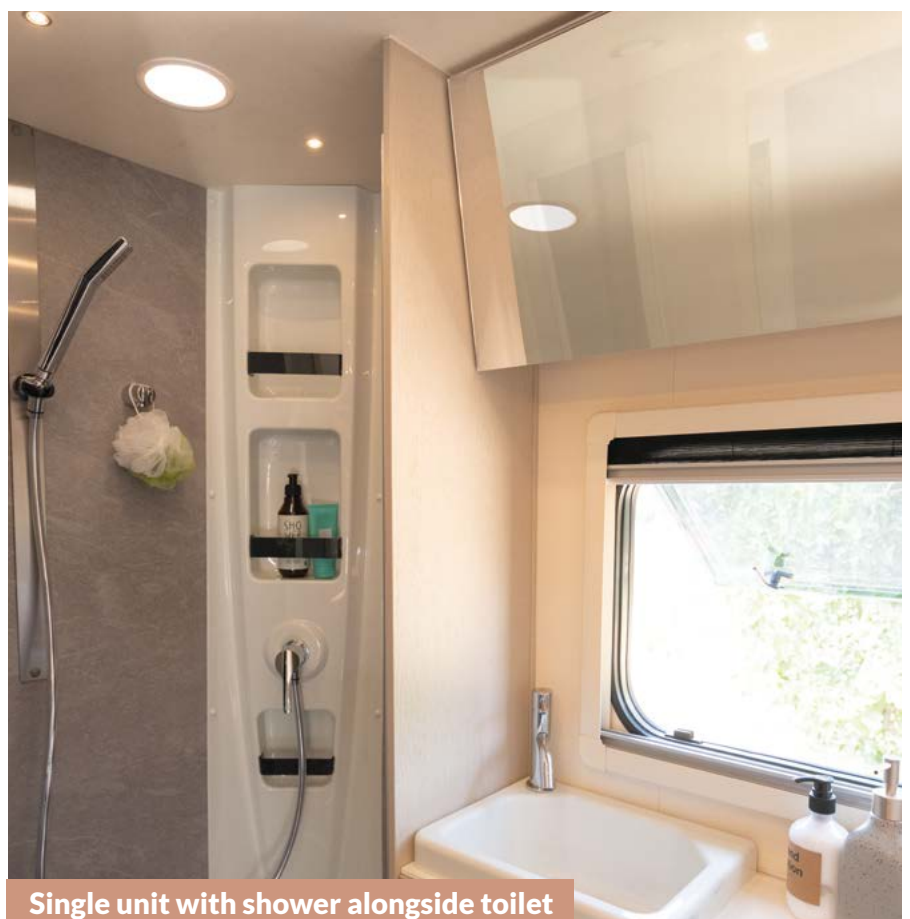

Single unit with shower alongside toilet



Bathroom with shower that can be separated by a pivoting wall

## Bathroom



**Single unit with  
shower in back**

SARUS 12 P

**Single unit with  
shower alongside  
toilet**

SARUS 98 P

**Separate toilet and  
shower cubicle**

SARUS 66 PLUS

SARUS 68 PLUS

SARUS 95 PLUS

SARUS 99 PLUS

**Full-width with  
closet**

SARUS 67 PLUS

**Flush-mounted  
shower tray and  
separate toilet with  
modular doors**

SARUS 69 PLUS

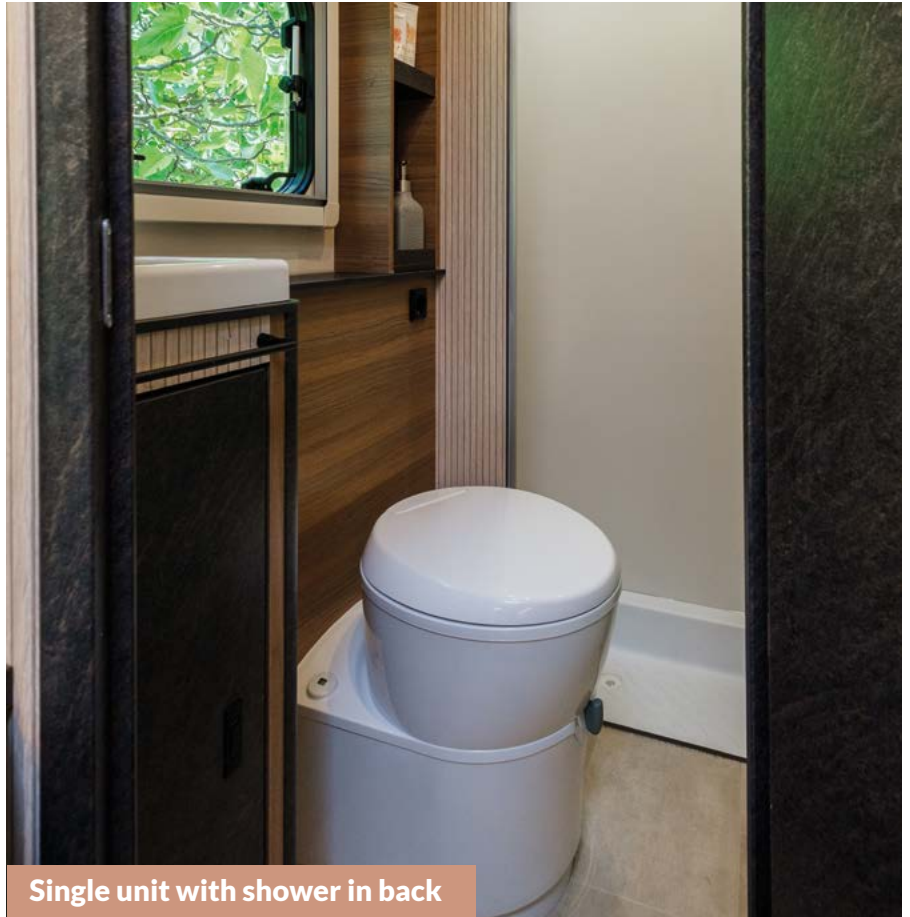

Single unit with shower in back

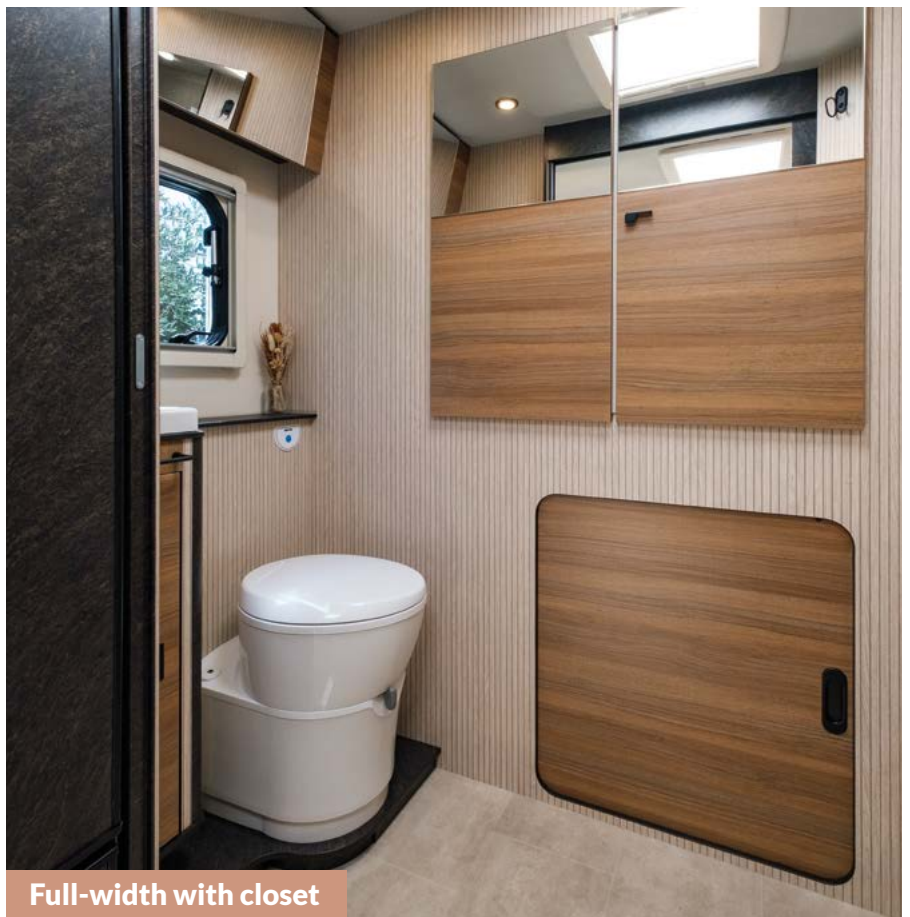

Full-width with closet



Flush-mounted shower tray and separate toilet with modular doors



Separate toilet and shower cubicle

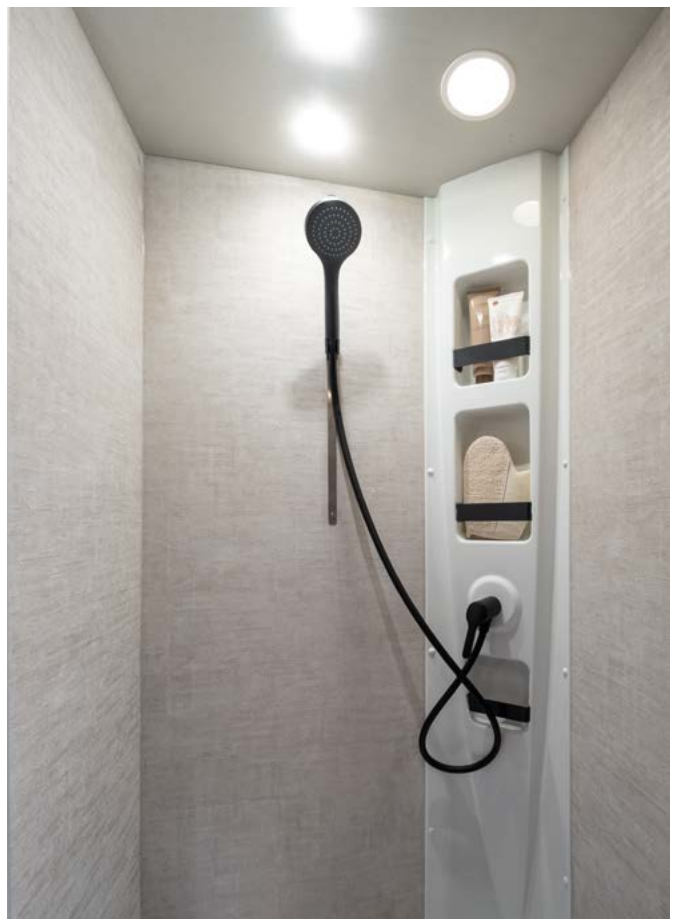

## Models and layouts

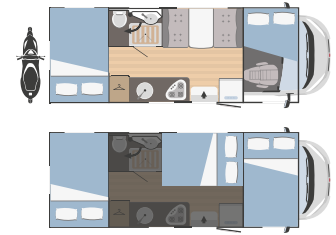
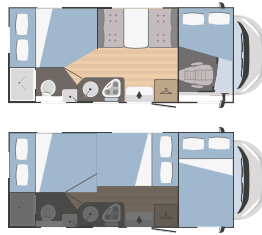

	SARUS 3	SARUS 5
↔ Outside length x width (mm)	6423x2340	6991x2340
👤 Certified seats	6	6
🛏 Berths	6 (2 opt)	6 (2 opt)
🚪 Garage (access door dimensions) H (mm) x W (mm)	450x1000	1280x850 (1080x850 opt)



	SARUS 8	SARUS 9
↔ Outside length x width (mm)	6838x2340	6964x2340
👤 Certified seats	5	6 (+1 opt 4400 kg)
🛏 Berths	5 (1 opt)	6+1 (2+1 opt)
🚪 Garage (access door dimensions) H (mm) x W (mm)	1280x850 (1080x850 opt)	1150x650



	SARUS 50	SARUS 695
↔ Outside length x width (mm)	6987x2340	7293x2340
👤 Certified seats	6	4 (+1 opt)
🛏 Berths	6	5 (1 opt)
🚪 Garage (access door dimensions) H (mm) x W (mm)	n. 2 950x1150	1050x750



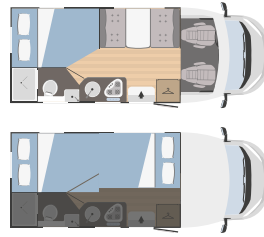

	SARUS 12 P**	SARUS 66 PLUS
↔ Outside length x width (mm)	6423x2340	7443x2340
👤 Certified seats	6	4
🛏 Berths	6 (4 opt)	4
🚪 Garage (access door dimensions) H (mm) x W (mm)	450x1000	750x770 (1200x770 opt)

\*\*also available with drop-down bed (OPT)

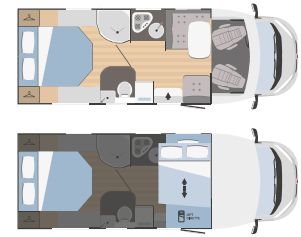

	SARUS 67 PLUS	SARUS 68 PLUS
↔ Outside length x width (mm)	6450x2340	6973x2340
👤 Certified seats	4	5
🛏 Berths	4 (2 opt)	5 (1 opt)
🚪 Garage (access door dimensions) H (mm) x W (mm)	1050x630	750x750

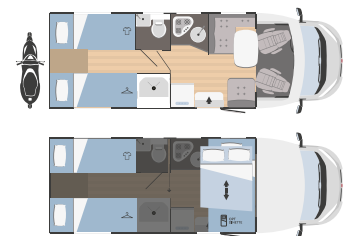
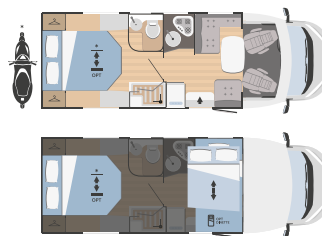

	SARUS 69 PLUS	SARUS 95 PLUS
↔ Outside length x width (mm)	7158x2340	7293x2340
👤 Certified seats	5	4 (+1 opt)
🛏 Berths	5 (1 opt)	5 (1 opt)
🚪 Garage (access door dimensions) H (mm) x W (mm)	750x750 (1200x750 opt)	1050x750

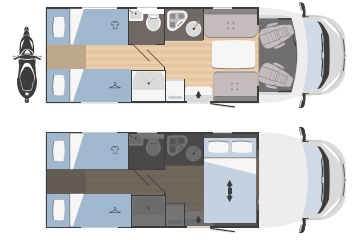

	SARUS 98 P**	SARUS 99 PLUS
↔ Outside length x width (mm)	6878x2340	7443x2340
👤 Certified seats	5	4
🛏 Berths	5 (3 opt)	4
🚪 Garage (access door dimensions) H (mm) x W (mm)	1050x850	1050x750

\*\*also available with drop-down bed (OPT)



NEW

**SARUS**  
3

**FIAT**  
PROFESSIONAL



6423x2340



6



6

(2 opt)



450x1000

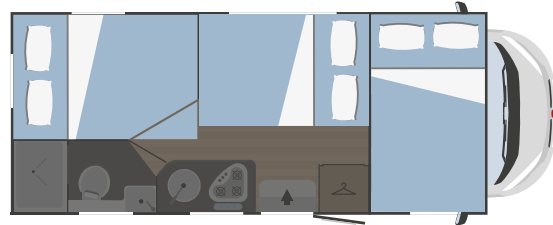
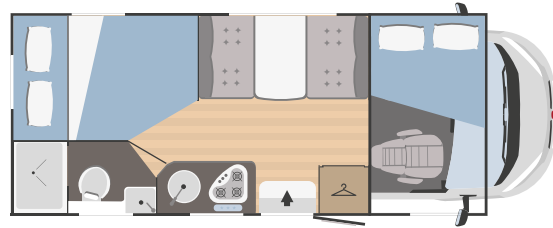

### MECHANICAL UNIT

Engine	Fiat Ducato
Wheelbase (mm)	3800
Displacement (L)	2,2
Maximum power (kW-HP)	103-140*
Radio	on request

### DIMENSIONS AND WEIGHTS

Outside length (mm)	6423
Outside width - inside width (mm)	2340 - 2200
Maximum outside height - inside height (mm)	3050 - 2075
Thickness of floor - walls - roof (mm)	56 - 30 - 30
Certified seats	6
Maximum overall weight (kg)***	3500

### BEDS

Berths	4
Optional berths	2
Overcab double bed	1400x2200
Assemblable single bed	-
centre dinette optional	-
Assemblable double bed	1290x1890
centre dinette optional	-
Assemblable double bed	-
rear dinette optional	-
Rear single bed	-
Rear double bed	1385x2056
Bunk bed	-
Rear drop-down double bed	-

### TANKS

Drinking water (inside)***	20 + 65 l.
Waste water tank	100 l.
Antifreeze tank	on request
Gas bottle locker	(1+1) x 11:13 kg

### EQUIPMENT

Gas heater	Combi C4
Water heater	Combi C4
Cabin swivel seats	✓
Panoramic porthole living area	on request
Openable panoramic porthole	-
low-profile models front pod	-
Fridge	89 l. (141 l. on request)
Nr. burners hob	3
Extractor hood	on request
Oven	on request
Garage (access door dimensions)	450x1000
H (mm) x W (mm)	-
Driver's cabin blackout blind	on request
Entrance door with fly screen	on request
TV-holder	on request
Roof rack with ladder	on request
Service battery	on request
Cabin seat covers	on request
Parking feet	on request
Bicycle rack	on request
Alarm system	on request
Outside entrance door lamp	on request

\*the Fiat Ducato 132 kW - 180 CV engine is available on request

\*\*\*for legal information about the weights see page 133

NEW

**SARUS**  
5

**FIAT**  
PROFESSIONAL



↔  
**6991x2340**

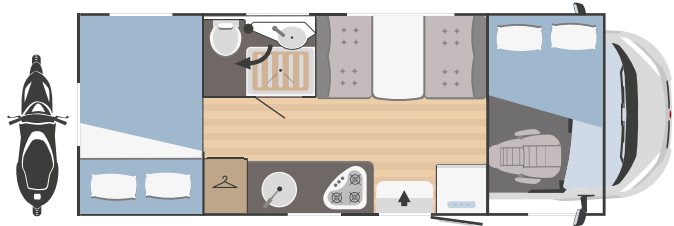

**6**



**6**

(2 opt)



**1280x850**  
(1080x850 opt)

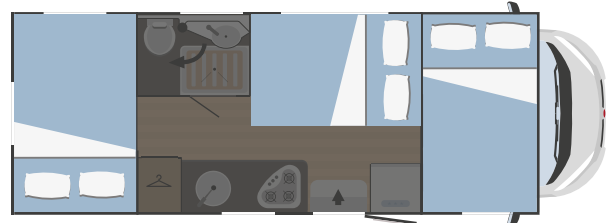

### MECHANICAL UNIT

Engine	Fiat Ducato
Wheelbase (mm)	3800
Displacement (L)	2,2
Maximum power (kW-HP)	103-140*
Radio	on request

### DIMENSIONS AND WEIGHTS

Outside length (mm)	6991
Outside width - inside width (mm)	2340 - 2200
Maximum outside height - inside height (mm)	3050 - 2075
Thickness of floor - walls - roof (mm)	56 - 30 - 30
Certified seats	6
Maximum overall weight (kg)***	3500

### BEDS

Berths	4
Optional berths	2
Overcab double bed	1400x2200
Assemblable single bed centre dinette optional	-
Assemblable double bed centre dinette optional	1280x1890
Assemblable double bed rear dinette optional	-
Rear single bed	-
Rear double bed	1360x2200
Bunk bed	-
Rear drop-down double bed	on request

### TANKS

Drinking water (inside)***	20 + 65 l.
Waste water tank	100 l.
Antifreeze tank	on request
Gas bottle locker	(1+1) x 11:13 kg

### EQUIPMENT

Gas heater	Combi C4
Water heater	Combi C4
Cabin swivel seats	✓
Panoramic porthole living area	on request
Openable panoramic porthole low-profile models front pod	-
Fridge	89 l. (141 l. on request)
Nr. burners hob	3
Extractor hood	on request
Oven	on request
Garage (access door dimensions) H (mm) x W (mm)	1280x850 (1080x850 on request)
Driver's cabin blackout blind	on request
Entrance door with fly screen	on request
TV-holder	on request
Roof rack with ladder	on request
Service battery	on request
Cabin seat covers	on request
Parking feet	on request
Bicycle rack	on request
Alarm system	on request
Outside entrance door lamp	on request

\*the Fiat Ducato 132 kW - 180 CV engine is available on request

\*\*\*for legal information about the weights see page 133

NEW

**SARUS**  
8

**FIAT**  
PROFESSIONAL



↔  
**6838x2340**

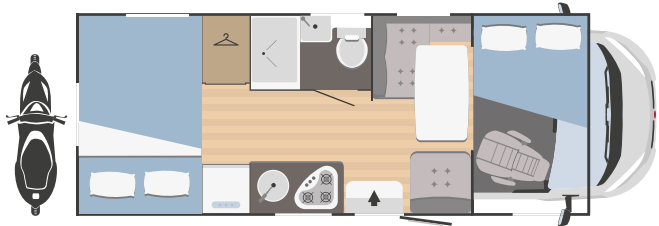

**5**



**5**  
(1 opt)



**1280x850**  
(1080x850 opt)

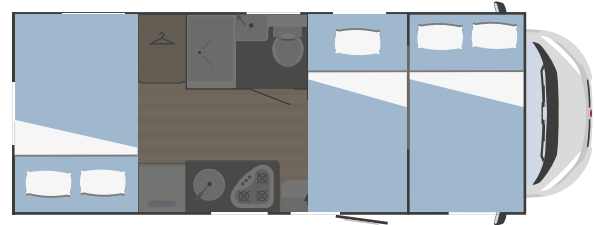

### MECHANICAL UNIT

Engine	Fiat Ducato
Wheelbase (mm)	3800
Displacement (L)	2,2
Maximum power (kW-HP)	103-140*
Radio	on request

### DIMENSIONS AND WEIGHTS

Outside length (mm)	6838
Outside width - inside width (mm)	2340 - 2200
Maximum outside height - inside height (mm)	3050 - 2075
Thickness of floor - walls - roof (mm)	56 - 30 - 30
Certified seats	5
Maximum overall weight (kg)***	3500

### BEDS

Berths	4
Optional berths	1
Overcab double bed	1400x2200
Assemblable single bed centre dinette optional	1100x2200
Assemblable double bed centre dinette optional	-
Assemblable double bed rear dinette optional	-
Rear single bed	-
Rear double bed	1356x2200
Bunk bed	-
Rear drop-down double bed	on request

### TANKS

Drinking water (inside)***	20 + 65 l.
Waste water tank	100 l.
Antifreeze tank	on request
Gas bottle locker	(1+1) x 11:13 kg

### EQUIPMENT

Gas heater	Combi C4
Water heater	Combi C4
Cabin swivel seats	✓
Panoramic porthole living area	on request
Openable panoramic porthole low-profile models front pod	-
Fridge	89 l. (141 l. on request)
Nr. burners hob	3
Extractor hood	on request
Oven	on request
Garage (access door dimensions) H (mm) x W (mm)	1280x850 (1080x850 on request)
Driver's cabin blackout blind	on request
Entrance door with fly screen	on request
TV-holder	on request
Roof rack with ladder	on request
Service battery	on request
Cabin seat covers	on request
Parking feet	on request
Bicycle rack	on request
Alarm system	on request
Outside entrance door lamp	on request

\*the Fiat Ducato 132 kW - 180 CV engine is available on request

\*\*\*for legal information about the weights see page 133

**NEW**

**SARUS**  
9

**FIAT**  
PROFESSIONAL



↔  
**6964x2340**

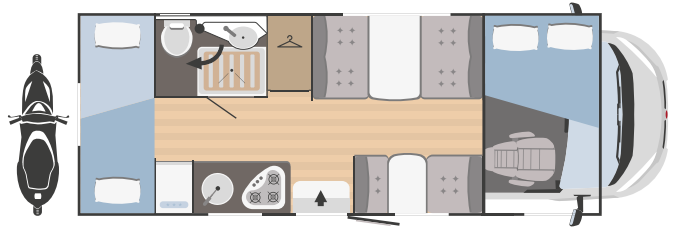

**6**  
(+1 opt  
4400 kg)



**6+1**  
(2+1 opt)



**1150x650**

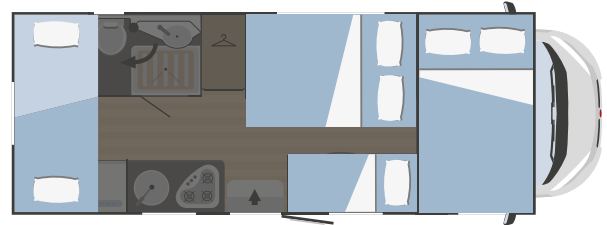

### MECHANICAL UNIT

Engine	Fiat Ducato
Wheelbase (mm)	4035
Displacement (L)	2,2
Maximum power (kW-HP)	103-140*
Radio	on request

### DIMENSIONS AND WEIGHTS

Outside length (mm)	6964
Outside width - inside width (mm)	2340 - 2200
Maximum outside height - inside height (mm)	3050 - 2075
Thickness of floor - walls - roof (mm)	56 - 30 - 30
Certified seats	6 (+1 opt 4400 kg)
Maximum overall weight (kg)***	3500

### BEDS

Berths	4
Optional berths	2+1
Overcab double bed	1400x2200
Assemblable single bed centre dinette optional	680x1430
Assemblable double bed centre dinette optional	1290x1890
Assemblable double bed rear dinette optional	-
Rear single bed	-
Rear double bed	-
Bunk bed	810x2200
Rear drop-down double bed	-

### TANKS

Drinking water (inside)***	20 + 65 l.
Waste water tank	100 l.
Antifreeze tank	on request
Gas bottle locker	(1+1) x 11:13 kg

### EQUIPMENT

Gas heater	Combi C4
Water heater	Combi C4
Cabin swivel seats	✓
Panoramic porthole living area	on request
Openable panoramic porthole low-profile models front pod	-
Fridge	141 l.
Nr. burners hob	3
Extractor hood	on request
Oven	on request
Garage (access door dimensions) H (mm) x W (mm)	1150x650
Driver's cabin blackout blind	on request
Entrance door with fly screen	on request
TV-holder	on request
Roof rack with ladder	on request
Service battery	on request
Cabin seat covers	on request
Parking feet	on request
Bicycle rack	on request
Alarm system	on request
Outside entrance door lamp	on request

\*the Fiat Ducato 132 kW - 180 CV engine is available on request

\*\*\*for legal information about the weights see page 133

NEW

**SARUS**  
50

**FIAT**  
PROFESSIONAL



6987x2340



6



6



n.2 950x1150

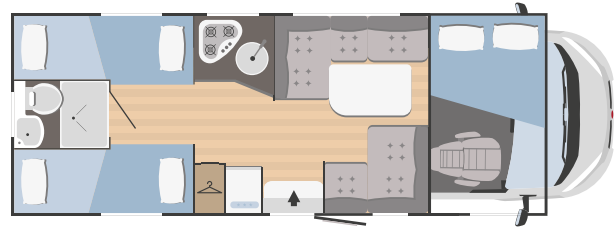

### MECHANICAL UNIT

Engine	Fiat Ducato
Wheelbase (mm)	4035
Displacement (L)	2,2
Maximum power (kW-HP)	103-140*
Radio	on request

### DIMENSIONS AND WEIGHTS

Outside length (mm)	6987
Outside width - inside width (mm)	2340 - 2200
Maximum outside height - inside height (mm)	3050 - 2075
Thickness of floor - walls - roof (mm)	56 - 30 - 30
Certified seats	6
Maximum overall weight (kg)***	3500

### BEDS

Berths	6
Optional berths	-
Overcab double bed	1400x2200
Assemblable single bed centre dinette optional	-
Assemblable double bed centre dinette optional	-
Assemblable double bed rear dinette optional	-
Rear single bed	-
Rear double bed	-
Bunk bed	n.2 710x1900
Rear drop-down double bed	-

### TANKS

Drinking water (inside)***	20 + 65 l.
Waste water tank	100 l.
Antifreeze tank	on request
Gas bottle locker	(1+1) x 11:13 kg

### EQUIPMENT

Gas heater	Combi C4
Water heater	Combi C4
Cabin swivel seats	✓
Panoramic porthole living area	on request
Openable panoramic porthole low-profile models front pod	-
Fridge	141 l.
Nr. burners hob	3
Extractor hood	on request
Oven	on request
Garage (access door dimensions) H (mm) x W (mm)	n.2 950x1150
Driver's cabin blackout blind	on request
Entrance door with fly screen	on request
TV-holder	on request
Roof rack with ladder	on request
Service battery	on request
Cabin seat covers	on request
Parking feet	on request
Bicycle rack	on request
Alarm system	on request
Outside entrance door lamp	on request

\*the Fiat Ducato 132 kW - 180 CV engine is available on request

\*\*\*for legal information about the weights see page 133



**NEW**

**SARUS**  
695

**FIAT**  
PROFESSIONAL



**7293x2340**

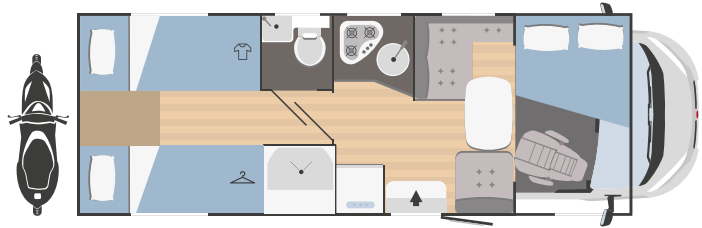

**4**

(+1 opt)



**5**

(1 opt)



**1050x750**

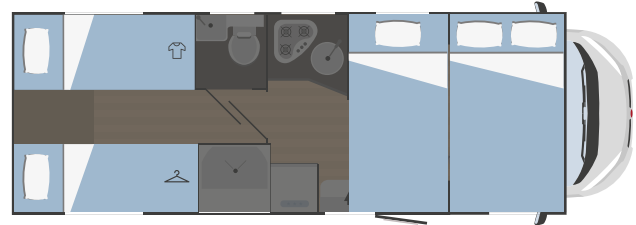

### MECHANICAL UNIT

Engine	Fiat Ducato
Wheelbase (mm)	4035
Displacement (L)	2,2
Maximum power (kW-HP)	103-140*
Radio	on request

### DIMENSIONS AND WEIGHTS

Outside length (mm)	7293
Outside width - inside width (mm)	2340 - 2200
Maximum outside height - inside height (mm)	3050 - 2075
Thickness of floor - walls - roof (mm)	56 - 30 - 30
Certified seats	4 (+1 opt)
Maximum overall weight (kg)***	3500

### BEDS

Berths	4
Optional berths	1
Overcab double bed	1400x2200
Assemblable single bed centre dinette optional	1100x2200
Assemblable double bed centre dinette optional	-
Assemblable double bed rear dinette optional	-
Rear single bed	n.1 800x1975 n. 1 750x2040
Rear double bed	with extension: 1900x2200
Bunk bed	-
Rear drop-down double bed	-

### TANKS

Drinking water (inside)***	20 + 65 l.
Waste water tank	100 l.
Antifreeze tank	on request
Gas bottle locker	(1+1) x 11:13 kg

### EQUIPMENT

Gas heater	Combi C4
Water heater	Combi C4
Cabin swivel seats	✓
Panoramic porthole living area	on request
Openable panoramic porthole low-profile models front pod	-
Fridge	89 l. (141 l. on request)
Nr. burners hob	3
Extractor hood	on request
Oven	on request
Garage (access door dimensions) H (mm) x W (mm)	1050x750
Driver's cabin blackout blind	on request
Entrance door with fly screen	on request
TV-holder	on request
Roof rack with ladder	on request
Service battery	on request
Cabin seat covers	on request
Parking feet	on request
Bicycle rack	on request
Alarm system	on request
Outside entrance door lamp	on request

\*the Fiat Ducato 132 kW - 180 CV engine is available on request

\*\*\*for legal information about the weights see page 133

**NEW**

**SARUS** \*\*  
12 P

**FIAT**  
PROFESSIONAL



↔  
**6423x2340**



**6**



**6**

(4 opt)



**450x1000**

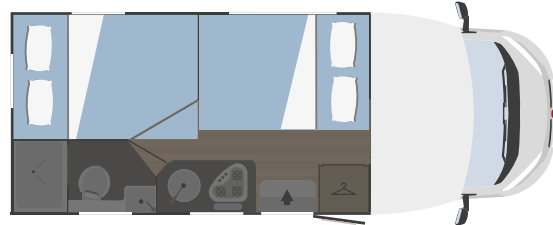
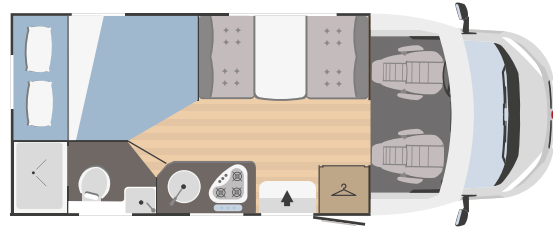

### MECHANICAL UNIT

Engine	Fiat Ducato
Wheelbase (mm)	3800
Displacement (L)	2,2
Maximum power (kW-HP)	103-140*
Radio	on request

### DIMENSIONS AND WEIGHTS

Outside length (mm)	6423
Outside width - inside width (mm)	2340 - 2200
Maximum outside height - inside height (mm)	2940 - 2075
Thickness of floor - walls - roof (mm)	56 - 30 - 30
Certified seats	6
Maximum overall weight (kg)***	3500

### BEDS

Berths	2
Optional berths	4
Assemblable single bed	-
centre dinette optional	-
Assemblable double bed	1290x1890
centre dinette optional	-
Assemblable double bed	-
rear dinette optional	-
Optional front drop-down bed	1380x2000
Drop-down bed maximum static load capacity (kg)	250
Rear single bed	-
Rear double bed	1385x2056
Bunk bed	-
Rear drop-down double bed	-

### TANKS

Drinking water (inside)***	20 + 65 l.
Waste water tank	100 l.
Antifreeze tank	on request
Gas bottle locker	(1+1) x 11:13 kg

### EQUIPMENT

Gas heater	Combi C4
Water heater	Combi C4
Cabin swivel seats	✓
Panoramic porthole living area	on request
Openable panoramic porthole	on request
low-profile models front pod	on request
Fridge	89 l. (141 l. on request)
Nr. burners hob	3
Extractor hood	on request
Oven	on request
Garage (access door dimensions) H (mm) x W (mm)	450x1000
Driver's cabin blackout blind	on request
Entrance door with fly screen	on request
TV-holder	on request
Roof rack with ladder	on request
Service battery	on request
Cabin seat covers	on request
Parking feet	on request
Bicycle rack	on request
Alarm system	on request
Outside entrance door lamp	on request

\*the Fiat Ducato 132 kW - 180 CV engine is available on request

\*\*also available with drop-down bed (OPT)

\*\*\*for legal information about the weights see page 133

NEW

**SARUS**  
66 PLUS

**FIAT**  
PROFESSIONAL



↔  
**7443x2340**

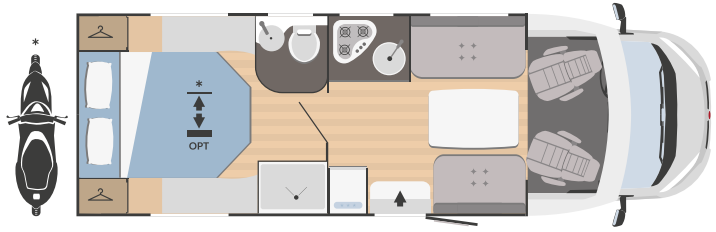

4



4



**750x770**  
(1200x770 opt)

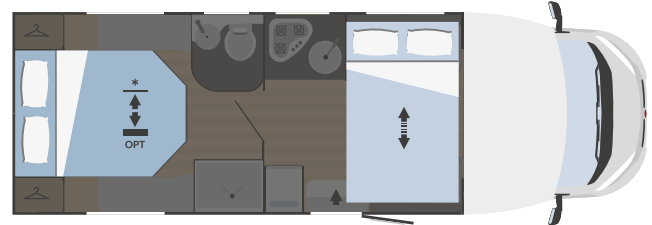

### MECHANICAL UNIT

Engine	Fiat Ducato
Wheelbase (mm)	4035
Displacement (L)	2,2
Maximum power (kW-HP)	103-140*
Radio	on request

### DIMENSIONS AND WEIGHTS

Outside length (mm)	7443
Outside width - inside width (mm)	2340 - 2200
Maximum outside height - inside height (mm)	2940 - 2075
Thickness of floor - walls - roof (mm)	56 - 30 - 30
Certified seats	4
Maximum overall weight (kg)***	3500

### BEDS

Berths	4
Optional berths	-
Assemblable single bed	-
centre dinette optional	-
Assemblable double bed	-
centre dinette optional	-
Assemblable double bed	-
rear dinette optional	-
Front drop-down bed	1220x2000
Drop-down bed maximum static load capacity (kg)	250
Rear single bed	-
Rear double bed	1400x1900
Bunk bed	-
Rear drop-down double bed	on request

### TANKS

Drinking water (inside)***	20 + 60 l.
Waste water tank	100 l.
Antifreeze tank	on request
Gas bottle locker	(1+1) x 11:13 kg

### EQUIPMENT

Gas heater	Combi C4
Water heater	Combi C4
Cabin swivel seats	✓
Panoramic porthole living area	-
Openable panoramic porthole	on request
low-profile models front pod	on request
Fridge	141 l.
Nr. burners hob	3
Extractor hood	on request
Oven	on request
Garage (access door dimensions) H (mm) x W (mm)	750x770 (1200x770)
Driver's cabin blackout blind	on request
Entrance door with fly screen	on request
TV-holder	on request
Roof rack with ladder	on request
Service battery	on request
Cabin seat covers	on request
Parking feet	on request
Bicycle rack	on request
Alarm system	on request
Outside entrance door lamp	on request

\*the Fiat Ducato 132 kW - 180 CV engine is available on request

\*\*\*for legal information about the weights see page 133

NEW

**SARUS**  
67 PLUS

**FIAT**  
PROFESSIONAL



↔  
**6450x2340**

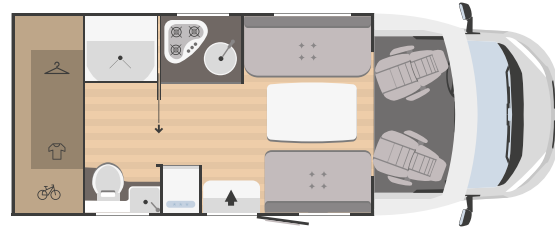

**4**



**4**  
(2 opt)



**1050x630**

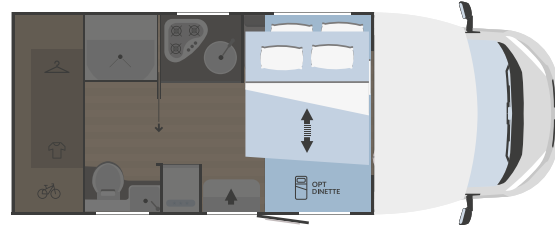

### MECHANICAL UNIT

Engine	Fiat Ducato
Wheelbase (mm)	4035
Displacement (L)	2,2
Maximum power (kW-HP)	103-140*
Radio	on request

### DIMENSIONS AND WEIGHTS

Outside length (mm)	6450
Outside width - inside width (mm)	2340 - 2200
Maximum outside height - inside height (mm)	2940 - 2075
Thickness of floor - walls - roof (mm)	56 - 30 - 30
Certified seats	4
Maximum overall weight (kg)***	3500

### BEDS

Berths	2
Optional berths	2
Assemblable single bed centre dinette optional	-
Assemblable double bed centre dinette optional	1400x2200
Assemblable double bed rear dinette optional	-
Front drop-down bed	1370x2000
Drop-down bed maximum static load capacity (kg)	250
Rear single bed	-
Rear double bed	-
Bunk bed	-
Rear drop-down double bed	-

### TANKS

Drinking water (inside)***	20 + 60 l.
Waste water tank	100 l.
Antifreeze tank	on request
Gas bottle locker	(1+1) x 11:13 kg

### EQUIPMENT

Gas heater	Combi C4
Water heater	Combi C4
Cabin swivel seats	✓
Panoramic porthole living area	-
Openable panoramic porthole low-profile models front pod	on request
Fridge	141 l.
Nr. burners hob	3
Extractor hood	on request
Oven	on request
Garage (access door dimensions) H (mm) x W (mm)	1050x630
Driver's cabin blackout blind	on request
Entrance door with fly screen	on request
TV-holder	on request
Roof rack with ladder	on request
Service battery	on request
Cabin seat covers	on request
Parking feet	on request
Bicycle rack	on request
Alarm system	on request
Outside entrance door lamp	on request

\*the Fiat Ducato 132 kW - 180 CV engine is available on request

\*\*\*for legal information about the weights see page 133

**NEW**

**SARUS**  
68 PLUS

**FIAT**  
PROFESSIONAL



↔  
**6973x2340**

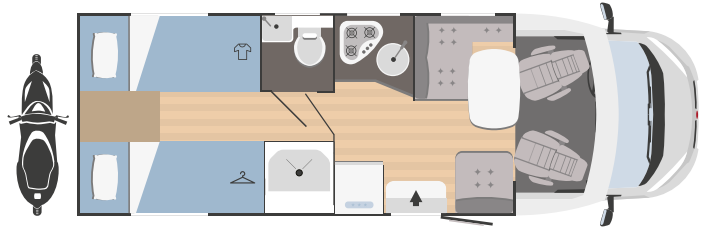

**5**



**5**  
(1 opt)



**750x750**

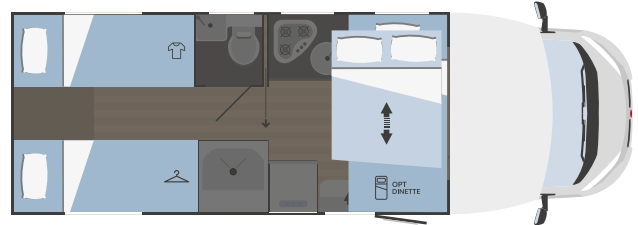

### MECHANICAL UNIT

Engine	Fiat Ducato
Wheelbase (mm)	3800
Displacement (L)	2,2
Maximum power (kW-HP)	103-140*
Radio	on request

### DIMENSIONS AND WEIGHTS

Outside length (mm)	6973
Outside width - inside width (mm)	2340 - 2200
Maximum outside height - inside height (mm)	2940 - 2075
Thickness of floor - walls - roof (mm)	56 - 30 - 30
Certified seats	5
Maximum overall weight (kg)***	3500

### BEDS

Berths	4
Optional berths	1
Assemblable single bed centre dinette optional	1050x2200
Assemblable double bed centre dinette optional	-
Assemblable double bed rear dinette optional	-
Front drop-down bed	1220x2000
Drop-down bed maximum static load capacity (kg)	250
Rear single bed	-
Rear double bed	1400x1880
Bunk bed	-
Rear drop-down double bed	-

### TANKS

Drinking water (inside)***	20 + 65 l.
Waste water tank	100 l.
Antifreeze tank	on request
Gas bottle locker	(1+1) x 11:13 kg

### EQUIPMENT

Gas heater	Combi C4
Water heater	Combi C4
Cabin swivel seats	✓
Panoramic porthole living area	-
Openable panoramic porthole low-profile models front pod	on request
Fridge	141 l.
Nr. burners hob	3
Extractor hood	on request
Oven	on request
Garage (access door dimensions) H (mm) x W (mm)	750x750
Driver's cabin blackout blind	on request
Entrance door with fly screen	on request
TV-holder	on request
Roof rack with ladder	on request
Service battery	on request
Cabin seat covers	on request
Parking feet	on request
Bicycle rack	on request
Alarm system	on request
Outside entrance door lamp	on request

\*the Fiat Ducato 132 kW - 180 CV engine is available on request

\*\*\*for legal information about the weights see page 133

NEW

**SARUS**  
69 PLUS

**FIAT**  
PROFESSIONAL



↔  
**7158x2340**

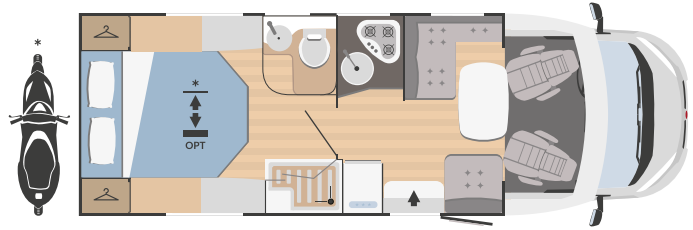

**5**



**5**  
(1 opt)



**750x750**  
(1200x750 opt)

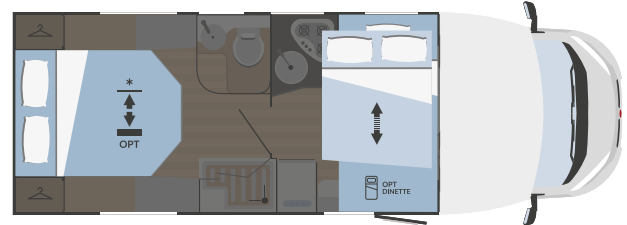

### MECHANICAL UNIT

Engine	Fiat Ducato
Wheelbase (mm)	4035
Displacement (L)	2,2
Maximum power (kW-HP)	103-140*
Radio	on request

### DIMENSIONS AND WEIGHTS

Outside length (mm)	7158
Outside width - inside width (mm)	2340 - 2200
Maximum outside height - inside height (mm)	2940 - 2075
Thickness of floor - walls - roof (mm)	56 - 30 - 30
Certified seats	5
Maximum overall weight (kg)***	3500

### BEDS

Berths	4
Optional berths	1
Assemblable single bed centre dinette optional	1100x2200
Assemblable double bed centre dinette optional	-
Assemblable double bed rear dinette optional	-
Front drop-down bed	1220x2000
Drop-down bed maximum static load capacity (kg)	250
Rear single bed	-
Rear double bed	1400x1900
Bunk bed	-
Rear drop-down double bed	on request

### TANKS

Drinking water (inside)***	20 + 60 l.
Waste water tank	100 l.
Antifreeze tank	on request
Gas bottle locker	(1+1) x 11:13 kg

### EQUIPMENT

Gas heater	Combi C4
Water heater	Combi C4
Cabin swivel seats	✓
Panoramic porthole living area	-
Openable panoramic porthole low-profile models front pod	on request
Fridge	141 l.
Nr. burners hob	3
Extractor hood	on request
Oven	on request
Garage (access door dimensions) H (mm) x W (mm)	750x750 (1200x750 on request)
Driver's cabin blackout blind	on request
Entrance door with fly screen	on request
TV-holder	on request
Roof rack with ladder	on request
Service battery	on request
Cabin seat covers	on request
Parking feet	on request
Bicycle rack	on request
Alarm system	on request
Outside entrance door lamp	on request

\*the Fiat Ducato 132 kW - 180 CV engine is available on request

\*\*\*for legal information about the weights see page 133

NEW

**SARUS**  
95 PLUS

**FIAT**  
PROFESSIONAL



↔  
**7293x2340**

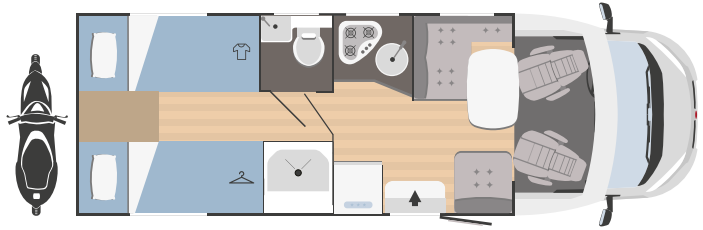

**4**  
(+1 opt)



**5**  
(1 opt)



**1050x750**

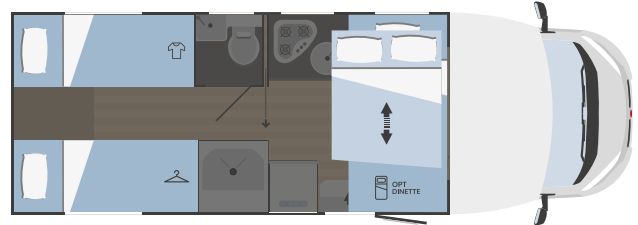

### MECHANICAL UNIT

Engine	Fiat Ducato
Wheelbase (mm)	4035
Displacement (L)	2,2
Maximum power (kW-HP)	103-140*
Radio	on request

### DIMENSIONS AND WEIGHTS

Outside length (mm)	7293
Outside width - inside width (mm)	2340 - 2200
Maximum outside height - inside height (mm)	2940 - 2075
Thickness of floor - walls - roof (mm)	56 - 30 - 30
Certified seats	4 (+1 opt)
Maximum overall weight (kg)***	3500

### BEDS

Berths	4
Optional berths	1
Assemblable single bed centre dinette optional	1100x2200
Assemblable double bed centre dinette optional	-
Assemblable double bed rear dinette optional	-
Front drop-down bed	1220x2000
Drop-down bed maximum static load capacity (kg)	250
Rear single bed	n. 1 800x1975
Rear double bed	n.1 750x2040
Rear double bed with extension:	1900x2200
Bunk bed	-
Rear drop-down double bed	-

### TANKS

Drinking water (inside)***	20 + 65 l.
Waste water tank	100 l.
Antifreeze tank	on request
Gas bottle locker	(1+1) x 11:13 kg

### EQUIPMENT

Gas heater	Combi C4
Water heater	Combi C4
Cabin swivel seats	✓
Panoramic porthole living area	-
Openable panoramic porthole low-profile models front pod	on request
Fridge	89 l. (141 l. on request)
Nr. burners hob	3
Extractor hood	on request
Oven	on request
Garage (access door dimensions) H (mm) x W (mm)	1050x750
Driver's cabin blackout blind	on request
Entrance door with fly screen	on request
TV-holder	on request
Roof rack with ladder	on request
Service battery	on request
Cabin seat covers	on request
Parking feet	on request
Bicycle rack	on request
Alarm system	on request
Outside entrance door lamp	on request

\*the Fiat Ducato 132 kW - 180 CV engine is available on request

\*\*\*for legal information about the weights see page 133

NEW

**SARUS** \*\*  
98 P

**FIAT**  
PROFESSIONAL



↔  
**6878x2340**

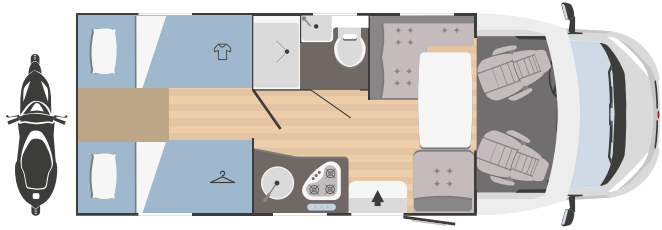

**5**



**5**  
(3 opt)



**1050x850**

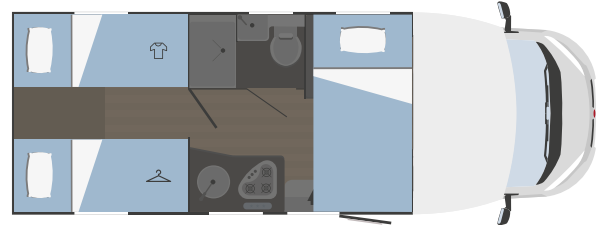

### MECHANICAL UNIT

Engine	Fiat Ducato
Wheelbase (mm)	3800
Displacement (L)	2,2
Maximum power (kW-HP)	103-140*
Radio	on request

### DIMENSIONS AND WEIGHTS

Outside length (mm)	6878
Outside width - inside width (mm)	2340 - 2200
Maximum outside height - inside height (mm)	2940 - 2075
Thickness of floor - walls - roof (mm)	56 - 30 - 30
Certified seats	5
Maximum overall weight (kg)***	3500

### BEDS

Berths	2
Optional berths	3
Assemblable single bed	1170x2200
centre dinette optional	-
Assemblable double bed	-
centre dinette optional	-
Assemblable double bed	-
rear dinette optional	-
Optional front drop-down bed	1300x2000
Drop-down bed maximum static load capacity (kg)	250
Rear single bed	n.2 750x1930
Rear double bed	with extension: 1500x2200
Bunk bed	-
Rear drop-down double bed	-

### TANKS

Drinking water (inside)***	20 + 65 l.
Waste water tank	100 l.
Antifreeze tank	on request
Gas bottle locker	(1+1) x 11:13 kg

### EQUIPMENT

Gas heater	Combi C4
Water heater	Combi C4
Cabin swivel seats	✓
Panoramic porthole living area	-
Openable panoramic porthole	on request
low-profile models front pod	on request
Fridge	89 l.
Nr. burners hob	3
Extractor hood	on request
Oven	-
Garage (access door dimensions) H (mm) x W (mm)	1050x850
Driver's cabin blackout blind	on request
Entrance door with fly screen	on request
TV-holder	on request
Roof rack with ladder	on request
Service battery	on request
Cabin seat covers	on request
Parking feet	on request
Bicycle rack	on request
Alarm system	on request
Outside entrance door lamp	on request

\*the Fiat Ducato 132 kW - 180 CV engine is available on request

\*\*also available with drop-down bed (OPT)

\*\*\*for legal information about the weights see page 133



**NEW**

**SARUS**  
99 PLUS

**FIAT**  
PROFESSIONAL



↔  
**7443x2340**

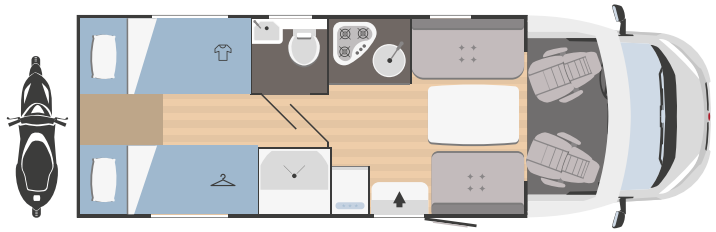

**4**



**4**



**1050x750**

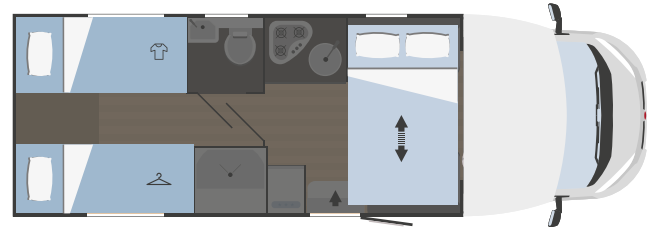

### MECHANICAL UNIT

Engine	Fiat Ducato
Wheelbase (mm)	4035
Displacement (L)	2,2
Maximum power (kW-HP)	103-140*
Radio	on request

### DIMENSIONS AND WEIGHTS

Outside length (mm)	7443
Outside width - inside width (mm)	2340 - 2200
Maximum outside height - inside height (mm)	2940 - 2075
Thickness of floor - walls - roof (mm)	56 - 30 - 30
Certified seats	4
Maximum overall weight (kg)***	3500

### BEDS

Berths	4
Optional berths	-
Assemblable single bed	-
centre dinette optional	-
Assemblable double bed	-
centre dinette optional	-
Assemblable double bed	-
rear dinette optional	-
Front drop-down bed	1220x2000
Drop-down bed maximum static load capacity (kg)	250
Rear single bed	n. 1 800x1900
	n.1 750x1980
Rear double bed	with extension: 1900x2200
Bunk bed	-
Rear drop-down double bed	-

### TANKS

Drinking water (inside)***	20 + 60 l.
Waste water tank	100 l.
Antifreeze tank	on request
Gas bottle locker	(1+1) x 11:13 kg

### EQUIPMENT

Gas heater	Combi C4
Water heater	Combi C4
Cabin swivel seats	✓
Panoramic porthole living area	-
Openable panoramic porthole	on request
low-profile models front pod	on request
Fridge	141 l.
Nr. burners hob	3
Extractor hood	on request
Oven	on request
Garage (access door dimensions) H (mm) x W (mm)	1050x750
Driver's cabin blackout blind	on request
Entrance door with fly screen	on request
TV-holder	on request
Roof rack with ladder	on request
Service battery	on request
Cabin seat covers	on request
Parking feet	on request
Bicycle rack	on request
Alarm system	on request
Outside entrance door lamp	on request

\*the Fiat Ducato 132 kW - 180 CV engine is available on request

\*\*\*for legal information about the weights see page 133



# The great flagship vehicle in its best ever version

## Unrivalled liveability and a feeling of luxury in true nautical style

The feeling of travelling in the luxury of a ship, the comfort of doing it on the road. All this is possible with Super Brig, the Rimor flagship vehicle created by the founder, Luano Niccolai. Even more so today, thanks to the new 87 Plus and 687 TC versions, with maximised liveability even in under 7 metres (6.8 m). Super Brig offers top of the range fittings, with 6 models between low-profile and overcab, top quality materials and spacious living areas.

No need for compromise with sleeping solutions for full living comfort: double, transverse, suite and twin beds that can be converted into king size, as well as a front drop-down bed as standard in the low-profile models and a new bathroom for the 69 Plus model. The equipment includes adjustable headrests, 153-litre refrigerator column and pull-out mixer tap for the kitchen sink, deluxe upholstery and an opening XL panoramic window in the overcab. The Suite model, with double dinette, has a spacious kitchen with combi-oven with grill and hob for the ultimate en plein air experience.



## Super Brig

Engine  
Fiat Ducato

Displacement  
2,2L



from 6838  
to 7293 mm



from 6838  
to 7293 mm





**Your new  
camper life  
starts with this**

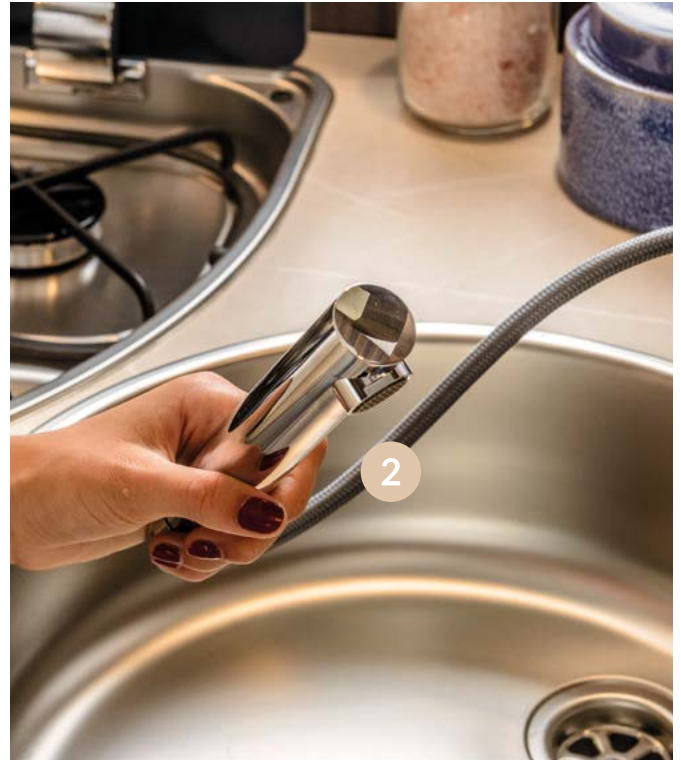

- 1 **Combi-oven with grill and hob** on the Suite model
- 2 **Pull-out kitchen sink mixer tap**

- 3 **153 L refrigerator column** which can be opened from both sides (except in Super Brig 69 Plus)
- 4 **Cleverly-designed kitchen** with integrated double-level drawer

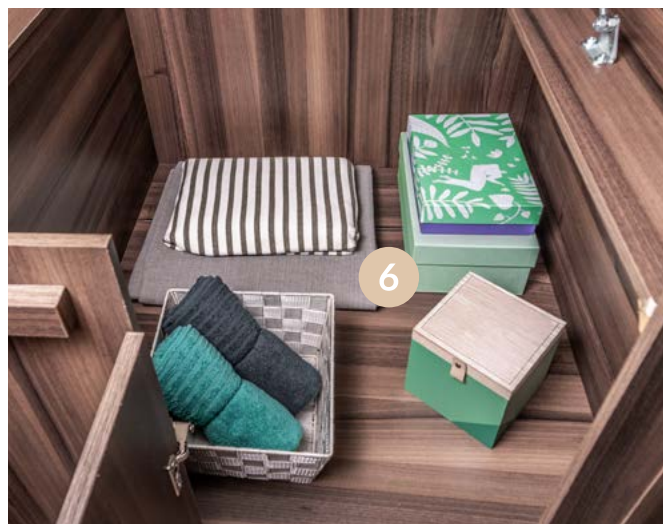

**5 Wardrobes for hanging garments** (except in the 95 Plus and 695 models)

**6 Twin beds with pneumatic slatted bases and storage compartments** on 95 Plus and 695 models

**7 Bright overcab with deluxe lining**



**8** New top of the range equipment, with internal frame and practical sliding blind with integrated fly-screen

**9** New rear bumpers

- Combi C6 Gas heating with CP Plus digital control unit as standard
- Front drop-down bed as standard on all low-profile models
- Interior height underneath the drop-down bed 200 cm
- Overcab bed with pneumatic slatted bases
- USB outlets in both living and sleeping areas
- 3-burner cooker hob
- Cabinets with damper hinges

## Living area



### L-shaped dinette

SUPER BRIG 687 TC  
SUPER BRIG 695 TC

### Double dinette

SUPER BRIG SUITE



### L-shaped dinette

SUPER BRIG 69 PLUS  
SUPER BRIG 87 PLUS  
SUPER BRIG 95 PLUS







L-shaped dinette





Twin beds

## Sleeping area



Transverse bed  
SUPER BRIG 687 TC

Twin beds  
SUPER BRIG 695 TC

Rear suite bed  
SUPER BRIG SUITE



Rear suite bed





Transverse bed

## Sleeping area



**Central bed**  
SUPER BRIG 69 PLUS

**Transverse bed**  
SUPER BRIG 87 PLUS

**Twin beds**  
SUPER BRIG 95 PLUS

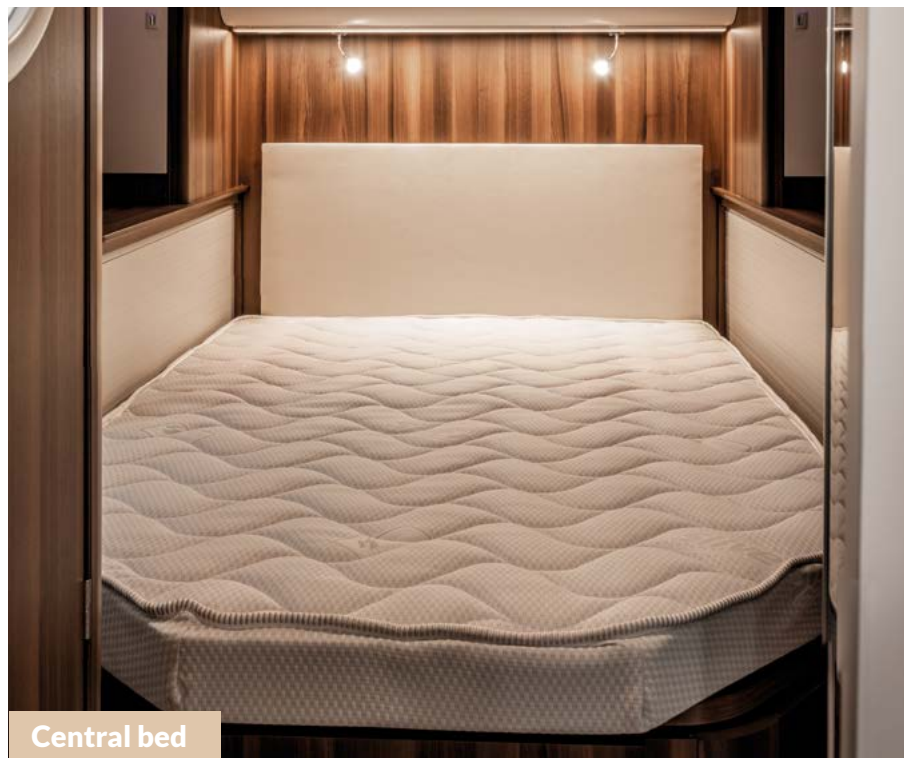

Central bed



## Kitchen



Compact kitchen  
SUPER BRIG 695

Long kitchen  
SUPER BRIG 687 TC

Combined kitchen  
SUPER BRIG SUITE



Compact kitchen



Combined kitchen





Long kitchen



## Kitchen



### Compact kitchen

SUPER BRIG 69 PLUS  
SUPER BRIG 95 PLUS

### Long kitchen

SUPER BRIG 87 PLUS

## Bathroom



Single unit with  
shower alongside  
toilet

SUPER BRIG 687 TC  
SUPER BRIG SUITE

Separate toilet and  
shower cubicle

SUPER BRIG 695



Single unit with  
shower alongside  
toilet

SUPER BRIG 87 PLUS

Flush-mounted  
shower tray and  
separate toilet with  
modular doors

SUPER BRIG 69 PLUS

Separate toilet and  
shower cubicle

SUPER BRIG 95 PLUS

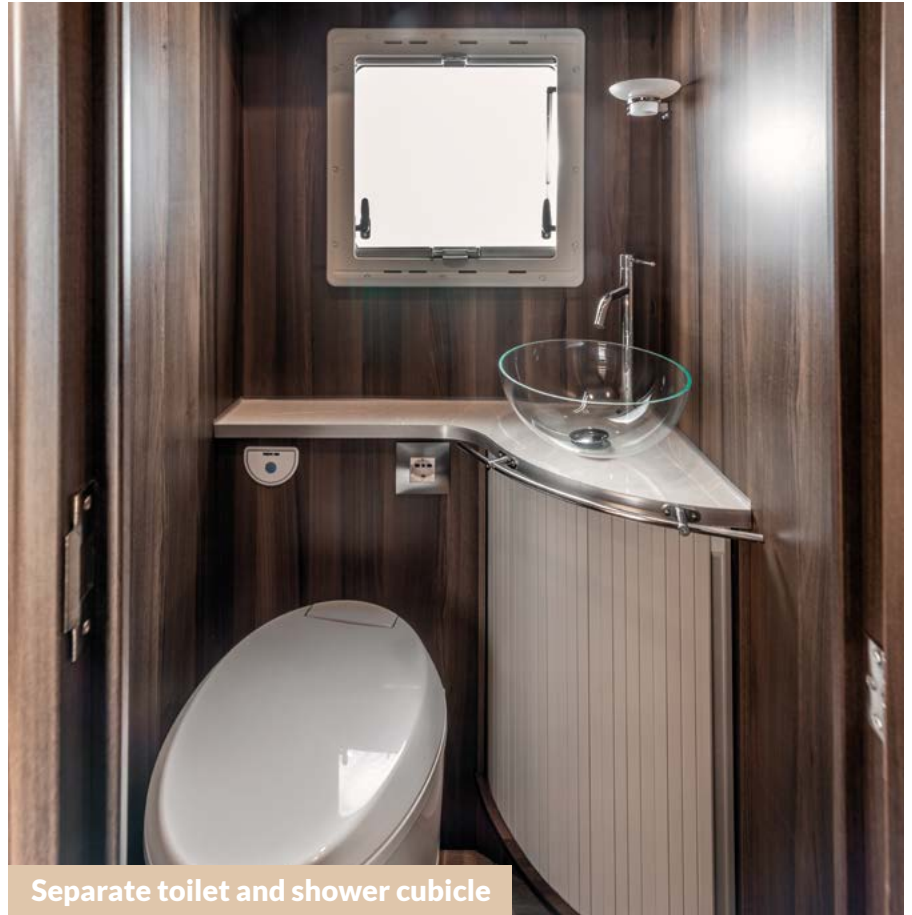

Separate toilet and shower cubicle

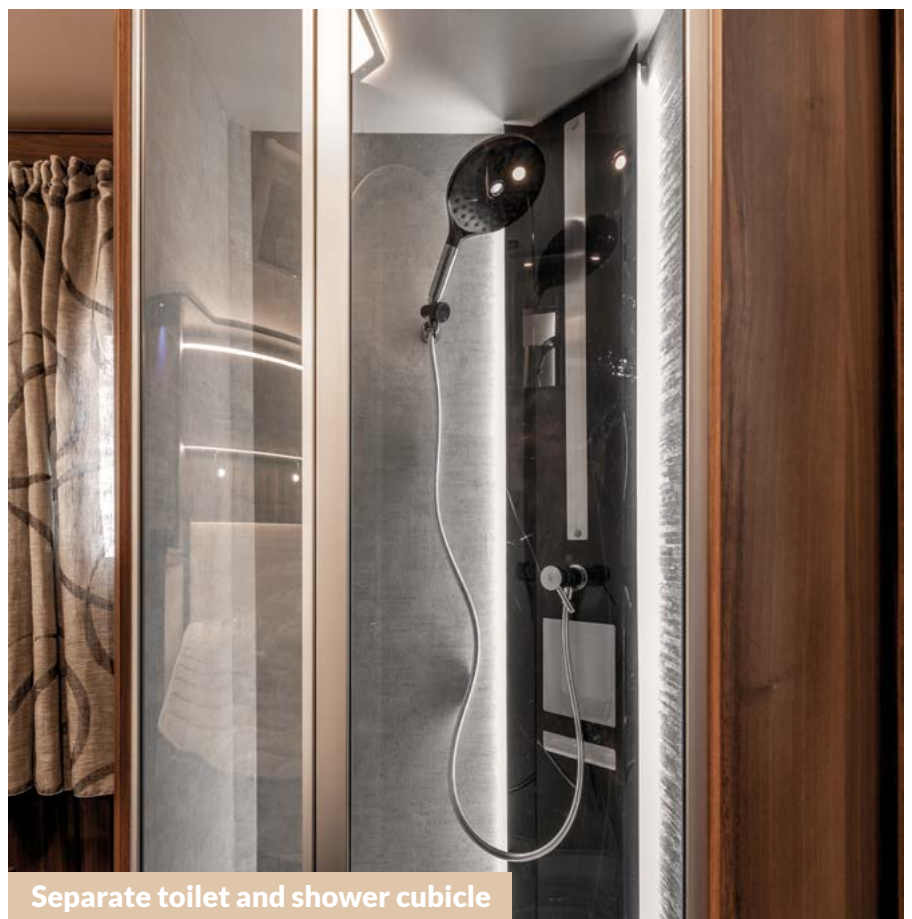

Separate toilet and shower cubicle





Flush-mounted shower tray and separate toilet with modular doors



Single unit with shower alongside toilet

## Models and layouts



SUPER BRIG 687 TC	
↔ Outside length x width (mm)	6838x2340
👤 Certified seats	4
🛏 Berths	4
🚪 Garage (access door dimensions) H (mm) x W (mm)	1280x850 (1080x850 opt)

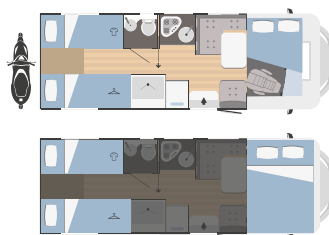

SUPER BRIG 695 TC	
↔ Outside length x width (mm)	7293x2340
👤 Certified seats	4
🛏 Berths	4
🚪 Garage (access door dimensions) H (mm) x W (mm)	1050x750

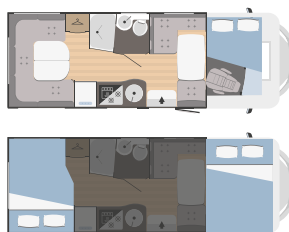

SUPER BRIG SUITE	
↔ Outside length x width (mm)	7093x2340
👤 Certified seats	4
🛏 Berths	4
🚪 Garage (access door dimensions) H (mm) x W (mm)	470x700

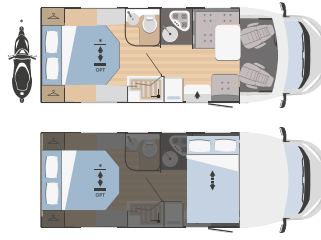

SUPER BRIG 69 PLUS	
↔ Outside length x width (mm)	7158x2340
👤 Certified seats	4
🛏 Berths	4
🚪 Garage (access door dimensions) H (mm) x W (mm)	750x750 (1200x750 opt)



SUPER BRIG 87 PLUS	
↔ Outside length x width (mm)	6838x2340
👤 Certified seats	4
🛏 Berths	4
🚪 Garage (access door dimensions) H (mm) x W (mm)	1280x850 (1080x850 opt)

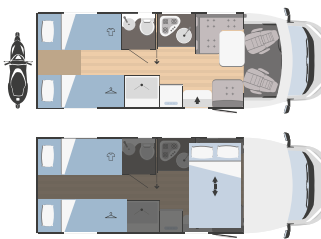

SUPER BRIG 95 PLUS	
↔ Outside length x width (mm)	7293x2340
👤 Certified seats	4
🛏 Berths	4
🚪 Garage (access door dimensions) H (mm) x W (mm)	1050x750



 **SUPER BRIG**  
Technical data

# SUPER BRIG

## 687 TC

FIAT  
PROFESSIONAL



↔  
**6838x2340**

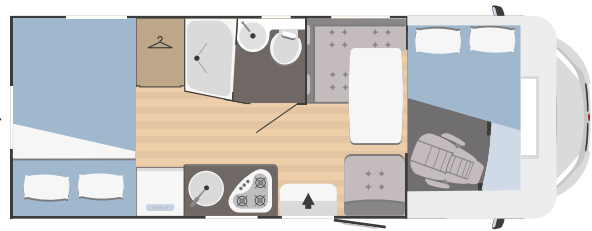

4



4



**1280x850**  
(1080x850 opt)

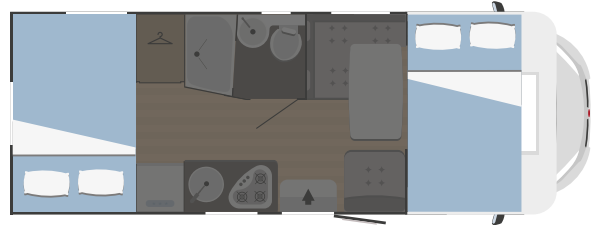

### MECHANICAL UNIT

Engine	Fiat Ducato
Wheelbase (mm)	3800
Displacement (L)	2,2
Maximum power (kW-HP)	103-140*
Radio	on request

### DIMENSIONS AND WEIGHTS

Outside length (mm)	6838
Outside width - inside width (mm)	2340 - 2200
Maximum outside height - inside height (mm)	3050 - 2075
Thickness of floor - walls - roof (mm)	56 - 30 - 30
Certified seats	4
Maximum overall weight (kg)***	3500

### BEDS

Berths	4
Assemblable berths	-
Overcab double bed	1400x2200
Assemblable single bed centre dinette	-
Assemblable double bed centre dinette	-
Assemblable double bed rear dinette	-
Rear single bed	-
Rear double bed	1356x2200
Bunk bed	-
Rear drop-down double bed	on request

### TANKS

Drinking water (inside)***	20 + 65 l.
Waste water tank	100 l.
Antifreeze tank	✓
Gas bottle locker	(1+1) x 11:13 kg

### EQUIPMENT

Gas heater	Combi C6
Water heater	Combi C6
Cabin swivel seats	✓
Panoramic porthole living area	✓
Openable panoramic porthole low-profile models front pod	-
Fridge	153 l.
Nr. burners hob	3
Extractor hood	✓
Oven	on request
Garage (access door dimensions) H (mm) x W (mm)	1280 x 850 (1080 x 850 on request)
Driver's cabin blackout blind	on request
Entrance door with fly screen	✓
TV-holder	✓
Roof rack with ladder	on request
Service battery	on request
Cabin seat covers	✓
Parking feet	✓
Bicycle rack	on request
Alarm system	on request
Outside entrance door lamp	✓

\*the Fiat Ducato 132 kW - 180 CV engine is available on request

\*\*\*for legal information about the weights see page 133

# SUPER BRIG

## 695 TC

FIAT  
PROFESSIONAL



7293x2340

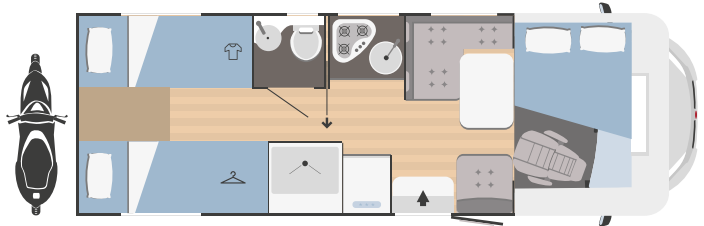

4



4



1050x750

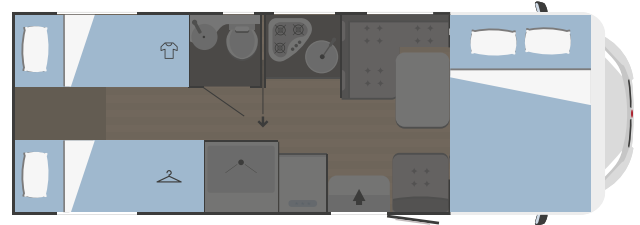

### MECHANICAL UNIT

Engine	Fiat Ducato
Wheelbase (mm)	4035
Displacement (L)	2,2
Maximum power (kW-HP)	103-140*
Radio	on request

### DIMENSIONS AND WEIGHTS

Outside length (mm)	7293
Outside width - inside width (mm)	2340 - 2200
Maximum outside height - inside height (mm)	3050 - 2075
Thickness of floor - walls - roof (mm)	56 - 30 - 30
Certified seats	4
Maximum overall weight (kg)***	3500

### BEDS

Berths	4
Assemblable berths	-
Overcab double bed	1400x2200
Assemblable single bed centre dinette	-
Assemblable double bed centre dinette	-
Assemblable double bed rear dinette	-
Rear single bed	n. 1 800x1975 n. 1 750x2040
Rear double bed	with extension: 1400x2200
Bunk bed	-
Rear drop-down double bed	-

### TANKS

Drinking water (inside)***	20 + 65 l.
Waste water tank	100 l.
Antifreeze tank	✓
Gas bottle locker	(1+1) x 11:13 kg

### EQUIPMENT

Gas heater	Combi C6
Water heater	Combi C6
Cabin swivel seats	✓
Panoramic porthole living area	✓
Openable panoramic porthole low-profile models front pod	-
Fridge	153 l.
Nr. burners hob	3
Extractor hood	✓
Oven	on request
Garage (access door dimensions) H (mm) x W (mm)	1050x750
Driver's cabin blackout blind	on request
Entrance door with fly screen	✓
TV-holder	✓
Roof rack with ladder	on request
Service battery	on request
Cabin seat covers	✓
Parking feet	✓
Bicycle rack	on request
Alarm system	on request
Outside entrance door lamp	✓

\*the Fiat Ducato 132 kW - 180 CV engine is available on request

\*\*\*for legal information about the weights see page 133

# SUPER BRIG SUITE

FIAT  
PROFESSIONAL



7093x2340



4



4



470x700

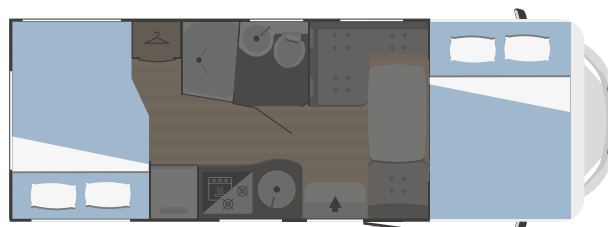
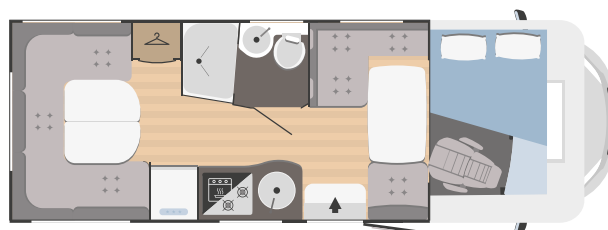

## MECHANICAL UNIT

Engine	Fiat Ducato
Wheelbase (mm)	3800
Displacement (L)	2,2
Maximum power (kW-HP)	103-140*
Radio	on request

## DIMENSIONS AND WEIGHTS

Outside length (mm)	7093
Outside width - inside width (mm)	2340 - 2200
Maximum outside height - inside height (mm)	3050 - 2075
Thickness of floor - walls - roof (mm)	56 - 30 - 30
Certified seats	4
Maximum overall weight (kg)***	3500

## BEDS

Berths	4
Assemblable berths	2
Overcab double bed	1400x2200
Assemblable single bed centre dinette	-
Assemblable double bed centre dinette	-
Assemblable double bed rear dinette	1475x2200
Rear single bed	-
Rear double bed	-
Bunk bed	-
Rear drop-down double bed	-

## TANKS

Drinking water (inside)***	20 + 65 l.
Waste water tank	100 l.
Antifreeze tank	✓
Gas bottle locker	(1+1) x 11:13 kg

## EQUIPMENT

Gas heater	Combi C6
Water heater	Combi C6
Cabin swivel seats	✓
Panoramic porthole living area	✓
Openable panoramic porthole low-profile models front pod	-
Fridge	153 l.
Nr. burners hob	3
Extractor hood	✓
Oven	✓
Garage (access door dimensions) H (mm) x W (mm)	470x700
Driver's cabin blackout blind	on request
Entrance door with fly screen	✓
TV-holder	✓
Roof rack with ladder	on request
Service battery	on request
Cabin seat covers	✓
Parking feet	✓
Bicycle rack	on request
Alarm system	on request
Outside entrance door lamp	✓

\*the Fiat Ducato 132 kW - 180 CV engine is available on request

\*\*\*for legal information about the weights see page 133

# SUPER BRIG

## 69 PLUS

FIAT  
PROFESSIONAL



↔  
**7158x2340**

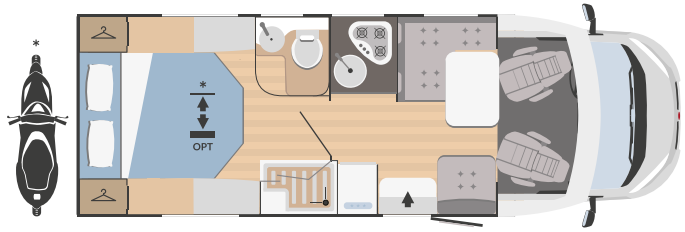

4



4



**750x750**  
(1200x750 opt)

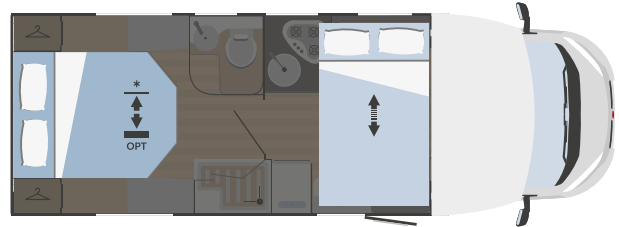

### MECHANICAL UNIT

Engine	Fiat Ducato
Wheelbase (mm)	4035
Displacement (L)	2,2
Maximum power (kW-HP)	103-140*
Radio	on request

### DIMENSIONS AND WEIGHTS

Outside length (mm)	7158
Outside width - inside width (mm)	2340 - 2200
Maximum outside height - inside height (mm)	3000 - 2075
Thickness of floor - walls - roof (mm)	56 - 30 - 30
Certified seats	4
Maximum overall weight (kg)***	3500

### BEDS

Berths	4
Assemblable berths	-
Assemblable single bed centre dinette	-
Assemblable double bed centre dinette	-
Assemblable double bed rear dinette	-
Front drop-down bed	1220x2200
Drop-down bed maximum static load capacity (kg)	250
Rear single bed	-
Rear double bed	1400x1900
Bunk bed	-
Rear drop-down double bed	on request

### TANKS

Drinking water (inside)***	20 + 65 l.
Waste water tank	100 l.
Antifreeze tank	✓
Gas bottle locker	(1+1) x 11:13 kg

### EQUIPMENT

Gas heater	Combi C6
Water heater	Combi C6
Cabin swivel seats	✓
Panoramic porthole living area	-
Openable panoramic porthole low-profile models front pod	✓
Fridge	141 l.
Nr. burners hob	3
Extractor hood	✓
Oven	on request
Garage (access door dimensions) H (mm) x W (mm)	750x750 (1200x750 on request)
Driver's cabin blackout blind	on request
Entrance door with fly screen	✓
TV-holder	✓
Roof rack with ladder	on request
Service battery	on request
Cabin seat covers	✓
Parking feet	✓
Bicycle rack	on request
Alarm system	on request
Outside entrance door lamp	✓

\*the Fiat Ducato 132 kW - 180 CV engine is available on request

\*\*\*for legal information about the weights see page 133



# SUPER BRIG

## 87 PLUS

FIAT  
PROFESSIONAL



↔  
**6838x2340**

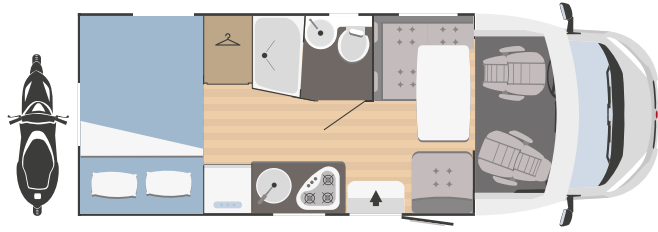

4



4



**1280x850**  
(1080x850 opt)

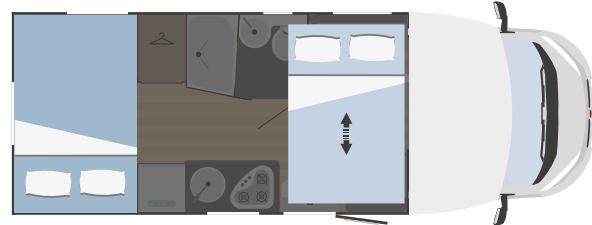

### MECHANICAL UNIT

Engine	Fiat Ducato
Wheelbase (mm)	3800
Displacement (L)	2,2
Maximum power (kW-HP)	103-140*
Radio	on request

### DIMENSIONS AND WEIGHTS

Outside length (mm)	6838
Outside width - inside width (mm)	2340 - 2200
Maximum outside height - inside height (mm)	3000 - 2075
Thickness of floor - walls - roof (mm)	56 - 30 - 30
Certified seats	4
Maximum overall weight (kg)***	3500

### BEDS

Berths	4
Assemblable berths	-
Assemblable single bed centre dinette	-
Assemblable double bed centre dinette	-
Assemblable double bed rear dinette	-
Front drop-down bed	1280x2200
Drop-down bed maximum static load capacity (kg)	250
Rear single bed	-
Rear double bed	1356x2200
Bunk bed	-
Rear drop-down double bed	on request

### TANKS

Drinking water (inside)***	20 + 65 l.
Waste water tank	100 l.
Antifreeze tank	✓
Gas bottle locker	(1+1) x 11:13 kg

### EQUIPMENT

Gas heater	Combi C6
Water heater	Combi C6
Cabin swivel seats	✓
Panoramic porthole living area	-
Openable panoramic porthole low-profile models front pod	✓
Fridge	153 l.
Nr. burners hob	3
Extractor hood	✓
Oven	on request
Garage (access door dimensions) H (mm) x W (mm)	1280x850 (1080x850 on request)
Driver's cabin blackout blind	on request
Entrance door with fly screen	✓
TV-holder	✓
Roof rack with ladder	on request
Service battery	on request
Cabin seat covers	✓
Parking feet	✓
Bicycle rack	on request
Alarm system	on request
Outside entrance door lamp	✓

\*the Fiat Ducato 132 kW - 180 CV engine is available on request

\*\*\*for legal information about the weights see page 133

# SUPER BRIG

## 95 PLUS



7293x2340



4



4



1050x750

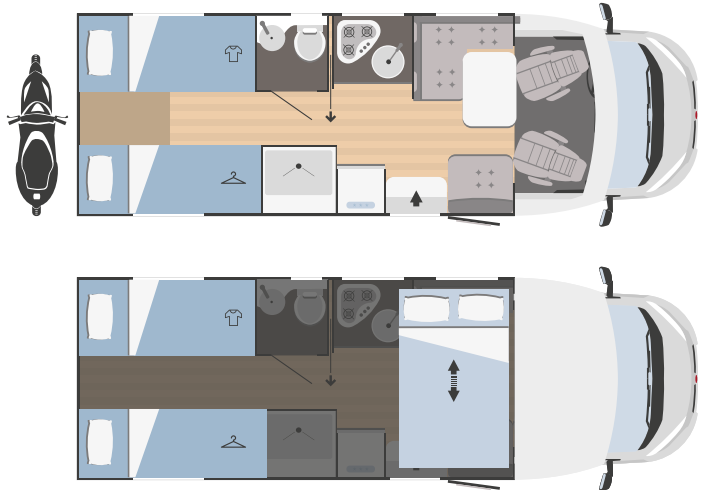

### MECHANICAL UNIT

Engine	Fiat Ducato
Wheelbase (mm)	4035
Displacement (L)	2,2
Maximum power (kW-HP)	103-140*
Radio	on request

### DIMENSIONS AND WEIGHTS

Outside length (mm)	7293
Outside width - inside width (mm)	2340 - 2200
Maximum outside height - inside height (mm)	3000 - 2075
Thickness of floor - walls - roof (mm)	56 - 30 - 30
Certified seats	4
Maximum overall weight (kg)***	3500

### BEDS

Berths	4
Assemblable berths	-
Assemblable single bed centre dinette	-
Assemblable double bed centre dinette	-
Assemblable double bed rear dinette	-
Front drop-down bed	1220x2000
Drop-down bed maximum static load capacity (kg)	250
Rear single bed	n. 1 800x1975
Rear double bed	n. 1 750x2040
Rear double bed with extension:	1400x2200
Bunk bed	-
Rear drop-down double bed	-

### TANKS

Drinking water (inside)***	20 + 65 l.
Waste water tank	100 l.
Antifreeze tank	✓
Gas bottle locker	(1+1) x 11:13 kg

### EQUIPMENT

Gas heater	Combi C6
Water heater	Combi C6
Cabin swivel seats	✓
Panoramic porthole living area	-
Openable panoramic porthole low-profile models front pod	✓
Fridge	153 l.
Nr. burners hob	3
Extractor hood	✓
Oven	on request
Garage (access door dimensions) H (mm) x W (mm)	1050x750
Driver's cabin blackout blind	on request
Entrance door with fly screen	✓
TV-holder	✓
Roof rack with ladder	on request
Service battery	on request
Cabin seat covers	✓
Parking feet	✓
Bicycle rack	on request
Alarm system	on request
Outside entrance door lamp	✓

\*the Fiat Ducato 132 kW - 180 CV engine is available on request

\*\*\*for legal information about the weights see page 133



MOR



# Designed to move at your pace

## The greatest adventure? The one built around your dreams

Whatever your idea of outdoor life is, there is a Horus that is perfect for you. Its agility and easy manoeuvrability means that there are no limits to imagination or age for a new adventure. Sleek and compact or large and spacious, it offers many details to make you fall in love: from the new, elegant and contemporary interior fittings in matt black, to the maximum practicality of the new kitchen tops and tables in high-strength laminate. Then there is the smart Elyplan fibreglass interior cladding, which is durable and easy to clean, for people whose top priority is outdoor life.

Discover the two new Horus 12 and 54 models. The first is agile and small, the second is extremely versatile, able to convert the sleeping area into a handy storage area. And again, with Horus you'll find all the comforts of home: double beds, twin beds, 3D touch storage compartments, a 90-litre fridge and durable upholstery. And a functional storage system for carefree travelling.



## Horus

Engine  
Fiat Ducato

Displacement  
2,2 L



from 5413  
to 6363 mm



4



from 3  
to 5



**Happiness is on  
the road, get  
comfy**

**NEW**



- 1 New interior fittings in matt black** (adjustable spotlights, switches and outlets)
- 2 New kitchen tops and tables in high-strength laminate**

- 3 Removable smart table with extension** which can be used as an outdoor table



- 4 **90-litre fridge** (141-litre on request) on models 38, 45 and 95 | **70-litre** on models 12 and 54
- 5 **Storage compartments with elastic bands**

- 6 **Sliding blinds with integrated fly-screen**
- 7 **Panoramic windows** with comfortable sliding opening handle





8 **Driver's cabin blackout blind** as standard

9 **Electric access step with safety system**  
connected to the dashboard

10 **External water supply with shower** as standard

- Combi Gas heating system as standard
- Rear heating with dedicated vents
- USB outlets in both living and sleeping areas
- Interior wardrobe lighting and adjustable reading lights
- Large storage compartments above the driver's cabin
- Cabinets with push/pull opening and soft-close locking arms with built-in LED lights
- Dinette which transforms into an extra bed

## Sleeping area



French bed  
HORUS 12

Double bed  
HORUS 38  
HORUS 54

Double  
superimposed  
bunk beds  
HORUS 45

Twin beds  
HORUS 95

NEW



French bed



Twin beds





**Double bed**



**Double superimposed bunk beds**



## Living area and kitchen



HORUS 38, 45 and 95

**NEW**



**HORUS 54**





**NEW**



**HORUS 12**

**NEW**

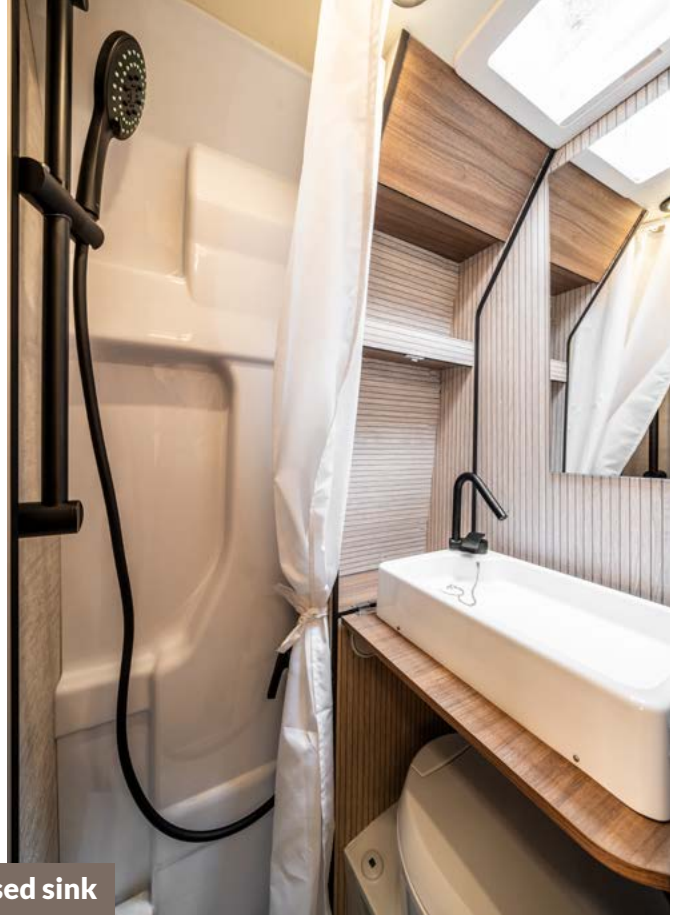

**Incorporated toilet and shower cubicle with recessed sink**

## Bathroom



**XL Toilet and shower  
cubicle integrated**  
HORUS 12

**Toilet and shower  
cubicle integrated**  
HORUS 38  
HORUS 45  
HORUS 95

**Incorporated toilet  
and shower cubicle  
with recessed sink**  
HORUS 54





**NEW**



**XL toilet and shower cubicle integrated**



**Toilet and shower cubicle integrated  
HORUS 38 and 45**



**Toilet and shower cubicle integrated  
HORUS 95**

## Models and layouts

NEW

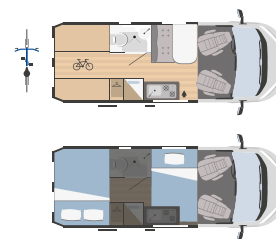
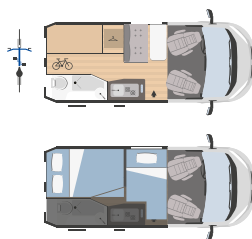

	HORUS 12	HORUS 38
↔ Outside length x width (mm)	5413x2050	5998x2050
👤 Certified seats	4	4
🛏 Berths	3	3

NEW

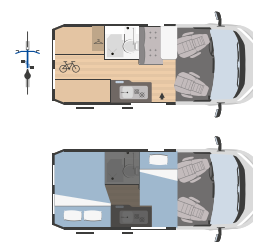
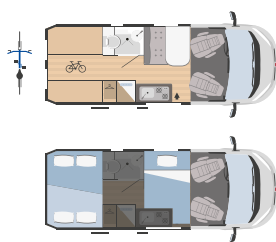

	HORUS 45	HORUS 54
↔ Outside length x width (mm)	5998x2050	5413x2050
👤 Certified seats	4	4
🛏 Berths	5	3

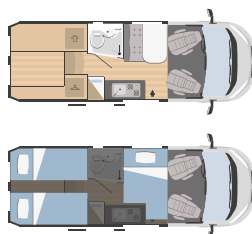

	HORUS 95
↔ Outside length x width (mm)	6363x2050
👤 Certified seats	4
🛏 Berths	3



 **HORUS**  
Technical data

**NEW**

# HORUS 12

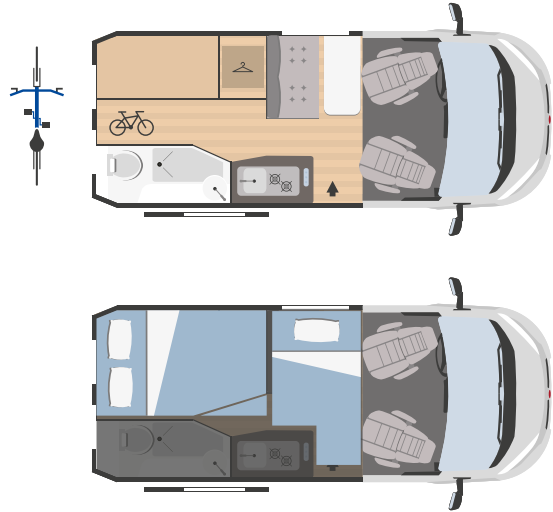
**FIAT**  
PROFESSIONAL↔  
**5143x2050****4****3**

## MECHANICAL UNIT

Engine	Fiat Ducato
Wheelbase (mm)	3450
Displacement (L)	2,2
Maximum power (kW-HP)	103-140
Radio	on request

## DIMENSIONS AND WEIGHTS

Outside length (mm)	5413
Outside width - inside width (mm)	2050 - 1850
Maximum outside height - inside height (mm)	2659 - 1875
Certified seats	4
Maximum overall weight (kg)***	3500

## BETTEN

Berths	2
Assemblable Berths	1
Assemblable single bed centre dinette	1100x1820 (1320)
Assemblable double bed centre dinette	-
Assemblable double bed rear dinette	-
Rear single bed	-
Rear double bed	1200x1900

## TANKS

Drinking water (inside)***	20 + 65 l.
Waste water tank	90 l.
Antifreeze tank	on request
Gas bottle locker	(1+1) x 11:13 kg

## EQUIPMENT

Gas heater	Combi C4
Water heater	Combi C4
Cabin swivel seats	✓
Panoramic porthole living area	✓
Driver's cabin blackout blind	✓
Fridge	70 l.
Nr. burners hob	2
Extractor hood	-
Oven	-
Entrance door with fly screen	on request
TV-holder	on request
Roof rack with ladder	on request
Service battery	on request
Cabin seat covers	on request
Bicycle rack	on request
Alarm system	on request
Outside entrance door lamp	on request
Electrical tow hook preparation	on request

\*\*\*for legal information about the weights see page 133

# HORUS 38

**FIAT**  
PROFESSIONAL



5998x2050



4



3

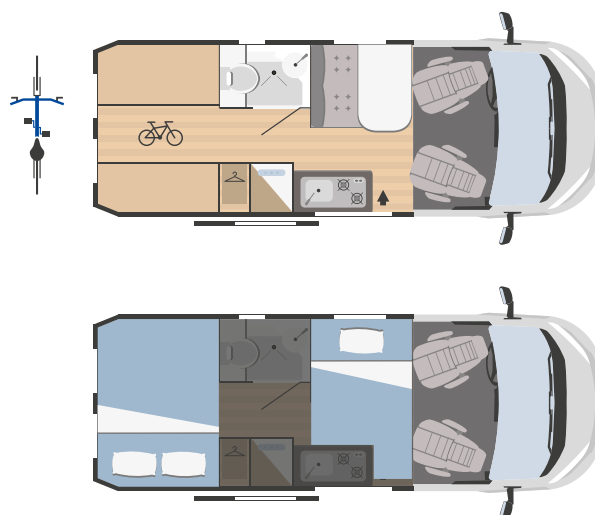

## MECHANICAL UNIT

Engine	Fiat Ducato
Wheelbase (mm)	4035
Displacement (L)	2,2
Maximum power (kW-HP)	103-140*
Radio	on request

## DIMENSIONS AND WEIGHTS

Outside length (mm)	5998
Outside width - inside width (mm)	2050 - 1850
Maximum outside height - inside height (mm)	2659 - 1875
Certified seats	4
Maximum overall weight (kg)***	3500

## BETTEN

Berths	2
Assemblable Berths	1
Assemblable single bed centre dinette	1150x1820 (1400)
Assemblable double bed centre dinette	-
Assemblable double bed rear dinette	-
Rear single bed	-
Rear double bed	1350x1920

## TANKS

Drinking water (inside)***	20 + 65 l.
Waste water tank	90 l.
Antifreeze tank	on request
Gas bottle locker	(1+1) x 11:13 kg

## EQUIPMENT

Gas heater	Combi C4
Water heater	Combi C4
Cabin swivel seats	✓
Panoramic porthole living area	✓
Driver's cabin blackout blind	✓
Fridge	90 l. (141 l. on request)
Nr. burners hob	2
Extractor hood	-
Oven	on request (NO fridge 141 l.)
Entrance door with fly screen	on request
TV-holder	on request
Roof rack with ladder	on request
Service battery	on request
Cabin seat covers	on request
Bicycle rack	on request
Alarm system	on request
Outside entrance door lamp	on request
Electrical tow hook preparation	on request

\*the Fiat Ducato 88 kW - 120 CV engine is available on request

\*\*\*for legal information about the weights see page 133

# HORUS 45



↔  
5998x2050

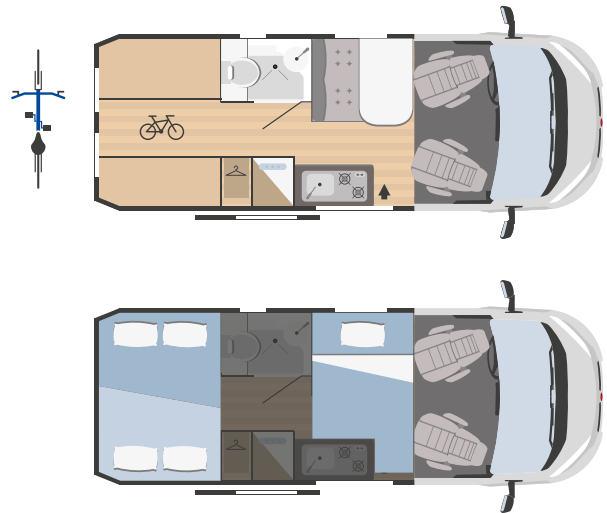

## MECHANICAL UNIT

Engine	Fiat Ducato
Wheelbase (mm)	4035
Displacement (L)	2,2
Maximum power (kW-HP)	103-140*
Radio	on request

## DIMENSIONS AND WEIGHTS

Outside length (mm)	5998
Outside width - inside width (mm)	2050 - 1850
Maximum outside height - inside height (mm)	2659 - 1875
Certified seats	4
Maximum overall weight (kg)***	3500

## BETTEN

Berths	4
Assemblable Berths	1
Assemblable single bed centre dinette	1150x1820 (1400)
Assemblable double bed centre dinette	-
Assemblable double bed rear dinette	-
Rear single bed	-
Rear double bed	n.2 1350x1850

## TANKS

Drinking water (inside)***	20 + 65 l.
Waste water tank	90 l.
Antifreeze tank	on request
Gas bottle locker	(1+1) x 5:6 kg

## EQUIPMENT

Gas heater	Combi C4
Water heater	Combi C4
Cabin swivel seats	✓
Panoramic porthole living area	✓
Driver's cabin blackout blind	✓
Fridge	90 l. (141 l. on request)
Nr. burners hob	2
Extractor hood	-
Oven	on request (NO fridge 141 l.)
Entrance door with fly screen	on request
TV-holder	on request
Roof rack with ladder	on request
Service battery	on request
Cabin seat covers	on request
Bicycle rack	on request
Alarm system	on request
Outside entrance door lamp	on request
Electrical tow hook preparation	on request

\*the Fiat Ducato 88 kW - 120 CV engine is available on request

\*\*\*for legal information about the weights see page 133

**NEW**

# HORUS

## 54

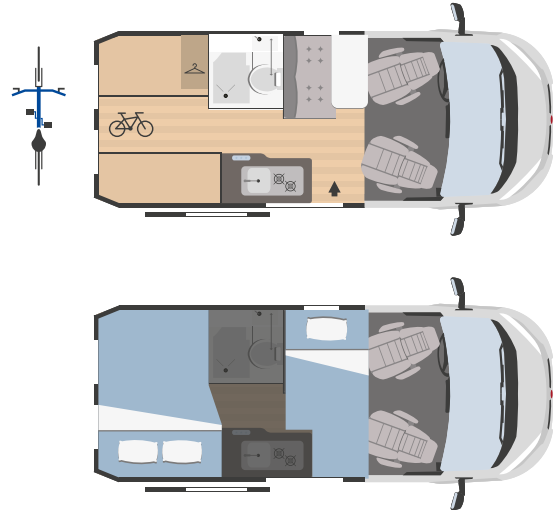
↔  
**5413x2050****4****3**

### MECHANICAL UNIT

Engine	Fiat Ducato
Wheelbase (mm)	3450
Displacement (L)	2,2
Maximum power (kW-HP)	103-140
Radio	on request

### DIMENSIONS AND WEIGHTS

Outside length (mm)	5413
Outside width - inside width (mm)	2050 - 1850
Maximum outside height - inside height (mm)	2659 - 1875
Certified seats	4
Maximum overall weight (kg)***	3500

### BETTEN

Berths	2
Assemblable Berths	1
Assemblable single bed centre dinette	900x1820
Assemblable double bed centre dinette	-
Assemblable double bed rear dinette	-
Rear single bed	-
Rear double bed	1320x1920

### TANKS

Drinking water (inside)***	20 + 59 l.
Waste water tank	90 l.
Antifreeze tank	on request
Gas bottle locker	(1+1) x 11:13 kg

### EQUIPMENT

Gas heater	Combi C4
Water heater	Combi C4
Cabin swivel seats	✓
Panoramic porthole living area	✓
Driver's cabin blackout blind	✓
Fridge	70 l.
Nr. burners hob	2
Extractor hood	-
Oven	-
Entrance door with fly screen	on request
TV-holder	on request
Roof rack with ladder	on request
Service battery	on request
Cabin seat covers	on request
Bicycle rack	on request
Alarm system	on request
Outside entrance door lamp	on request
Electrical tow hook preparation	on request

\*\*\*for legal information about the weights see page 133

# HORUS

## 95



↔  
6363x2050



4



3

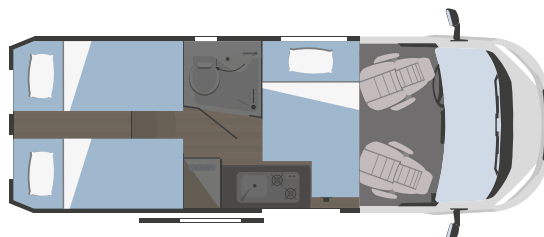
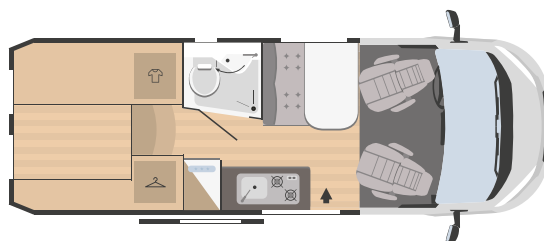

### MECHANICAL UNIT

Engine	Fiat Ducato
Wheelbase (mm)	4035XL
Displacement (L)	2,2
Maximum power (kW-HP)	103-140
Radio	on request

### DIMENSIONS AND WEIGHTS

Outside length (mm)	6363
Outside width - inside width (mm)	2050 - 1850
Maximum outside height - inside height (mm)	2659 - 1875
Certified seats	4
Maximum overall weight (kg)***	3500

### BETTEN

Berths	2
Assemblable Berths	1
Assemblable single bed centre dinette	1100x1820 (1400)
Assemblable double bed centre dinette	-
Assemblable double bed rear dinette	-
Rear single bed	800x1900 - 800x1900
Rear double bed	with extension: 1300x1920

### TANKS

Drinking water (inside)***	20 + 65 l.
Waste water tank	90 l.
Antifreeze tank	on request
Gas bottle locker	(1+1) x 11:13 kg

### EQUIPMENT

Gas heater	Combi C4
Water heater	Combi C4
Cabin swivel seats	✓
Panoramic porthole living area	✓
Driver's cabin blackout blind	✓
Fridge	90 l. (141 l. on request)
Nr. burners hob	2
Extractor hood	-
Oven	on request (NO fridge 141 l.)
Entrance door with fly screen	on request
TV-holder	on request
Roof rack with ladder	on request
Service battery	on request
Cabin seat covers	on request
Bicycle rack	on request
Alarm system	on request
Outside entrance door lamp	on request
Electrical tow hook preparation	on request

\*\*\*for legal information about the weights see page 133





RIMOR

RIMOR

HORUS  
45

# Mechanical units

## Safety and reliability in the driving seat

### Ford Transit



As standard:

- Driving seat armrests
- Cruise control
- Double airbag
- Central locking
- Electric windows
- Electric rear-view mirrors
- ABS (anti-lock braking system)
- Hill-start assist
- USB/MP3/BLUETOOTH radio with steering wheel mounted controls
- Start & Stop
- Sync 4 infotainment system with 12" screen
- 8" 'trend' digital dashboard + storage drawer with lock
- Trend' interior cladding
- Rapid windscreen defrosting system
- Automatic rain-sensing windscreen wipers
- Electric rear-view mirrors with defrosting
- Cruise control
- Electric handbrake
- Lane Keeping Assist + Lane departure detection
- Speed limit traffic sign recognition
- Front parking sensors
- Rear-view camera
- Fog lights
- Automatic lights
- Blindspot and brake assist for pedestrian and cyclist detection

### Fiat Ducato X250



As standard:

- Comfort Plus "Captain Chair" seats: built-in headrests, an even broader back and two armrests with height and incline adjustment
- Cruise control
- Double Airbag
- Central locking
- Radio predisposition and speakers
- Electric windows
- Electric rear-view mirrors
- ABS (anti-block braking system)
- Side mirror-integrated DAB antenna, standard
- Fog lights
- Traction plus + Hill-start assist
- Steering wheel controls (without radio)
- Back suspensions in composite material
- All-season tyres

# Fabrics

Colours and textures to personalise your travel experience

## Sarus

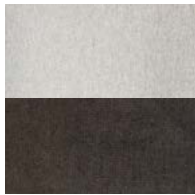

**Meringue**  
(standard)

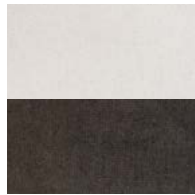

**Noisette**  
(optional)

## Kilig

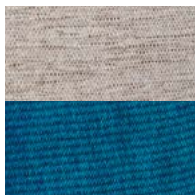

**Glace**  
(standard)

## Super Brig

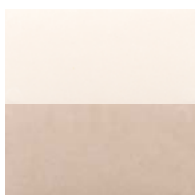

**Vanille**  
(standard)

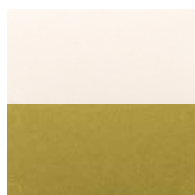

**Pistache**  
(optional)

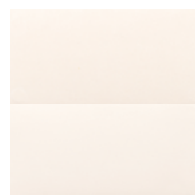

**Champagne**  
(eco-leather optional)

## Horus

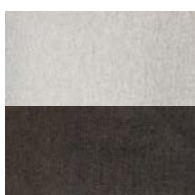

**Meringue**  
(standard)

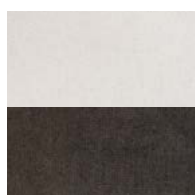

**Noisette**  
(optional)



RIMOR

RIMOR

## Legal information about the weights

### Mass in running order

The mass in running order of the type-approved vehicle includes: driver, fuel tank filled to 90% of its capacity, clean water tank filled to 20 l (using the special discharge valve) and gas cylinders (max. 15 kg) filled to 90% of their capacity.

The calculated mass in running order has a tolerance of +/- 5% compared to that of point (b) defined at the time of type-approval. Everything not included in the vehicle's standard version, both living pod and chassis, increases the weight in running order with the consequent reduction in the useful load up to the possible reduction of the total number of belted seats compared the type-approved ones.

The available useful load is the difference between the maximum mass permitted with full load and the mass in running order plus the weight of the passengers. It is therefore advisable at the time of purchase to pay special attention to the weight of the optionals you intend to install on the vehicle.

### Overall mass

The overall mass is the total mass of the vehicle that must not be exceeded.

### Potable water tank while driving

The clean water tank must contain 20 litres of water, using the supplied discharge taps, when the vehicle is in running order.

The technical data and vehicle characteristics, as set forth in this catalogue, are purely indicative in nature. The manufacturer and distributor cannot be held liable in the event of changes made for any reason during the season.

# World sweet home



Continue your trip with Rimor online. Follow all our activities on our blog, Facebook and Instagram. Share all your adventures with us on social media with #Rimor



[www.rimor.it](http://www.rimor.it)



